

**NOTICE!!**

**These documents have been scanned!**

**Do not place un-scanned documents beneath this notice!**

**Do not remove this notice from this file!**

GPO Jacket No. 560-102  
Print Order 61540  
Rise Business Services, LLC  
Job=AZ15 5/23/2019



Box Number= AZ15081



Claim Begin-End: AMC393518-AMC393518

**1 Initial Receipt**



AZ15081-10

AMC392436-AMC393518

United States Department of the Interior  
 Bureau of Land Management  
 BUSINESS & SUPPORT SVCS DIV  
 ONE N CENTRAL AVE SUITE 800  
 PHOENIX, AZ 85004 -4427  
 Phone: (602) 417-9200

Receipt

No: 1735210

Transaction #: 1792143		<b>ENTERED INTO COMPUTER</b>
Date of Transaction: 07/02/2008		
CUSTOMER:	MICAH SCHISEL 575 DUCK CT PRESCOTT, AZ 86301	JUL 15 2008 <i>B</i>

LINE #	QTY	DESCRIPTION	REMARKS	UNIT PRICE	TOTAL
1	1.00	LOCATABLE MINERALS / MINING CLAIMS- NEW, UNADJUD, ONE OR MORE AUTH NOS / NEW MINING CLAIM PROCESSING FEE \$15 (1930) CASES: AMC393518/\$15.00		- n/a -	15.00
2	1.00	LOCATABLE MINERALS / MINING CLAIMS- NEW, UNADJUD, ONE OR MORE AUTH NOS / NEW MINING CLAIM LOCATION FEE \$30 (1993) CASES: AMC393518/\$30.00		- n/a -	30.00
3	1.00	LOCATABLE MINERALS / MINING CLAIMS- NEW, UNADJUD, ONE OR MORE AUTH NOS / NEW MINING CLM MAINT FEE \$125 (1993) CASES: AMC393518/\$125.00		- n/a -	125.00
<b>TOTAL:</b>					<b>\$170.00</b>

PAYMENT INFORMATION			
1	AMOUNT:	\$170.00	POSTMARKED: 6/25/08 0:00
	TYPE:	CHECK	RECEIVED: 06/27/2008
	CHECK NO:	204	
	NAME:	SCHISEL, MICAH J 575 DUCK CT PRESCOTT AZ 86301	

REMARKS

This receipt was generated by the automated BLM Collections and Billing System and is a paper representation of a portion of the official electronic record contained therein.



**NOTICE!!**

**These documents have been scanned!**

**Do not place un-scanned documents beneath this notice!**

**Do not remove this notice from this file!**

GPO Jacket No. 560-102  
Print Order 61540  
Rise Business Services, LLC  
Job=AZ15 5/23/2019



Box Number= AZ15081



Claim Begin-End: AMC393518-AMC393518

**2 Correspondence**



AZ15081-10

AMC392436-AMC393518



# United States Department of the Interior



BUREAU OF LAND MANAGEMENT  
Arizona State Office  
One North Central Avenue, Suite 800  
Phoenix, Arizona 85004-4427  
www.blm.gov/az

**AUG 13 2014**

In Reply Refer To:  
3800 (9310) PB  
AMC389919, AMC393518, AMC395865

CERTIFIED MAIL – RETURN RECEIPT REQUESTED NO. 7014 1200 0000 8265 1586

## NOTICE

DON and SHIRLEY ANN WILDES : This Notice Affects Those Claims  
PO BOX 1146 : Shown in the Block Below.  
OKEECHOBEE, FL 34973-1146 :

---

AMC389922, AMC393518, AMC395865  
MAGIC GOLD, BANNIE GULCH GOLD, NEW ENGLAND GOLD

---

### Association Placer Mining Claims Documentation or Amendments Required

The mining claims listed above are association placer mining claims that are over 20 acres in size. The claims were originally located with the required number of locators to meet the 20-acre per locator requirement. However, the claims are now held by a smaller group of claimants than originally located them and are therefore not in compliance with the legal requirements.

By law, each individual claimant is allowed to hold a maximum of 20 acres per claim. A corporation is considered to be a single entity that is allowed to hold a maximum of 20 acres per claim. In accordance with 43 CFR 3833.33 you may transfer, sell, or otherwise convey an association placer mining claim at any time to an equal or greater number of mining claimants. If you want to transfer an association placer claim to an individual or an association that is smaller in number than the association that located the claim you (a) must have discovered a valuable mineral deposit before the transfer; or (b) upon notice from the Bureau of Land Management (BLM), you must reduce the acreage of the claim, if necessary, so that you meet the 20-acre per locator limit.

In reviewing the case file for these claims it was noted that at the time of transfer to an individual or smaller number of locators than originally located the claims, BLM did not receive documentation supporting that a discovery of a valuable mineral deposit was made. Without this

*Amended on 9/2/14 - Reduced Acreage to 40 acres.  
RH3121775*

documentation we cannot determine if the claims are being properly held by the correct number of claimants. Therefore, we are requiring that the appropriate documentation be submitted to BLM. We are enclosing a list to clarify what documentation must be provided to BLM to support the discovery of a valuable mineral deposit.

If you have the required documentation, dated **prior** to the date of transfer, you may file it with this office for review by a mineral examiner. If you do not have the proper documentation, you must amend the claims listed above, reducing the acreage to 20 acres per claimant, as is allowed by law.

We must receive either documentation supporting a discovery of a valuable mineral deposit, or amendments within 30 days of your receipt of this notice. If the required documentation or the amendments are not received within the 30-day timeframe the mining claims will be declared forfeited and void. If amendments are filed, there is a \$10 BLM processing fee for each amendment. The amendments must also be filed with the county.

If additional information is required, please contact Pauline Brown at 602-417-9360. Please include your AMC serial number(s) on all correspondence.

Sincerely,



Rebecca Heick  
Group Administrator  
Lands and Minerals

Enclosure(s)



**SENDER: COMPLETE THIS SECTION**

- Complete items 1, 2, and 3. Also complete item 4 if Restricted Delivery is desired.
- Print your name and address on the reverse so that we can return the card to you.
- Attach this card to the back of the mailpiece or on the front if space permits.

1. Article Addressed to:

DON and SHIRLEY ANN WILDES  
PO BOX 1146  
OKEECHOBEE FL 34973-1146  
9310/PB/AMC389919, AMC393518,  
AMC395865

2. Article Number  
(Transfer from service label)

7014 1200 0000 8265 1586

PS Form 3811, July 2013

Domestic Return Receipt

**COMPLETE THIS SECTION ON DELIVERY**

A. Signature

*Shirley Ann Wildes*  Agent  
 Addressee

B. Received by (Printed Name)

SHIRLEY ANN WILDES 8/18/14

C. Date of Delivery

D. Is delivery address different from item 1?  Yes

No  
Enter delivery address below:

RECEIVED  
BLM AZ ST  
2014 AUG 21

PHOENIX, ARIZONA

3. Service Type

- Certified Mail®  Priority Mail Express™
- Registered  Return Receipt for Merchandise
- Insured Mail  Collect on Delivery

4. Restricted Delivery? (Extra Fee)  Yes

UNITED STATES POSTAL SERVICE

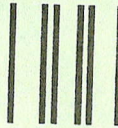

First-Class Mail  
Postage & Fees Paid  
USPS  
Permit No. G-10

• Sender: Please print your name, address, and ZIP+4® in this box•

U.S. DEPARTMENT OF THE INTERIOR  
BUREAU OF LAND MANAGEMENT  
ARIZONA STATE OFFICE  
ONE NORTH CENTRAL AVENUE, SUITE 800  
PHOENIX, AZ 85004-4427

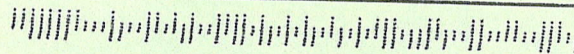



**NOTICE!!**

**These documents have been scanned!**

**Do not place un-scanned documents beneath this notice!**

**Do not remove this notice from this file!**

GPO Jacket No. 560-102  
Print Order 61540  
Rise Business Services, LLC  
Job=AZ15 5/23/2019



Box Number= AZ15081



Claim Begin-End: AMC393518-AMC393518

**3 Transfers**



AZ15081-10

AMC392436-AMC393518

RECORDING REQUESTED BY:

Micah Schisel

AMC 393518

AND WHEN RECORDED MAIL TO:

AMC 390947

Don and Shirley Wildes  
P.O. Box 1146 Okechohee

Exempt. A-1 FL 34973-1146

**QUITCLAIM DEED**

For the consideration of TEN AND NO/100 DOLLARS, and other valuable considerations, I or we,

Micah Schisel sole and separate property

hereby Quit-Claim to

Shirley and Don Wildes a married couple

all right, title, or interest in the following described real property situate in Yavapai County, AZ:

80 acre  
Placer Mining claim

Bonnie Gutch Gold

AMC # 393518

NW 1/4, SW 1/4 of Section  
2: SW Township 13N  
Range 1W

DATED: 7-22-08

*[Signature]*

STATE OF Arizona )  
County of Yavapai ) ss.

On July 22, 2008 before me, the undersigned Notary Public, personally appeared Micah Schisel, personally known to me (or proved to me on the basis of satisfactory evidence) to be the person(s) whose name(s) is/are subscribed to the within instrument and acknowledged to me that he/she/they executed the same in his/her/their authorized capacity(ies) and that his/her/their signature(s) on the instrument the person(s) or the entity upon behalf of which the person(s) acted, executed the instrument.

WITNESS my hand and official seal.

My Commission Expires: 8-25-2010

*[Signature: Penny Fincher]*  
Notary Public

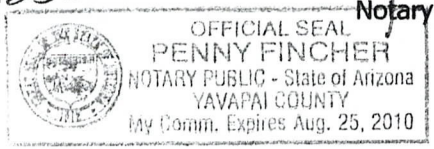

RECEIVED  
8 LIA. AZ STATE OFFICE  
2008 JUL 24 P 1:30  
PHOENIX, ARIZONA

RE 11/18/08  
ENTERED IN COMPUTER



7-21-2008

RELINQUISHMENT LETTER

To whom it may concern,

I Danell Schisel relinquish my interest in the 89 acres placer mining

Claim Bannie Gultch Gold AMC #393518.

Danell Schisel

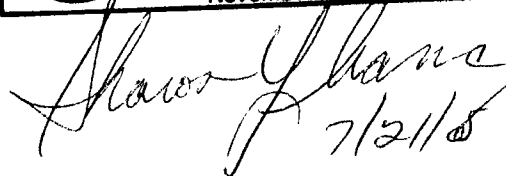
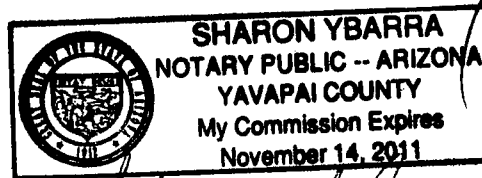

Sharon Ybarra  
7/21/08

RECEIVED  
S.L.M. AZ STATE OFFICE  
2008 JUL 24 P 3:30  
PHOENIX, ARIZONA

7-21-2008

RELINQUISHMENT LETTER

To whom it may concern,

We Daniel Schisel and Connie Schisel relinquish our interest in the 89 acres

Placer Mining claim Bannie Gultch Gold AMC #393518.

*Daniel Schisel*  
Daniel Schisel

Connie Schisel  
*Connie Schisel*

RECEIVED  
BUREAU OF LAND MANAGEMENT  
PHOENIX, ARIZONA  
2008 JUL 24 P 1:30

ACKNOWLEDGEMENT

STATE OF ARIZONA )  
 )ss  
COUNTY OF YAVAPAI)

On 7/21/2008, before me, then undersigned Notary Public, personally appeared Daniel Schisel and Connie Schisel, personally known to me (or proved to me on the basis of satisfactory evidence) to be the person(s) whose name(s) is/are subscribed to the within instrument and acknowledged to me that he/she/they executed the same in his/her/their authorized capacity(ies) and that his/her/their signature(s) on the instrument the person(s) acted, executed the instrument.

WITNESS my hand and official seal.

Penny Fincher  
Notary Public

My Commission Expires: ~~1-26-09~~  
8.25.2010

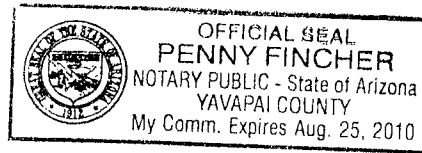

PHOENIX, ARIZONA  
2009 JUL 24 P 1:30  
S.M. [unclear]



7-21-2008

RELINQUISHMENT LETTER

To whom it may concern,

I Danell Schisel relinquish my interest in Mining Quartz Gold

Claim # 2 AMC # 390949.

Danell Schisel

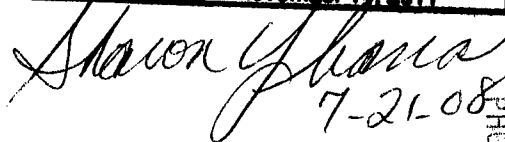
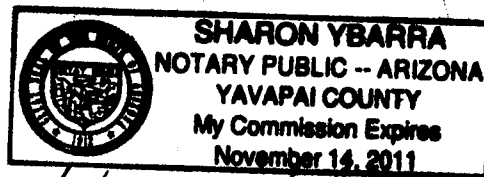
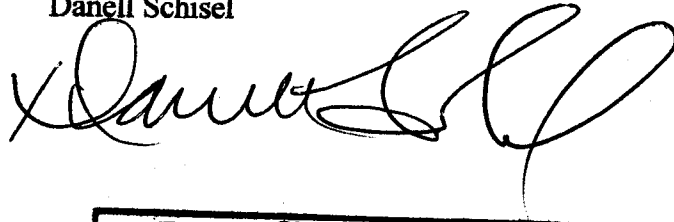

Sharon Ybarra  
7-21-08

RECEIVED  
ALM. AZ STATE OFFICE  
2008 JUL 24 P 1:30  
PHOENIX, ARIZONA

7-21-2008

RELINQUISHMENT LETTER

To whom it may concern,

We Daniel Schisel and Connie Schisel relinquish our interest in

Mining Quartz Gold Claim # 2 AMC # 390949.

*Daniel Schisel*

Daniel Schisel

Connie Schisel

*Connie Schisel*

PHOENIX, ARIZONA

2008 JUL 24 P 1:30

RECEIVED  
S.L.M. REGISTER OFFICE

ACKNOWLEDGEMENT

STATE OF ARIZONA )

)ss

COUNTY OF YAVAPAI)

On July 21, 2008, before me, then undersigned Notary Public, personally appeared Daniel Schisel and Connie Schisel personally known to me (or proved to me on the basis of satisfactory evidence) to be the person(s) whose name(s) is/are subscribed to the within instrument and acknowledged to me that he/she/they executed the same in his/her/their authorized capacity(ies) and that his/her/their signature(s) on the instrument the person(s) acted, executed the instrument.

WITNESS my hand and official seal.

*Penny Fincher*  
\_\_\_\_\_  
Notary Public

My Commission Expires: ~~1-26-09~~ 8-25-2010

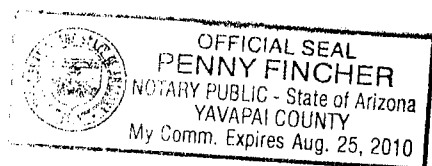

PHOENIX, ARIZONA

2009 JUL 24 P 1:30

RECEIVED  
CLERK, STATE OF ARIZONA



Micala Schisel  
575 Duck of  
Prescott AZ 86301

RECEIVED  
B.L.M. AZ STATE OFFICE

2008 JUL 24 P 1:30

PHOENIX, ARIZONA

PHOENIX AZ 850

22 JUL 08 PM 3 T



Bureau of Land management  
Arizona state Office  
One N. Central Ave.  
suite # 800

Phx AZ 85004-4427

85004+4427



**United States Department of the Interior**

**Bureau of Land Management**  
 BUSINESS & SUPPORT SVCS DIV  
 ONE N CENTRAL AVE SUITE 800  
 PHOENIX, AZ 85004 -4427  
 Phone: (602) 417-9200

Receipt

No: 1748376

<b>Transaction #:</b> 1805565	
<b>Date of Transaction:</b> 07/25/2008	
<b>CUSTOMER:</b>	DON WILDES P O BOX 1146 OKEECHOBEE,FL 34973

LINE #	QTY	DESCRIPTION	REMARKS	UNIT PRICE	TOTAL
1	1.00	LOCATABLE MINERALS / MINING CLAIMS-NOT NEW-UNADJUD,ONE AUTH NO. ONLY / MINING CLAIM MONEY RECEIVED (455) CASES: AMC393518/\$20.00	TRF (2)	- n/a -	20.00
<b>TOTAL:</b>					<b>\$20.00</b>

PAYMENT INFORMATION					
1	AMOUNT:	\$20.00	POSTMARKED:	7/22/08 0:00	
	TYPE:	CHECK	RECEIVED:	07/24/2008	
	CHECK NO:	209			
	NAME:	SCHISEL, MICAH J P O BOX 1146 OKEECHOBEE FL 34973			

REMARKS

This receipt was generated by the automated BLM Collections and Billing System and is a paper representation of a portion of the official electronic record contained therein.

Micah Schisel  
575 Duck ct  
Prescott AZ 86301

RECEIVED  
B.L.M. AZ STATE OFFICE

2000 JUL 24 P 1:30

PHOENIX, ARIZONA

PHOENIX AZ 850

22 JUL 08 PM 3 T



Bureau of Land management  
Arizona state Office  
One N. Central Ave.  
suite # 800

Phx AZ 85004-4427  
85004+4427



**NOTICE!!**

**These documents have been scanned!**

**Do not place un-scanned documents beneath this notice!**

**Do not remove this notice from this file!**

GPO Jacket No. 560-102  
Print Order 61540  
Rise Business Services, LLC  
Job=AZ15 5/23/2019



Box Number= AZ15081



Claim Begin-End: AMC393518-AMC393518

**4 Annual Filings**



AZ15081-10

AMC392436-AMC393518

UNITED STATES  
DEPARTMENT OF THE INTERIOR  
BUREAU OF LAND MANAGEMENT

482  
JML

393518

MAINTENANCE FEE WAIVER CERTIFICATION

FORM APPROVED  
OMB NO. 1004-0114  
Expires: January 31, 2020

SEE INSTRUCTIONS ON PAGE 2

- This small miner waiver is filed for the assessment year beginning on September 1, 2019 and ending on September 1, 2020
- The undersigned and all related parties owned ten or fewer mining claims, mill, or tunnel sites located and maintained on Federal lands in the United States of America on September 1, 2019.
- The undersigned have performed the assessment work required by law for each mining claim listed prior to filing this waiver and understand that by filing this form, the undersigned must file an affidavit of assessment work with the Bureau of Land Management (BLM) by the December 30th following the filing of this waiver.
- The undersigned understand that if the assessment work obligation has not yet come due under 30 U.S.C. 28 (for those claims in their first assessment year only), a notice of intent to hold reciting this condition must be recorded by the December 30th following the filing of this waiver.
- The undersigned understand that mill and tunnel sites may also be listed on this waiver and be waived from payment of the maintenance fee, and that a notice of intent to hold for these sites is required to be filed with the BLM by the December 30th following the filing of this waiver.
- The undersigned understand and acknowledge that pursuant to 43 U.S.C. 1212 and 18 U.S.C. 1001, the filing or recording of a false, fictitious, or fraudulent document with the BLM may result in a fine of up to \$250,000, a prison term not to exceed five years, or both.
- The mining claims, mill or tunnel sites for which this waiver from payment of the maintenance fees is requested are:

CLAIM OR SITE NAME	BLM RECORDATION SERIAL NUMBER
1. <u>Bannie Gulch Gold</u>	<u>Amc. # 393518</u>
2.	
3.	
4.	
5.	
6.	
7.	
8.	
9.	
10.	

RECEIVED  
BLM AZ STATE OFFICE  
2019 SEP - 4 P 1:50  
PHOENIX, ARIZONA

The owner(s) (claimants) of the above mining claims and sites are:

Shirley A. Wildes  
(Owner's Name - Please Print)  
P.O. Box 1146  
(Owner's Mailing Address)

Shirley A. Wildes  
(Owner's Signature)  
Okeechobee FL 34973  
(City) (State) (Zip Code)

Donald W. Wildes Jr  
(Owner's Name - Please Print)  
P.O. Box 1146  
(Owner's Mailing Address)

Donald W. Wildes Jr.  
(Owner's Signature)  
Okeechobee FL 34973  
(City) (State) (Zip Code)

\_\_\_\_\_  
(Owner's Name - Please Print)  
\_\_\_\_\_  
(Owner's Mailing Address)

\_\_\_\_\_  
(Owner's Signature)  
\_\_\_\_\_  
(City) (State) (Zip Code)

\_\_\_\_\_  
(Owner's Name - Please Print)  
\_\_\_\_\_  
(Owner's Mailing Address)

\_\_\_\_\_  
(Owner's Signature)  
\_\_\_\_\_  
(City) (State) (Zip Code)

(Continued on page 2)

RECEIVED  
SEP 18 2019  
BY: [Signature]

[Handwritten initials]



(Owner's Name - Please Print)	(Owner's Signature)		
(Owner's Mailing Address)	(City)	(State)	(Zip Code)
(Owner's Name - Please Print)	(Owner's Signature)		
(Owner's Mailing Address)	(City)	(State)	(Zip Code)
(Owner's Name - Please Print)	(Owner's Signature)		
(Owner's Mailing Address)	(City)	(State)	(Zip Code)
(Owner's Name - Please Print)	(Owner's Signature)		
(Owner's Mailing Address)	(City)	(State)	(Zip Code)

18 U.S.C. 1001 and 43 U.S.C. 1212 make it a crime for any person knowingly and willfully to make to any department or agency of the United States any false, fictitious or fraudulent statements or representations as to any matter within its jurisdiction.

**INSTRUCTIONS**

1. This certification is made under the provisions of 43 U.S.C. § 1744 and 30 U.S.C. §28-28k and the regulations thereunder (43 CFR Part 3830).
2. The claimant(s) must fill in the dates in paragraph 1 for the beginning and ending of the assessment year for which this waiver is sought.
3. The claimant(s) must fill in the date in paragraph 2 for the beginning of the assessment year for which this waiver is sought.
4. All claim and site names and BLM serial numbers must be listed for the mining claims, mill sites, and tunnel sites for which the waiver is sought.
5. All owners of the mining claims, mill sites, and tunnel sites and their addresses must be given.
6. This waiver form must be signed by all the claimants or their designated agent, in original form. If an agent is designated, a notarized designation of agent, signed by all of the claimants with proper address given, must be submitted with this waiver.
7. This form must be filed no later than September 1st for the upcoming assessment year in the BLM State Office where the mining claims or sites are recorded, or the waiver cannot be granted by the BLM. (Example: To obtain a waiver for the assessment year 2012, which begins on September 1, 2011, you must qualify for and file for a waiver no later than September 1, 2011, in the proper BLM State Office.)
8. For all mining claims which require assessment work, you must record an affidavit of labor on or before the December 30th immediately following the filing of this waiver. For all other mining claims or sites waived, you must record a notice of intent to hold on or before the December 30th immediately following the filing of this waiver.
9. Mill and tunnel sites may also be listed on this waiver and be waived from payment of the maintenance fee. A notice of intent to hold for these sites is required to be filed by the December 30th following the filing of this waiver.

**FOR OFFICIAL USE ONLY**

Donna M. Childers  
P.O. Box 1146  
Orlando, Florida  
32813

RECEIVED  
BLM STATE OFFICE  
2019 SEP -4 P 1:51  
PHOENIX, ARIZONA

Amc# 3438

WEST PALM BCH FL 334

29 AUG 2019 PM 3 L



B.L.M. of Arizona  
One ~~North~~ Central Ave.  
Suite 800 (8th floor)  
Phoenix, Arizona

85004-442700





1548

AMC 389919  
393518

FORM APPROVED  
OMB NO. 1004-0114  
Expires: January 31, 2020

**MAINTENANCE FEE WAIVER CERTIFICATION**

SEE INSTRUCTIONS ON PAGE 2

- This small miner waiver is filed for the assessment year beginning on September 1, 2018 and ending on September 12019.
- The undersigned and all related parties owned ten or fewer mining claims, mill, or tunnel sites located and maintained on Federal lands in the United States of America on September 1, 2018.
- The undersigned have performed the assessment work required by law for each mining claim listed prior to filing this waiver and understand that by filing this form, the undersigned must file an affidavit of assessment work with the Bureau of Land Management (BLM) by the December 30th following the filing of this waiver.
- The undersigned understand that if the assessment work obligation has not yet come due under 30 U.S.C. 28 (for those claims in their first assessment year only), a notice of intent to hold reciting this condition must be recorded by the December 30th following the filing of this waiver.
- The undersigned understand that mill and tunnel sites may also be listed on this waiver and be waived from payment of the maintenance fee, and that a notice of intent to hold for these sites is required to be filed with the BLM by the December 30th following the filing of this waiver.
- The undersigned understand and acknowledge that pursuant to 43 U.S.C. 1212 and 18 U.S.C. 1001, the filing or recording of a false, fictitious, or fraudulent document with the BLM may result in a fine of up to \$250,000, a prison term not to exceed five years, or both.
- The mining claims, mill or tunnel sites for which this waiver from payment of the maintenance fees is requested are:

CLAIM OR SITE NAME	BLM RECORDATION SERIAL NUMBER
1. <u>Bonnie Gulch Gold</u>	<u>AMC # 393518</u> ✓
2.	
3.	
4.	
5.	
6.	
7.	
8.	
9.	
10.	

RECEIVED  
BLM AZ STATE OFFICE  
2018 SEP - 5 P 2:00  
PHOENIX, ARIZONA

The owner(s) (claimants) of the above mining claims and sites are:

Shirley A. Wildes  
(Owner's Name - Please Print)

Shirley A. Wildes  
(Owner's Signature)

P.O. Box 1146  
(Owner's Mailing Address)

Okeechobee Fl. 34973  
(City) (State) (Zip Code)

Donald W. Wildes Sr.  
(Owner's Name - Please Print)

Donald W. Wildes Sr.  
(Owner's Signature)

P.O. Box 1146  
(Owner's Mailing Address)

Okeechobee Fl. 34973  
(City) (State) (Zip Code)

(Owner's Name - Please Print)

(Owner's Signature)

(Owner's Mailing Address)

(City)

(State)

(Zip Code)

(Owner's Name - Please Print)

(Owner's Signature)

(Owner's Mailing Address)

(City)

(State)

(Zip Code)

493  
INTEREST  
SEP 12 2018  
BY: [Signature]

NW  
2

(Owner's Name - Please Print)	(Owner's Signature)
(Owner's Mailing Address)	(City) (State) (Zip Code)
(Owner's Name - Please Print)	(Owner's Signature)
(Owner's Mailing Address)	(City) (State) (Zip Code)
(Owner's Name - Please Print)	(Owner's Signature)
(Owner's Mailing Address)	(City) (State) (Zip Code)
(Owner's Name - Please Print)	(Owner's Signature)
(Owner's Mailing Address)	(City) (State) (Zip Code)

18 U.S.C. 1001 and 43 U.S.C. 1212 make it a crime for any person knowingly and willfully to make to any department or agency of the United States any false, fictitious or fraudulent statements or representations as to any matter within its jurisdiction.

**INSTRUCTIONS**

1. This certification is made under the provisions of 43 U.S.C. § 1744 and 30 U.S.C. §28-28k and the regulations thereunder (43 CFR Part 3830).
2. The claimant(s) must fill in the dates in paragraph 1 for the beginning and ending of the assessment year for which this waiver is sought.
3. The claimant(s) must fill in the date in paragraph 2 for the beginning of the assessment year for which this waiver is sought.
4. All claim and site names and BLM serial numbers must be listed for the mining claims, mill sites, and tunnel sites for which the waiver is sought.
5. All owners of the mining claims, mill sites, and tunnel sites and their addresses must be given.
6. This waiver form must be signed by all the claimants or their designated agent, in original form. If an agent is designated, a notarized designation of agent, signed by all of the claimants with proper address given, must be submitted with this waiver.
7. This form must be filed no later than September 1st for the upcoming assessment year in the BLM State Office where the mining claims or sites are recorded, or the waiver cannot be granted by the BLM. (Example: To obtain a waiver for the assessment year 2012, which begins on September 1, 2011, you must qualify for and file for a waiver no later than September 1, 2011, in the proper BLM State Office.)
8. For all mining claims which require assessment work, you must record an affidavit of labor on or before the December 30th immediately following the filing of this waiver. For all other mining claims or sites waived, you must record a notice of intent to hold on or before the December 30th immediately following the filing of this waiver.
9. Mill and tunnel sites may also be listed on this waiver and be waived from payment of the maintenance fee. A notice of intent to hold for these sites is required to be filed by the December 30th following the filing of this waiver.

POSTMARKED  
TIMELY

FOR OFFICIAL USE ONLY



1547

MAINTENANCE FEE WAIVER CERTIFICATION

FORM APPROVED  
OMB NO. 1004-0114  
Expires: January 31, 2020

SEE INSTRUCTIONS ON PAGE 2

- This small miner waiver is filed for the assessment year beginning on September 1, 2018 and ending on September 1, 2019.
- The undersigned and all related parties owned ten or fewer mining claims, mill, or tunnel sites located and maintained on Federal lands in the United States of America on September 1, 2018.
- The undersigned have performed the assessment work required by law for each mining claim listed prior to filing this waiver and understand that by filing this form, the undersigned must file an affidavit of assessment work with the Bureau of Land Management (BLM) by the December 30th following the filing of this waiver.
- The undersigned understand that if the assessment work obligation has not yet come due under 30 U.S.C. 28 (for those claims in their first assessment year only), a notice of intent to hold reciting this condition must be recorded by the December 30th following the filing of this waiver.
- The undersigned understand that mill and tunnel sites may also be listed on this waiver and be waived from payment of the maintenance fee, and that a notice of intent to hold for these sites is required to be filed with the BLM by the December 30th following the filing of this waiver.
- The undersigned understand and acknowledge that pursuant to 43 U.S.C. 1212 and 18 U.S.C. 1001, the filing or recording of a false, fictitious, or fraudulent document with the BLM may result in a fine of up to \$250,000, a prison term not to exceed five years, or both.
- The mining claims, mill or tunnel sites for which this waiver from payment of the maintenance fees is requested are:

CLAIM OR SITE NAME	BLM RECORDATION SERIAL NUMBER
1. Magic Gold # 5	AMC# 389922 ✓
2.	
3.	
4.	
5.	
6.	
7.	
8.	
9.	
10.	

RECEIVED  
 BLM AZ STATE OFFICE  
 2018 SEP -5 P 1:59  
 PHOENIX, ARIZONA

The owner(s) (claimants) of the above mining claims and sites are:

Shirley A. Wildes  
 (Owner's Name - Please Print)  
 P.O. Box 1146  
 (Owner's Mailing Address)

Shirley A. Wildes  
 (Owner's Signature)  
 Okeechobee Fl. 34973  
 (City) (State) (Zip Code)

Donald W Wildes Sr  
 (Owner's Name - Please Print)  
 P.O. Box 1146  
 (Owner's Mailing Address)

Donald W Wildes Sr  
 (Owner's Signature)  
 Okeechobee Fl. 34973  
 (City) (State) (Zip Code)

(Owner's Name - Please Print)  
 (Owner's Mailing Address)

(Owner's Signature)  
 (City) (State) (Zip Code)

(Owner's Name - Please Print)  
 (Owner's Mailing Address)

(Owner's Signature)  
 (City) (State) (Zip Code)

(Continued on page 2)

USE DATE OF POSTMARK FOR ACTION DATE.

\_\_\_\_\_  
(Owner's Name - Please Print)

\_\_\_\_\_  
(Owner's Signature)

\_\_\_\_\_  
(Owner's Mailing Address)

\_\_\_\_\_  
(City) (State) (Zip Code)

\_\_\_\_\_  
(Owner's Name - Please Print)

\_\_\_\_\_  
(Owner's Signature)

\_\_\_\_\_  
(Owner's Mailing Address)

\_\_\_\_\_  
(City) (State) (Zip Code)

\_\_\_\_\_  
(Owner's Name - Please Print)

\_\_\_\_\_  
(Owner's Signature)

\_\_\_\_\_  
(Owner's Mailing Address)

\_\_\_\_\_  
(City) (State) (Zip Code)

\_\_\_\_\_  
(Owner's Name - Please Print)

\_\_\_\_\_  
(Owner's Signature)

\_\_\_\_\_  
(Owner's Mailing Address)

\_\_\_\_\_  
(City) (State) (Zip Code)

18 U.S.C. 1001 and 43 U.S.C. 1212 make it a crime for any person knowingly and willfully to make to any department or agency of the United States any false, fictitious or fraudulent statements or representations as to any matter within its jurisdiction.

**INSTRUCTIONS**

1. This certification is made under the provisions of 43 U.S.C. § 1744 and 30 U.S.C. §28-28k and the regulations thereunder (43 CFR Part 3830).
2. The claimant(s) must fill in the dates in paragraph 1 for the beginning and ending of the assessment year for which this waiver is sought.
3. The claimant(s) must fill in the date in paragraph 2 for the beginning of the assessment year for which this waiver is sought.
4. All claim and site names and BLM serial numbers must be listed for the mining claims, mill sites, and tunnel sites for which the waiver is sought.
5. All owners of the mining claims, mill sites, and tunnel sites and their addresses must be given.
6. This waiver form must be signed by all the claimants or their designated agent, in original form. If an agent is designated, a notarized designation of agent, signed by all of the claimants with proper address given, must be submitted with this waiver.
7. This form must be filed no later than September 1st for the upcoming assessment year in the BLM State Office where the mining claims or sites are recorded, or the waiver cannot be granted by the BLM. (Example: To obtain a waiver for the assessment year 2012, which begins on September 1, 2011, you must qualify for and file for a waiver no later than September 1, 2011, in the proper BLM State Office.)
8. For all mining claims which require assessment work, you must record an affidavit of labor on or before the December 30th immediately following the filing of this waiver. For all other mining claims or sites waived, you must record a notice of intent to hold on or before the December 30th immediately following the filing of this waiver.
9. Mill and tunnel sites may also be listed on this waiver and be waived from payment of the maintenance fee. A notice of intent to hold for these sites is required to be filed by the December 30th following the filing of this waiver.

**POSTMARKED  
TIMELY**

FOR OFFICIAL USE ONLY

When Recorded, Mail Document To:

Shirley A. Wildes  
P. O. Box 1146  
OKEECHOBEE, FLORIDA  
34973

(Recorder Office Space)

Affidavit of Annual Assessment Work-Proof of Labor  
Mining Claim

RECEIVED  
BLM AZ STATE OFFICE  
2018 SEP -5 P 2:00  
PHOENIX, ARIZONA

UNITED STATES  
DEPARTMENT OF THE INTERIOR  
BUREAU OF LAND MANAGEMENT

FORM APPROVED  
OMB NO.: 1004-0114  
Expires: January 31, 2020

**AFFIDAVIT OF ANNUAL ASSESSMENT WORK**

WHEN RECORDED, MAIL DOCUMENT TO:

NAME: Shirley A. Wildes

ADDRESS: P.O. Box 1146

CITY, STATE, ZIP: Okeechobee, FL 34973

FOR COUNTY RECORDER'S USE

No. of Claims 1

x \$10/claim

Total due BLM \$ 10.<sup>00</sup>

4260513

TO ALL WHOM IT MAY CONCERN:

1. The undersigned certifies that at least \$100 per claim was expended for development, labor and improvements, or equivalent value added, as the annual assessment work for the assessment year ending September 1, 2018 for the following contiguous unpatented mining claim(s), located in the County of YAVAPAI, in the State of Arizona.

BLM Serial No.	Name of Claim	Tp	Rg	Sec	Mer	County Recordation Book and Page No.	Co. Recording Date
AMC # 393518	Bannice Gulch Gold	13N	1W	22SW		2017-0065473	12-18-2017

2018 SEP - 5 P 2:00  
 PHOENIX, ARIZONA  
 RECEIVED  
 BLM AZ STATE OFFICE

ENTERED  
SEP 12 2018  
BY: [Signature]



2. Type of labor and improvements (specify what was done and give the total value for that labor and improvement to show at least \$100 for each claim). If a geological, geochemical, or geophysical survey was performed, as per 30 U.S.C. 28-1, reference the title of the report of survey, give cost and date of the survey and report, and indicate it was filed with the County Recorder:

Description of Work Performed	Value of Work Performed	Date Work Was Performed
Performed 1 full day work on claim.	\$100.00	7-12-2018
Worked Material, metal detected, picked up trash etc.		

3. Name and mailing address of each person who performed the labor and improvements:

**Name (please print)**  
 Shirley A. Wildes  
 Donald Wildes Sr.

**Current Mailing Address (please print)**  
 PO Box 1146 Okeechobee, FL 34973  
 PO Box 1146 Okeechobee, FL 34973

4. Name and mailing address of each person who holds and claims the subject mining claim(s) for the valuable minerals contained therein. Be sure to indicate if there is a change of address:

**Name (please print)**  
 Shirley A. Wildes  
 Donald W. Wildes (Sr.)

**Current Mailing Address (please print)**  
 P.O. Box 1146 Okeechobee, FL 34973  
 P.O. Box 1146 Okeechobee, FL 34973

5. The undersigned testifies that on the date of August 24, 2018, all monuments required by law were erected upon the subject claim(s), and all notices required by law were posted on the subject claim(s) or copies thereof were in place, and at said date, each corner monument bore or contained

markings sufficient to appropriately designate the corner of the claim to which it pertains and the name of the claim(s).

I hereby certify under penalty of perjury under the laws of the State of Florida that the foregoing statements are true and correct:

Shirley A. Wildes Date: 8-24-18  
(Signature of person responsible for above statement)

Title 18 U.S.C. 1001 and 43 U.S.C. 1212 make it a crime for any person knowingly and willfully to make to any department or agency of the United States any false, fictitious or fraudulent statements or representations as to any matter within its jurisdiction.

**Notary Block**

SUBSCRIBED AND SWORN TO before me, this 24 day of August 2018

By: Linda M Ballinger  
(Signature of Affiant)

Title: Notary

My Commission Expires: \_\_\_\_\_

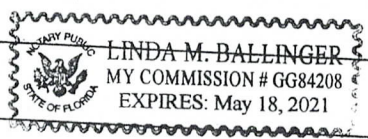

RECEIVED  
BLM AZ STATE OFFICE  
2018 SEP -5 P 2:00  
PHOENIX, ARIZONA

**INSTRUCTIONS**

1. This is an optional form that may be used to satisfy the requirements for the Bureau of Land Management (BLM) under the provisions of 43 U.S.C. §1744 and 30 U.S.C. §28-28d and the regulations thereunder (43 CFR part 3835). Since local and State laws may vary, you should contact your local and State agencies where the claims are located to ensure all applicable laws and requirements are satisfied.
2. The claimant(s) must fill in the date in paragraph 1 for the applicable assessment year and the county and state where the claims are located.
3. All claim names, BLM serial numbers, legal descriptions, and original county recording information must be listed for the claims pertaining to this assessment notice.
4. The claimant(s) must complete paragraph 2 listing all labor or improvements which was performed on or did benefit the subject mining claims. The value and date of the labor or improvements must also be listed. The total amount of labor or improvements can be listed, but the total expenditure must equal at least \$100 for each claim.
5. The names and current mailing addresses of the person(s) performing the labor shall be listed in paragraph 3.
6. The name and current mailing address of each owner (claimant) of the claims shall be listed in paragraph 4. The mailing address shall be the owner's address and not the address of an agent or anyone representing the claimant. Be sure to note if there has been a change of address.
7. Paragraph 5 shall be completed to show the date it was verified that all monuments required by law were properly erected, all notices were posted, and that corners were appropriately designated for all claims listed.
8. An exact legible reproduction or duplicate (other than microfilm or other electronic media) of this affidavit or another type of affidavit of assessment work that you file or will file in the county where each claim is located, must be filed with the BLM on or before December 30 of the calendar year in which the assessment year ends. For mill or tunnel sites, a separate notice of intent to hold must be filed with the BLM on or before December 30. Requirements for filing a notice of intent to hold can be found at 43 CFR 3835.33.
9. A processing fee of \$10 for each claim listed must be remitted to the BLM along with this or any other affidavit of assessment work.



## NOTICES

**THE PRIVACY ACT** and 43 CFR 2.223(d) require that you be furnished with the following information in connection with the information requested by this form.

**AUTHORITY:** 30 U.S.C. §28-28d and 43 CFR part 3835 permit collection of the information requested by this form.

**PRINCIPAL PURPOSE:** The BLM will use the information you provide to document compliance with 43 U.S.C. 1744 and that assessment work has been completed in accordance with 30 U.S.C. § 28-28d and 43 CFR part 3835 in lieu of paying the maintenance fee for the mining claims listed on this form.

**ROUTINE USES:** The BLM will only disclose this information in accordance with the provisions at 43 CFR 2.231(b) and (c).

**EFFECT OF NOT PROVIDING INFORMATION:** Disclosure of the requested information is required by 30 U.S.C. § 28-28d and 43 CFR part 3835 for claimants qualified to perform assessment work in lieu of paying the maintenance fee. Failure to submit all the requested information or to complete this form will delay the BLM's processing of the form and may preclude the BLM's acceptance of the assessment work information, which may result in forfeiture of the mining claim(s) by the claimant.

**THE PAPERWORK REDUCTION ACT** requires us to inform you that:

Use of this form is optional. You must perform assessment if a waiver to pay the maintenance fee has been requested. This form is provided to help you attest that annual assessment work has been completed in lieu of paying the maintenance fee for your claim(s). Submission of the requested information is necessary to obtain or retain a benefit.

You do not have to respond to this or any other Federal agency-sponsored information collection unless it displays a valid OMB control number.

**BURDEN HOURS STATEMENT:** The estimated public reporting burden for this form is 30 minutes per response, including the time for reviewing instructions, gathering and maintaining data, and completing and reviewing the form. You may submit comments regarding the burden estimate or any other aspect of this form to: U.S. Department of the Interior, Bureau of Land Management (1004-0114), Bureau Information Collection Clearance Officer (WO-630), 1849 C Street, N.W., Room 2134LM, Washington, D.C. 20240.

Shirley A. Seidels  
P.O. Box 1146  
Okechobee, Florida  
34973

RECEIVED  
BLM AZ STATE OFFICE

2018 SEP -5 P 2:00

PHOENIX, ARIZONA

WEST RLM RCH FI 374

31 AUG 2018 PM 2 L

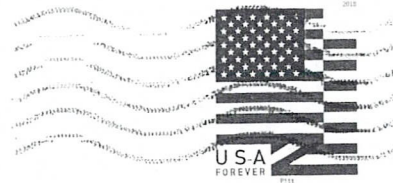

POSTMARKED  
TIMELY

Bureau of Land Management - Arizona  
1 North Central Ave. Suite 800  
Phoenix, Arizona  
85004-4427

85004-442700

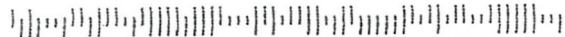

**United States Department of the Interior**  
**Bureau of Land Management**  
 DIV OF LANDS, MINRLS & ENERGY  
 ONE N CENTRAL AVE  
 PHOENIX, AZ 85004 -4427  
 Phone: 602-417-9200

Receipt

No: 4260513

<b>Transaction #:</b> 4376133	
<b>Date of Transaction:</b> 09/11/2018	
CUSTOMER:	
SHIRLEY WILDES PO BOX 1146 OKEECHOBEE,FL 34973-1146 US	

LINE #	QTY	DESCRIPTION	REMARKS	UNIT PRICE	TOTAL
1	1.00	LOCATABLE MINERALS / MINING CLAIMS- NOT NEW-UNADJUD,ONE AUTH NO. ONLY / MINING CLAIM MONEY RECEIVED <b>CASES: AMC393518/\$10.00</b>	2018 POL & 2019 WAIV (1)	- n/a -	10.00
<b>TOTAL:</b>					<b>\$10.00</b>

PAYMENT INFORMATION			
1	AMOUNT:	10.00	POSTMARKED: N/A
	TYPE:	CHECK	RECEIVED: 09/05/2018
	CHECK NO:	1618	
	NAME:	WILDES, SHIRLEY PO BOX 1146 OKEECHOBEE FL 34973-1146 US	

REMARKS

This receipt was generated by the automated BLM Collections and Billing System and is a paper representation of a portion of the official electronic record contained therein.



UNITED STATES  
DEPARTMENT OF THE INTERIOR  
BUREAU OF LAND MANAGEMENT

521  
YMC

MAINTENANCE FEE WAIVER CERTIFICATION

FORM APPROVED  
OMB NO. 1004-0114  
Expires: January 31, 2020

SEE INSTRUCTIONS ON PAGE 2

Amc 393518

- This small miner waiver is filed for the assessment year beginning on September 1, 2017 and ending on September 1, 2018.
- The undersigned and all related parties owned ten or fewer mining claims, mill, or tunnel sites located and maintained on Federal lands in the United States of America on September 1, 2017.
- The undersigned have performed the assessment work required by law for each mining claim listed prior to filing this waiver and understand that by filing this form, the undersigned must file an affidavit of assessment work with the Bureau of Land Management (BLM) by the December 30th following the filing of this waiver.
- The undersigned understand that if the assessment work obligation has not yet come due under 30 U.S.C. 28 (for those claims in their first assessment year only), a notice of intent to hold reciting this condition must be recorded by the December 30th following the filing of this waiver.
- The undersigned understand that mill and tunnel sites may also be listed on this waiver and be waived from payment of the maintenance fee, and that a notice of intent to hold for these sites is required to be filed with the BLM by the December 30th following the filing of this waiver.
- The undersigned understand and acknowledge that pursuant to 43 U.S.C. 1212 and 18 U.S.C. 1001, the filing or recording of a false, fictitious, or fraudulent document with the BLM may result in a fine of up to \$250,000, a prison term not to exceed five years, or both.
- The mining claims, mill or tunnel sites for which this waiver from payment of the maintenance fees is requested are:

CLAIM OR SITE NAME

BLM RECORDATION SERIAL NUMBER

CLAIM OR SITE NAME	BLM RECORDATION SERIAL NUMBER
1. Bonnie Gulch Gold ✓	Amc # 393518
2.	
3.	
4.	
5.	
6.	
7.	
8.	
9.	
10.	

RECEIVED  
ELM AZ STATE OFFICE  
2017 AUG 29 A 8:16  
PHOENIX, ARIZONA

The owner(s) (claimants) of the above mining claims and sites are:

79  
Shirley A. Wildes ✓  
(Owner's Name - Please Print)  
P.O. Box 1146  
(Owner's Mailing Address)

Shirley A. Wildes  
(Owner's Signature)  
OKEECHOBEE FL 34973  
(City) (State) (Zip Code)

56  
Donald W. Wildes Sr. ✓  
(Owner's Name - Please Print)  
P.O. Box 1146  
(Owner's Mailing Address)

Donald W. Wildes Sr.  
(Owner's Signature)  
OKEECHOBEE FL 34973  
(City) (State) (Zip Code)

(Owner's Name - Please Print)

(Owner's Mailing Address)

ENTERED  
AC483  
SEP 15 2017

BY: PB

(Owner's Signature)

(City)

(State)

(Zip Code)

(Owner's Name - Please Print)

(Owner's Mailing Address)

(Owner's Signature)

(City)

(State)

(Zip Code)

(Owner's Name - Please Print)	(Owner's Signature)
(Owner's Mailing Address)	(City) (State) (Zip Code)
(Owner's Name - Please Print)	(Owner's Signature)
(Owner's Mailing Address)	(City) (State) (Zip Code)
(Owner's Name - Please Print)	(Owner's Signature)
(Owner's Mailing Address)	(City) (State) (Zip Code)
(Owner's Name - Please Print)	(Owner's Signature)
(Owner's Mailing Address)	(City) (State) (Zip Code)

18 U.S.C. 1001 and 43 U.S.C. 1212 make it a crime for any person knowingly and willfully to make to any department or agency of the United States any false, fictitious or fraudulent statements or representations as to any matter within its jurisdiction.

**INSTRUCTIONS**

1. This certification is made under the provisions of 43 U.S.C. § 1744 and 30 U.S.C. §28-28k and the regulations thereunder (43 CFR Part 3830).
2. The claimant(s) must fill in the dates in paragraph 1 for the beginning and ending of the assessment year for which this waiver is sought.
3. The claimant(s) must fill in the date in paragraph 2 for the beginning of the assessment year for which this waiver is sought.
4. All claim and site names and BLM serial numbers must be listed for the mining claims, mill sites, and tunnel sites for which the waiver is sought.
5. All owners of the mining claims, mill sites, and tunnel sites and their addresses must be given.
6. This waiver form must be signed by all the claimants or their designated agent, in original form. If an agent is designated, a notarized designation of agent, signed by all of the claimants with proper address given, must be submitted with this waiver.
7. This form must be filed no later than September 1st for the upcoming assessment year in the BLM State Office where the mining claims or sites are recorded, or the waiver cannot be granted by the BLM. (Example: To obtain a waiver for the assessment year 2012, which begins on September 1, 2011, you must qualify for and file for a waiver no later than September 1, 2011, in the proper BLM State Office.)
8. For all mining claims which require assessment work, you must record an affidavit of labor on or before the December 30th immediately following the filing of this waiver. For all other mining claims or sites waived, you must record a notice of intent to hold on or before the December 30th immediately following the filing of this waiver.
9. Mill and tunnel sites may also be listed on this waiver and be waived from payment of the maintenance fee. A notice of intent to hold for these sites is required to be filed by the December 30th following the filing of this waiver.

165 71 432

**FOR OFFICIAL USE ONLY**

RECEIVED  
BLM STATE OFFICE  
2011 AUG 29 A 8:36  
PHOENIX, ARIZONA



UNITED STATES  
DEPARTMENT OF THE INTERIOR  
BUREAU OF LAND MANAGEMENT

FORM APPROVED  
OMB NO.: 1004-0114  
Expires: January 31, 2020

**AFFIDAVIT OF ANNUAL ASSESSMENT WORK**

393518

WHEN RECORDED, MAIL DOCUMENT TO:

NAME: Shirley A. Wildes

ADDRESS: P.O. Box 1146

CITY, STATE, ZIP: Okeechobee, FL 34977

FOR COUNTY RECORDER'S USE

No. of Claims 1

x \$10/claim

Total due BLM \$ 10.00

TO ALL WHOM IT MAY CONCERN:

1. The undersigned certifies that at least \$100 per claim was expended for development, labor and improvements, or equivalent value added, as the annual assessment work for the assessment year ending September 1, 2017 for the following contiguous unpatented mining claim(s), located in the County of Yavapai, in the State of ARIZONA.

BLM Serial No.	Name of Claim	Tp	Rg	Sec	Mer	County Recordation Book and Page No.	Co. Recording Date
<u>Amc #393518</u>	<u>Bannie Gulch Gold</u>	<u>13N</u>	<u>1W</u>	<u>22SW</u>		<u>2017-0004919</u>	<u>1-30-2017 12:41:40 PM</u>

RECEIVED  
BLM AZ STATE OFFICE  
2017 AUG 29 A 8:36  
PHOENIX, ARIZONA

#3965911

INTERESTED  
SEP 05 2017  
BY: Ram



2. Type of labor and improvements (specify what was done and give the total value for that labor and improvement to show at least \$100 for each claim). If a geological, geochemical, or geophysical survey was performed, as per 30 U.S.C. 28-1, reference the title of the report of survey, give cost and date of the survey and report, and indicate it was filed with the County Recorder:

Description of Work Performed	Value of Work Performed	Date Work Was Performed
Completed 1 Full day work at claim mining material, metal detected, picked up garbage, bottles, and bullet shells.	\$ 100.00	7-13-2017

3. Name and mailing address of each person who performed the labor and improvements:

Name (please print)

Shirley A. Wildes  
Donald W. Wildes (Sr.)

Current Mailing Address (please print)

P.O. Box 1146 Okeechobee, FL 34973  
P.O. Box 1146 Okeechobee, FL 34973

4. Name and mailing address of each person who holds and claims the subject mining claim(s) for the valuable minerals contained therein. Be sure to indicate if there is a change of address:

Name (please print)

Shirley A. Wildes  
Donald W. Wildes (Sr.)

Current Mailing Address (please print)

P.O. Box 1146 Okeechobee, FL 34973  
P.O. Box 1146 Okeechobee, FL 34973

RECEIVED  
 CLM AZ STATE OFFICE  
 2017 AUG 29 A 8:36  
 PHOENIX, ARIZONA

5. The undersigned testifies that on the date of \_\_\_\_\_, 2017, all monuments required by law were erected upon the subject claim(s), and all notices required by law were posted on the subject claim(s) or copies thereof were in place, and at said date, each corner monument bore or contained

markings sufficient to appropriately designate the corner of the claim to which it pertains and the name of the claim(s).

I hereby certify under penalty of perjury under the laws of the State of FLORIDA that the foregoing statements are true and correct:

Shirley A. Hilder

(Signature of person responsible for above statement)

Date: 7-31-17

Title 18 U.S.C. 1001 and 43 U.S.C. 1212 make it a crime for any person knowingly and willfully to make to any department or agency of the United States any false, fictitious or fraudulent statements or representations as to any matter within its jurisdiction.

**Notary Block**

SUBSCRIBED AND SWORN TO before me, this 31st day of July 2017

By: Linda M. Ballinger  
(Signature of Affiant)

Title: Notary

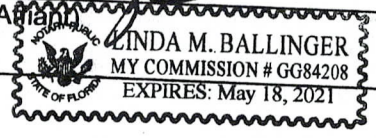

My Commission Expires: \_\_\_\_\_

**INSTRUCTIONS**

1. This is an optional form that may be used to satisfy the requirements for the Bureau of Land Management (BLM) under the provisions of 43 U.S.C. §1744 and 30 U.S.C. §28-28d and the regulations thereunder (43 CFR part 3835). Since local and State laws may vary, you should contact your local and State agencies where the claims are located to ensure all applicable laws and requirements are satisfied.
2. The claimant(s) must fill in the date in paragraph 1 for the applicable assessment year and the county and state where the claims are located.
3. All claim names, BLM serial numbers, legal descriptions, and original county recording information must be listed for the claims pertaining to this assessment notice.
4. The claimant(s) must complete paragraph 2 listing all labor or improvements which was performed on or did benefit the subject mining claims. The value and date of the labor or improvements must also be listed. The total amount of labor or improvements can be listed, but the total expenditure must equal at least \$100 for each claim.
5. The names and current mailing addresses of the person(s) performing the labor shall be listed in paragraph 3.
6. The name and current mailing address of each owner (claimant) of the claims shall be listed in paragraph 4. The mailing address shall be the owner's address and not the address of an agent or anyone representing the claimant. Be sure to note if there has been a change of address.
7. Paragraph 5 shall be completed to show the date it was verified that all monuments required by law were properly erected, all notices were posted, and that corners were appropriately designated for all claims listed.
8. An exact legible reproduction or duplicate (other than microfilm or other electronic media) of this affidavit or another type of affidavit of assessment work that you file or will file in the county where each claim is located, must be filed with the BLM on or before December 30 of the calendar year in which the assessment year ends. For mill or tunnel sites, a separate notice of intent to hold must be filed with the BLM on or before December 30. Requirements for filing a notice of intent to hold can be found at 43 CFR 3835.33.
9. A processing fee of \$10 for each claim listed must be remitted to the BLM along with this or any other affidavit of assessment work.

## NOTICES

**THE PRIVACY ACT** and 43 CFR 2.223(d) require that you be furnished with the following information in connection with the information requested by this form.

**AUTHORITY:** 30 U.S.C. §28-28d and 43 CFR part 3835 permit collection of the information requested by this form.

**PRINCIPAL PURPOSE:** The BLM will use the information you provide to document compliance with 43 U.S.C. 1744 and that assessment work has been completed in accordance with 30 U.S.C. § 28-28d and 43 CFR part 3835 in lieu of paying the maintenance fee for the mining claims listed on this form.

**ROUTINE USES:** The BLM will only disclose this information in accordance with the provisions at 43 CFR 2.231(b) and (c).

**EFFECT OF NOT PROVIDING INFORMATION:** Disclosure of the requested information is required by 30 U.S.C. § 28-28d and 43 CFR part 3835 for claimants qualified to perform assessment work in lieu of paying the maintenance fee. Failure to submit all the requested information or to complete this form will delay the BLM's processing of the form and may preclude the BLM's acceptance of the assessment work information, which may result in forfeiture of the mining claim(s) by the claimant.

**THE PAPERWORK REDUCTION ACT** requires us to inform you that:

Use of this form is optional. You must perform assessment if a waiver to pay the maintenance fee has been requested. This form is provided to help you attest that annual assessment work has been completed in lieu of paying the maintenance fee for your claim(s). Submission of the requested information is necessary to obtain or retain a benefit.

You do not have to respond to this or any other Federal agency-sponsored information collection unless it displays a valid OMB control number.

**BURDEN HOURS STATEMENT:** The estimated public reporting burden for this form is 30 minutes per response, including the time for reviewing instructions, gathering and maintaining data, and completing and reviewing the form. You may submit comments regarding the burden estimate or any other aspect of this form to: U.S. Department of the Interior, Bureau of Land Management (1004-0114), Bureau Information Collection Clearance Officer (WO-630), 1849 C Street, N.W., Room 2134LM, Washington, D.C. 20240.



Shirley Wildes  
P.O. Box 1146  
Okechobee, Fl.  
34973

WEST PALM BCH FL 334

25 AUG 2017 PM 1 L



RECEIVED  
BLM AZ STATE OFFICE

2017 AUG 29 A 8:36

PHOENIX, ARIZONA

B.L.M. of Arizona  
One North Central Avenue  
Phoenix, Arizona  
85004-4427

85004-442700



**United States Department of the Interior**  
**Bureau of Land Management**  
 DIV OF LANDS, MINRLS & ENERGY  
 ONE N CENTRAL AVE  
 PHOENIX, AZ 85004 -4427  
 Phone: 602-417-9200

Receipt

No: 3965911

<b>Transaction #:</b> 4075794	
<b>Date of Transaction:</b> 08/30/2017	
CUSTOMER:	
SHIRLEY WILDES ET AL PO BOX 1146 OKEECHOBEE,FL 34973-1146 US	

LINE #	QTY	DESCRIPTION	REMARKS	UNIT PRICE	TOTAL
1	1.00	LOCATABLE MINERALS / MINING CLAIMS- NOT NEW-UNADJUD,ONE AUTH NO. ONLY / MINING CLAIM MONEY RECEIVED CASES: AMC393518/\$10.00	POL 2017/1 WAV	- n/a -	10.00
<b>TOTAL:</b>					<b>\$10.00</b>

PAYMENT INFORMATION					
1	AMOUNT:	10.00	POSTMARKED:	08/25/2017	
	TYPE:	CHECK	RECEIVED:	08/29/2017	
	CHECK NO:	1477			
	NAME:	WILDES, SHIRLEY A PO BOX 1146 OKEECHOBEE FL 34973-1146 US			

REMARKS

This receipt was generated by the automated BLM Collections and Billing System and is a paper representation of a portion of the official electronic record contained therein.

UNITED STATES  
DEPARTMENT OF THE INTERIOR  
BUREAU OF LAND MANAGEMENT

524

ADJ

MAINTENANCE FEE WAIVER CERTIFICATION

FORM APPROVED  
OMB NO. 1004-0114  
Expires: October 31, 2016

393518 395685

SEE INSTRUCTIONS ON PAGE 2

- This small miner waiver is filed for the assessment year beginning on September 1, 2015 and ending on September 1, 2016.
- The undersigned and all related parties owned ten or fewer mining claims, mill, or tunnel sites located and maintained on Federal lands in the United States of America on September 1, \_\_\_\_\_.
- The undersigned have performed the assessment work required by law for each mining claim listed prior to filing this waiver and understand that by filing this form, the undersigned must file an affidavit of assessment work with the Bureau of Land Management (BLM) by the December 30th following the filing of this waiver.
- The undersigned understand that if the assessment work obligation has not yet come due under 30 U.S.C. 28 (for those claims in their first assessment year only), a notice of intent to hold reciting this condition must be recorded by the December 30th following the filing of this waiver.
- The undersigned understand that mill and tunnel sites may also be listed on this waiver and be waived from payment of the maintenance fee, and that a notice of intent to hold for these sites is required to be filed with the BLM by the December 30th following the filing of this waiver.
- The undersigned understand and acknowledge that pursuant to 43 U.S.C. 1212 and 18 U.S.C. 1001, the filing or recording of a false, fictitious, or fraudulent document with the BLM may result in a fine of up to \$250,000, a prison term not to exceed five years, or both.
- The mining claims, mill or tunnel sites for which this waiver from payment of the maintenance fees is requested are:

CLAIM OR SITE NAME	BLM RECORDATION SERIAL NUMBER
1. <u>Bonnie Gulch Gold</u>	<u>AMC # 393518</u> ✓
2. <u>New England Gold</u>	<u>AMC # 395865</u>
3.	
4.	
5.	
6.	
7.	
8.	
9.	
10.	

RECEIVED  
 BLM AZ STATE OFFICE  
 2016 AUG 29 P 3:03  
 PHOENIX, ARIZONA

The owner(s) (claimants) of the above mining claims and sites are:

Shirley A. Wildes  
(Owner's Name - Please Print)  
P.O. Box 1146  
(Owner's Mailing Address)

Shirley Wildes  
(Owner's Signature)  
Okechobee IL 34973  
(City) (State) (Zip Code)

Donald W Wildes  
(Owner's Name - Please Print)  
P.O. Box 1146  
(Owner's Mailing Address)

Donald W. Wildes  
(Owner's Signature)  
Okechobee IL 34973  
(City) (State) (Zip Code)

(Owner's Name - Please Print)

(Owner's Signature)

(Owner's Mailing Address)

(City)

(State)

(Zip Code)

(Owner's Name - Please Print)

(Owner's Signature)

(Owner's Mailing Address)

(City)

(State)

(Zip Code)

ENTERED  
SEP - 8 2016  
BY: RE

NL  
9.8  
RE



(Owner's Name - Please Print)

(Owner's Signature)

(Owner's Mailing Address)

RECEIVED  
BLM AZ STATE OFFICE  
(City) (State) (Zip Code)

2011 AUG 29 P 3 03

(Owner's Name - Please Print)

(Owner's Signature)  
PHOENIX, ARIZONA

(Owner's Mailing Address)

(City) (State) (Zip Code)

(Owner's Name - Please Print)

(Owner's Signature)

(Owner's Mailing Address)

(City) (State) (Zip Code)

(Owner's Name - Please Print)

(Owner's Signature)

(Owner's Mailing Address)

(City) (State) (Zip Code)

18 U.S.C. 1001 and 43 U.S.C. 1212 make it a crime for any person knowingly and willfully to make to any department or agency of the United States any false, fictitious or fraudulent statements or representations as to any matter within its jurisdiction.

INSTRUCTIONS

1. This certification is made under the provisions of 43 U.S.C. § 1744 and 30 U.S.C. §28-28k and the regulations thereunder (43 CFR Part 3830).
2. The claimant(s) must fill in the dates in paragraph 1 for the beginning and ending of the assessment year for which this waiver is sought.
3. The claimant(s) must fill in the date in paragraph 2 for the beginning of the assessment year for which this waiver is sought.
4. All claim and site names and BLM serial numbers must be listed for the mining claims, mill sites, and tunnel sites for which the waiver is sought.
5. All owners of the mining claims, mill sites, and tunnel sites and their addresses must be given.
6. This waiver form must be signed by all the claimants or their designated agent, in original form. If an agent is designated, a notarized designation of agent, signed by all of the claimants with proper address given, must be submitted with this waiver.
7. This form must be filed no later than September 1st for the upcoming assessment year in the BLM State Office where the mining claims or sites are recorded, or the waiver cannot be granted by the BLM. (Example: To obtain a waiver for the assessment year 2012, which begins on September 1, 2011, you must qualify for and file for a waiver no later than September 1, 2011, in the proper BLM State Office.)
8. For all mining claims which require assessment work, you must record an affidavit of labor on or before the December 30th immediately following the filing of this waiver. For all other mining claims or sites waived, you must record a notice of intent to hold on or before the December 30th immediately following the filing of this waiver.
9. Mill and tunnel sites may also be listed on this waiver and be waived from payment of the maintenance fee. A notice of intent to hold for these sites is required to be filed by the December 30th following the filing of this waiver.

FOR OFFICIAL USE ONLY

393518  
395865

RECEIVED  
BLM AZ STATE OFFICE

2016 AUG 29 P 3:03

PHOENIX, ARIZONA

**When Recorded Mail to:**

Name: Shirley or Donald Wildes (SR.)

Address: PO Box 1146

City: Keeshobee State FL.

Zip Code: 34973

---

AFFIDAVIT OF ANNUAL ASSESSMENT WORK

Document Title

**AFFIDAVIT OF ANNUAL ASSESSMENT WORK**

WHEN RECORDED, MAIL DOCUMENT TO:

NAME: Shirley Wildes or Donald Wildes  
(SR)

ADDRESS: PO Box 1146

Okreechabee, Fl. 34973  
CITY, STATE, ZIP:

FOR COUNTY RECORDER'S USE

No. of Claims 2  
x \$10/claim  
Total due BLM \$ 20.00

TO ALL WHOM IT MAY CONCERN:

1. The undersigned certifies that at least \$100 per claim was expended for development, labor and improvements, or equivalent value added, as the annual assessment work for the assessment year ending September 1, 2016 for the following contiguous unpatented mining claim(s), located in the County of Yavapai, in the State of Arizona.

BLM Serial No.	Name of Claim	Tp	Rg	Sec	Mer	County Recordation Book and Page No.	Date
<u>Amc. 393518</u>	<u>Bannie Gulch Gold</u>	<u>13N</u>	<u>1W</u>	<u>22SW</u>		<u>2015-0053481</u>	<u>11-9-2015</u> <u>10:28:11 AM</u>
<u>Amc. 395865</u>	<u>New England Gold</u>	<u>13N</u>	<u>2W</u>	<u>(NE 1/2 of NW Sec 21)</u>			

RECEIVED  
 BLM AZ STATE OFFICE  
 PHOENIX, ARIZONA  
 2016 AUG 29 P 3:03

2. Type of labor and improvements (specify what was done and give the total value for that labor and improvement to show at least \$100 for each claim). If a geological, geochemical, or geophysical survey was performed, as per 30 U.S.C. 28-1, reference the title of the report of survey, give cost and date of the survey and report, and indicate it was filed with the County Recorder:

Description of Work Performed	Value of Work Performed	Date Work Was Performed
AMC # 393518 pickup debris worked material, metal detected 1 full day at claim.	\$ 100.00	Wed 8-10-2016
AMC # 395865 worked material at claim, picked up trash, and did metal detecting at claim 1-day	\$ 100.00	Thurs. 8-11-2016

3. Name and mailing address of each person who performed the labor and improvements:

<p>Name (please print)</p> <p><u>Shirley A. Wildes</u></p> <p><u>Donald W. Wildes</u></p> <p>_____</p> <p>_____</p>	<p>Current Mailing Address (please print)</p> <p><u>PO Box 1146 Okeechobee, FL 34973</u></p> <p><u>PO Box 1146 Okeechobee, FL 34973</u></p> <p>_____</p> <p>_____</p>
---	---

4. Name and mailing address of each person who holds and claims the subject mining claim(s) for the valuable minerals contained therein. Be sure to indicate if there is a change of address:

<p>Name (please print)</p> <p><u>Shirley A. Wildes</u></p> <p><u>Donald W. Wildes</u></p> <p>_____</p> <p>_____</p>	<p>Current Mailing Address (please print)</p> <p><u>P.O. Box 1146 Okeechobee, FL 34973</u></p> <p><u>P.O. Box 1146 Okeechobee, FL 34973</u></p> <p>_____</p> <p>_____</p>
---	---

RECEIVED  
 BLM AZ STATE OFFICE  
 2016 AUG 29 PM 3:03  
 PHOENIX, ARIZONA

5. The undersigned testifies that on the date of Wed 8-10-2016 AMC # 393518 and Thurs. 8-11-2016 AMC 395865, all monuments required by law were erected upon the subject claim(s), and all notices required by law were posted on the subject claim(s) or copies thereof were in place, and at said date, each corner monument bore or contained



markings sufficient to appropriately designate the corner of the claim to which it pertains and the name of the claim(s).

I hereby certify under penalty of perjury under the laws of the State of Florida that the foregoing statements are true and correct:

Shirley A. Hildes  
(Signature of person responsible for above statement)

Date: 8-25-16

Title 18 U.S.C. 1001 and 43 U.S.C. 1212 make it a crime for any person knowingly and willfully to make to any department or agency of the United States any false, fictitious or fraudulent statements or representations as to any matter within its jurisdiction.

**Notary Block**

SUBSCRIBED AND SWORN TO before me, this 25th day of August 2016

By: Linda M. Ballinger  
(Signature of Affiant)

Title: Notary

My Commission Expires: \_\_\_\_\_

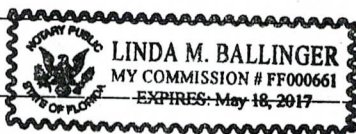

RECEIVED  
BLM AZ STATE OFFICE  
2016 AUG 29 P 3:03  
PHOENIX, ARIZONA

**INSTRUCTIONS**

1. This is an optional form that may be used to satisfy the requirements for the Bureau of Land Management (BLM) under the provisions of 43 U.S.C. §1744 and 30 U.S.C. §28-28d and the regulations thereunder (43 CFR part 3835). Since local and State laws may vary, you should contact your local and State agencies where the claims are located to ensure all applicable laws and requirements are satisfied.
2. The claimant(s) must fill in the date in paragraph 1 for the applicable assessment year and the county and state where the claims are located.
3. All claim names, BLM serial numbers, legal descriptions, and original county recording information must be listed for the claims pertaining to this assessment notice.
4. The claimant(s) must complete paragraph 2 listing all labor or improvements which was performed on or did benefit the subject mining claims. The value and date of the labor or improvements must also be listed. The total amount of labor or improvements can be listed, but the total expenditure must equal at least \$100 for each claim.
5. The names and current mailing addresses of the person(s) performing the labor shall be listed in paragraph 3.
6. The name and current mailing address of each owner (claimant) of the claims shall be listed in paragraph 4. The mailing address shall be the owner's address and not the address of an agent or anyone representing the claimant. Be sure to note if there has been a change of address.
7. Paragraph 5 shall be completed to show the date it was verified that all monuments required by law were properly erected, all notices were posted, and that corners were appropriately designated for all claims listed.
8. An exact legible reproduction or duplicate (other than microfilm or other electronic media) of this affidavit or another type of affidavit of assessment work that you file or will file in the county where each claim is located, must be filed with the BLM on or before December 30 of the calendar year in which the assessment year ends. For mill or tunnel sites, a separate notice of intent to hold must be filed with the BLM on or before December 30. Requirements for filing a notice of intent to hold can be found at 43 CFR 3835.33.
9. A processing fee of \$10 for each claim listed must be remitted to the BLM along with this or any other affidavit of assessment work.

## NOTICES

**THE PRIVACY ACT** and 43 CFR 2.48(d) require that you be furnished with the following information in connection with the information requested by this form.

**AUTHORITY:** 30 U.S.C. §28-28d and 43 CFR part 3835 permit collection of the information requested by this form.

**PRINCIPAL PURPOSE:** The BLM will use the information you provide to document compliance with 43 U.S.C. 1744 and that assessment work has been completed in accordance with 30 U.S.C. § 28-28d and 43 CFR part 3835 in lieu of paying the maintenance fee for the mining claims listed on this form.

**ROUTINE USES:** The BLM will only disclose this information in accordance with the provisions at 43 CFR 2.56(b) and (c).

**EFFECT OF NOT PROVIDING INFORMATION:** Disclosure of the requested information is required by 30 U.S.C. § 28-28d and 43 CFR part 3835 for claimants qualified to perform assessment work in lieu of paying the maintenance fee. Failure to submit all the requested information or to complete this form will delay the BLM's processing of the form and may preclude the BLM's acceptance of the assessment work information, which may result in forfeiture of the mining claim(s) by the claimant.

**THE PAPERWORK REDUCTION ACT** requires us to inform you that:

Use of this form is optional. You must perform assessment if a waiver to pay the maintenance fee has been requested. This form is provided to help you attest that annual assessment work has been completed in lieu of paying the maintenance fee for your claim(s). Submission of the requested information is necessary to obtain or retain a benefit.

You do not have to respond to this or any other Federal agency-sponsored information collection unless it displays a valid OMB control number.

**BURDEN HOURS STATEMENT:** The estimated public reporting burden for this form is 30 minutes per response, including the time for reviewing instructions, gathering and maintaining data, and completing and reviewing the form. You may submit comments regarding the burden estimate or any other aspect of this form to: U.S. Department of the Interior, Bureau of Land Management (1004-0114), Bureau Information Collection Clearance Officer (WO-630), 1849 C Street, N.W., Room 2134LM, Washington, D.C. 20240.

RECEIVED  
BLM AZ STATE OFFICE  
2016 AUG 29 P 3:03  
PHOENIX, ARIZONA

Shirley Wildes  
P.O. Box 1146  
Kellchisee Florida  
34973

WEST PALM BCH FL 334

25 AUG 2005 PM 4:11

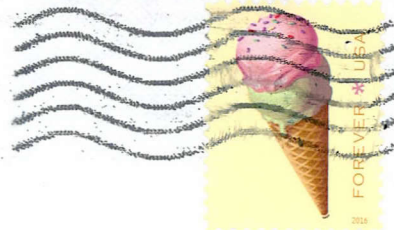

Arizona Bureau of Land Management  
One North Central Avenue  
Phoenix, Arizona  
85004-2203

85004-442700





**United States Department of the Interior  
Bureau of Land Management**

DIV OF LANDS, MINRLS & ENERGY  
ONE N CENTRAL AVE  
PHOENIX, AZ 85004 -4427  
Phone: 602-417-9200

Receipt

No: 3646896

<b>Transaction #:</b> 3750882	
<b>Date of Transaction:</b> 08/30/2016	
CUSTOMER:	
SHIRLEY WILDES PO BOX 1146 OKEECHOBEE, FL 34973-1146 US	

LINE #	QTY	DESCRIPTION	REMARKS	UNIT PRICE	TOTAL
1	1.00	LOCATABLE MINERALS / MINING CLAIMS-NOT NEW-UNADJUD, ONE AUTH NO. ONLY / MINING CLAIM MONEY RECEIVED <b>CASES:</b> AMC393518/\$20.00	WAIVER 2017 - 2 / POL 2016 - 2	- n/a -	20.00
<b>TOTAL:</b>					<b>\$20.00</b>

PAYMENT INFORMATION					
1	AMOUNT:	20.00	POSTMARKED:	08/26/2016	
	TYPE:	CHECK	RECEIVED:	08/29/2016	
	CHECK NO:	1285			
	NAME:	WILDES, SHIRLEY PO BOX 1146 OKEECHOBEE FL 34973-1146 US			

REMARKS

This receipt was generated by the automated BLM Collections and Billing System and is a paper representation of a portion of the official electronic record contained therein.

  
 ENTERED  
 SEP -1 2016  
 BY: *[signature]*



UNITED STATES  
DEPARTMENT OF THE INTERIOR  
BUREAU OF LAND MANAGEMENT

585

ADD.

393518  
395865  
FORM APPROVED  
OMB NO. 1004-0114  
Expires: October 31, 2016

**MAINTENANCE FEE WAIVER CERTIFICATION**

SEE INSTRUCTIONS ON PAGE 2

- This small miner waiver is filed for the assessment year beginning on September 1, 2014 and ending on September 1, 2015.
- The undersigned and all related parties owned ten or fewer mining claims, mill, or tunnel sites located and maintained on Federal lands in the United States of America on September 1, 2015.
- The undersigned have performed the assessment work required by law for each mining claim listed prior to filing this waiver and understand that by filing this form, the undersigned must file an affidavit of assessment work with the Bureau of Land Management (BLM) by the December 30th following the filing of this waiver.
- The undersigned understand that if the assessment work obligation has not yet come due under 30 U.S.C. 28 (for those claims in their first assessment year only), a notice of intent to hold reciting this condition must be recorded by the December 30th following the filing of this waiver.
- The undersigned understand that mill and tunnel sites may also be listed on this waiver and be waived from payment of the maintenance fee, and that a notice of intent to hold for these sites is required to be filed with the BLM by the December 30th following the filing of this waiver.
- The undersigned understand and acknowledge that pursuant to 43 U.S.C. 1212 and 18 U.S.C. 1001, the filing or recording of a false, fictitious, or fraudulent document with the BLM may result in a fine of up to \$250,000, a prison term not to exceed five years, or both.
- The mining claims, mill or tunnel sites for which this waiver from payment of the maintenance fees is requested are:

CLAIM OR SITE NAME	BLM RECORDATION SERIAL NUMBER
1. Bonnie Gulch Gold	AMC 393518 ✓
2. New England Gold	AMC 395865
3.	
4.	
5.	
6.	
7.	
8.	
9.	
10.	

RECEIVED  
 BLM AZ STATE OFFICE  
 2015 AUG 31 P 4: 02  
 PHOENIX, ARIZONA

The owner(s) (claimants) of the above mining claims and sites are:

Shirley A. Wildes  
(Owner's Name - Please Print)  
P.O. Box 1146  
(Owner's Mailing Address)

Shirley A. Wildes  
(Owner's Signature)  
Okeechobee FL 34973  
(City) (State) (Zip Code)

Donald W Wildes  
(Owner's Name - Please Print)  
P.O. Box 1146  
(Owner's Mailing Address)

Donald W Wildes  
(Owner's Signature)  
Okeechobee FL 34973  
(City) (State) (Zip Code)

(Owner's Name - Please Print)

(Owner's Signature)

(Owner's Mailing Address)

(City) (State) (Zip Code)

(Owner's Name - Please Print)

(Owner's Signature)

(Owner's Mailing Address)

(City) (State) (Zip Code)

ENTERED  
SEP 10 2015  
BY: [Signature]

(Owner's Name - Please Print)	(Owner's Signature)		
(Owner's Mailing Address)	(City)	(State)	(Zip Code)
(Owner's Name - Please Print)	(Owner's Signature)		
(Owner's Mailing Address)	(City)	(State)	(Zip Code)
(Owner's Name - Please Print)	(Owner's Signature)		
(Owner's Mailing Address)	(City)	(State)	(Zip Code)
(Owner's Name - Please Print)	(Owner's Signature)		
(Owner's Mailing Address)	(City)	(State)	(Zip Code)

18 U.S.C. 1001 and 43 U.S.C. 1212 make it a crime for any person knowingly and willfully to make to any department or agency of the United States any false, fictitious or fraudulent statements or representations as to any matter within its jurisdiction.

**INSTRUCTIONS**

1. This certification is made under the provisions of 43 U.S.C. § 1744 and 30 U.S.C. §28-28k and the regulations thereunder (43 CFR Part 3830).
2. The claimant(s) must fill in the dates in paragraph 1 for the beginning and ending of the assessment year for which this waiver is sought.
3. The claimant(s) must fill in the date in paragraph 2 for the beginning of the assessment year for which this waiver is sought.
4. All claim and site names and BLM serial numbers must be listed for the mining claims, mill sites, and tunnel sites for which the waiver is sought.
5. All owners of the mining claims, mill sites, and tunnel sites and their addresses must be given.
6. This waiver form must be signed by all the claimants or their designated agent, in original form. If an agent is designated, a notarized designation of agent, signed by all of the claimants with proper address given, must be submitted with this waiver.
7. This form must be filed no later than September 1st for the upcoming assessment year in the BLM State Office where the mining claims or sites are recorded, or the waiver cannot be granted by the BLM. (Example: To obtain a waiver for the assessment year 2012, which begins on September 1, 2011, you must qualify for and file for a waiver no later than September 1, 2011, in the proper BLM State Office.)
8. For all mining claims which require assessment work, you must record an affidavit of labor on or before the December 30th immediately following the filing of this waiver. For all other mining claims or sites waived, you must record a notice of intent to hold on or before the December 30th immediately following the filing of this waiver.
9. Mill and tunnel sites may also be listed on this waiver and be waived from payment of the maintenance fee. A notice of intent to hold for these sites is required to be filed by the December 30th following the filing of this waiver.

RECEIVED  
 BLM STATE OFFICE  
 PHOENIX, ARIZONA  
 210 AUG 31 P 4: 02

FOR OFFICIAL USE ONLY



393518

395865

**AFFIDAVIT OF ANNUAL ASSESSMENT WORK**

WHEN RECORDED, MAIL DOCUMENT TO:

NAME: Shirley or Donald Wildes (SR)

ADDRESS: PO Box 1146

CITY, STATE, ZIP: Keeshobee, FL 34973

FOR COUNTY RECORDER'S USE

No. of Claims 2

x \$10/claim

Total due BLM \$ 20.<sup>00</sup>

TO ALL WHOM IT MAY CONCERN:

**RECEIPT # 3383831**

1. The undersigned certifies that at least \$100 per claim was expended for development, labor and improvements, or equivalent value added, as the annual assessment work for the assessment year ending September 1, 2015 for the following contiguous unpatented mining claim(s), located in the County of Yavapai, in the State of Arizona.

BLM Serial No.	Name of Claim	Tp	Rg	Sec	Mer	County Recordation Book and Page No.	Date
AMC 393518	Bunnie Gulch Gold	13N	1W	22SW		2014-0042191	9-16-15 10:46:11 AM
AMC 395865	New England Gold	13N	2W	(NE 20 <sup>th</sup> NW sec.) <u>21</u>		2014-0042191	9-16-15 10:46:11 AM
						PHOENIX, ARIZONA	
						2015 AUG 31 P 4:02	RECEIVED
							OFFICE

**ENTERED**  
**SEP 02 2015**  
BY: sl



2. Type of labor and improvements (specify what was done and give the total value for that labor and improvement to show at least \$100 for each claim). If a geological, geochemical, or geophysical survey was performed, as per 30 U.S.C. 28-1, reference the title of the report of survey, give cost and date of the survey and report, and indicate it was filed with the County Recorder:

	Value of Work Performed	Date Work Was Performed
#393518 Worked at claim metal detecting and working material plus garbage removal.	\$100.00	6/13/15 (Sat)
#5865 Worked at claim checked markers and signs worked material and metal detected.	\$100.00	6/14/15 (Sun)

3. Name and mailing address of each person who performed the labor and improvements:

Name (please print)	Current Mailing Address (please print)
Shirley A. Wildes	PO Box 1146 Okeechobee, FL 34973
Donald W. Wildes (SR)	PO Box 1146 Okeechobee, FL 34973
_____	_____
_____	_____

4. Name and mailing address of each person who holds and claims the subject mining claim(s) for the valuable minerals contained therein. Be sure to indicate if there is a change of address:

Name (please print)	Current Mailing Address (please print)
Shirley A. Wildes	PO Box 1146 Okeechobee, FL 34973
Donald W. Wildes (SR)	PO Box 1146 Okeechobee, FL 34973
_____	_____
_____	_____
_____	_____
_____	_____
_____	_____
_____	_____
_____	_____

RECEIVED  
 JUN 31 P 4:02  
 DENIX ANIZONA

5. The undersigned testifies that on the date of 6/13/15 & 6/14/15, 2015, all monuments required by law were erected upon the subject claim(s), and all notices required by law were posted on the subject claim(s) or copies thereof were in place, and at said date, each corner monument bore or contained

markings sufficient to appropriately designate the corner of the claim to which it pertains and the name of the claim(s).

I hereby certify under penalty of perjury under the laws of the State of Florida that the foregoing statements are true and correct:

Shirley Wildes Date: 8-21-15  
(Signature of person responsible for above statement)

Title 18 U.S.C. 1001 and 43 U.S.C. 1212 make it a crime for any person knowingly and willfully to make to any department or agency of the United States any false, fictitious or fraudulent statements or representations as to any matter within its jurisdiction.

**Notary Block**

SUBSCRIBED AND SWORN TO before me, this 21 day of August 2015

By: Shirley Wildes Peggy L. Simmons  
(Signature of Affiant)

Title: Notary Public



PEGGY L. SIMMONS  
Notary Public, State of Florida  
My Comm. Expires Oct. 31, 2015  
Commission No. EE-124799

My Commission Expires: \_\_\_\_\_

RECEIVED  
BLM ASSESSMENT OFFICE  
2015 AUG 31 P 4: 05  
PHOENIX, ARIZONA

**INSTRUCTIONS**

1. This is an optional form that may be used to satisfy the requirements for the Bureau of Land Management (BLM) under the provisions of 43 U.S.C. §1744 and 30 U.S.C. §28-28d and the regulations thereunder (43 CFR part 3835). Since local and State laws may vary, you should contact your local and State agencies where the claims are located to ensure all applicable laws and requirements are satisfied.
2. The claimant(s) must fill in the date in paragraph 1 for the applicable assessment year and the county and state where the claims are located.
3. All claim names, BLM serial numbers, legal descriptions, and original county recording information must be listed for the claims pertaining to this assessment notice.
4. The claimant(s) must complete paragraph 2 listing all labor or improvements which was performed on or did benefit the subject mining claims. The value and date of the labor or improvements must also be listed. The total amount of labor or improvements can be listed, but the total expenditure must equal at least \$100 for each claim.
5. The names and current mailing addresses of the person(s) performing the labor shall be listed in paragraph 3.
6. The name and current mailing address of each owner (claimant) of the claims shall be listed in paragraph 4. The mailing address shall be the owner's address and not the address of an agent or anyone representing the claimant. Be sure to note if there has been a change of address.
7. Paragraph 5 shall be completed to show the date it was verified that all monuments required by law were properly erected, all notices were posted, and that corners were appropriately designated for all claims listed.
8. An exact legible reproduction or duplicate (other than microfilm or other electronic media) of this affidavit or another type of affidavit of assessment work that you file or will file in the county where each claim is located, must be filed with the BLM on or before December 30 of the calendar year in which the assessment year ends. For mill or tunnel sites, a separate notice of intent to hold must be filed with the BLM on or before December 30. Requirements for filing a notice of intent to hold can be found at 43 CFR 3835.33.
9. A processing fee of \$10 for each claim listed must be remitted to the BLM along with this or any other affidavit of assessment work.

## NOTICES

**THE PRIVACY ACT** and 43 CFR 2.48(d) require that you be furnished with the following information in connection with the information requested by this form.

**AUTHORITY:** 30 U.S.C. §28-28d and 43 CFR part 3835 permit collection of the information requested by this form.

**PRINCIPAL PURPOSE:** The BLM will use the information you provide to document compliance with 43 U.S.C. 1744 and that assessment work has been completed in accordance with 30 U.S.C. § 28-28d and 43 CFR part 3835 in lieu of paying the maintenance fee for the mining claims listed on this form.

**ROUTINE USES:** The BLM will only disclose this information in accordance with the provisions at 43 CFR 2.56(b) and (c).

**EFFECT OF NOT PROVIDING INFORMATION:** Disclosure of the requested information is required by 30 U.S.C. § 28-28d and 43 CFR part 3835 for claimants qualified to perform assessment work in lieu of paying the maintenance fee. Failure to submit all the requested information or to complete this form will delay the BLM's processing of the form and may preclude the BLM's acceptance of the assessment work information, which may result in forfeiture of the mining claim(s) by the claimant.

**THE PAPERWORK REDUCTION ACT** requires us to inform you that:

Use of this form is optional. You must perform assessment if a waiver to pay the maintenance fee has been requested. This form is provided to help you attest that annual assessment work has been completed in lieu of paying the maintenance fee for your claim(s). Submission of the requested information is necessary to obtain or retain a benefit.

You do not have to respond to this or any other Federal agency-sponsored information collection unless it displays a valid OMB control number.

**BURDEN HOURS STATEMENT:** The estimated public reporting burden for this form is 30 minutes per response, including the time for reviewing instructions, gathering and maintaining data, and completing and reviewing the form. You may submit comments regarding the burden estimate or any other aspect of this form to: U.S. Department of the Interior, Bureau of Land Management (1004-0114), Bureau Information Collection Clearance Officer (WO-630), 1849 C Street, N.W., Room 2134LM, Washington, D.C. 20240.

RECEIVED  
BLM AT PHOENIX OFFICE  
2015 AUG 31 P 4: 02  
PHOENIX, ARIZONA



Shirley A. Wildes  
Donald W. Wildes  
P.O. Box 1146  
Okeechobee, FL 34973-1146

WEST PALM BCH FL 334

28 AUG 2015 PM 3 L



RECEIVED  
BLM AZ STATE OFFICE

2015 AUG 31 P 3:59

PHOENIX, ARIZONA

AME# 395318-Bannie Gulch  
AME# 395865 New England

BLM of Arizona  
One North Central Ave.  
Phoenix, Arizona  
85004-2203

85004442700



**United States Department of the Interior**  
**Bureau of Land Management**  
 LANDS/RECREATION & PLANNING  
 ONE N CENTRAL AVE  
 PHOENIX, AZ 85004 -2203  
 Phone: 602-417-9200

Receipt

No: 3383831

<b>Transaction #:</b> 3482151	
<b>Date of Transaction:</b> 09/01/2015	
CUSTOMER:	
SHIRLEY WILDES PO BOX 1146 OKEECHOBEE, FL 34973-1146 US	

LINE #	QTY	DESCRIPTION	REMARKS	UNIT PRICE	TOTAL
1	1.00	LOCATABLE MINERALS / MINING CLAIMS-NOT NEW-UNADJUD, ONE AUTH NO. ONLY / MINING CLAIM MONEY RECEIVED CASES: AMC393518/\$20.00	WAIVER - 2 2016 / POL - 2 2015	- n/a -	20.00
<b>TOTAL:</b>					<b>\$20.00</b>

PAYMENT INFORMATION			
1	AMOUNT:	20.00	POSTMARKED: 08/28/2015
	TYPE:	CHECK	RECEIVED: 08/31/2015
	CHECK NO:	3253	
	NAME:	WILDES, SHIRLEY A PO BOX 1146 OKEECHOBEE FL 34973-1146 US	

REMARKS

This receipt was generated by the automated BLM Collections and Billing System and is a paper representation of a portion of the official electronic record contained therein.

  
 ENTERED  
 SEP 02 2015  
 BY: ee

AMC 393518

395865

389919

Form 3830-2  
(November 2010)

UNITED STATES  
DEPARTMENT OF THE INTERIOR  
BUREAU OF LAND MANAGEMENT  
**MAINTENANCE FEE WAIVER CERTIFICATION**

1691

*[Handwritten Signature]*

FORM APPROVED  
OMB NO. 1004-0114  
Expires: August 31, 2013

SEE INSTRUCTIONS ON PAGE 2

1. This small miner waiver is filed for the assessment year beginning on September 1, ~~2013~~ <sup>2014</sup> and ending on September 1, ~~2014~~ <sup>2015</sup>
2. The undersigned and all related parties owned ten or fewer mining claims, mill, or tunnel sites located and maintained on Federal lands in the United States of America on September 1, ~~2014~~ <sup>2014</sup>.
3. The undersigned have performed the assessment work required by law for each mining claim listed prior to filing this waiver and understand that by filing this form, the undersigned must file an affidavit of assessment work with the Bureau of Land Management (BLM) by the December 30th following the filing of this waiver.
4. The undersigned understand that if the assessment work obligation has not yet come due under 30 U.S.C. 28 (for those claims in their first assessment year only), a notice of intent to hold reciting this condition must be recorded by the December 30th following the filing of this waiver.
5. The undersigned understand that mill and tunnel sites may also be listed on this waiver and be waived from payment of the maintenance fee, and that a notice of intent to hold for these sites is required to be filed with the BLM by the December 30th following the filing of this waiver.
6. The undersigned understand and acknowledge that pursuant to 43 U.S.C. 1212 and 18 U.S.C. 1001, the filing or recording of a false, fictitious, or fraudulent document with the BLM may result in a fine of up to \$250,000, a prison term not to exceed five years, or both.
7. The mining claims, mill or tunnel sites for which this waiver from payment of the maintenance fees is requested are:

CLAIM OR SITE NAME	BLM RECORDATION SERIAL NUMBER
1. <u>Bonnie Gulch Gold</u>	✓ <u>AMC# 393518</u>
2. <u>New ENGLAND Gold</u>	<u>AMC# 395865</u>
3.	
4.	
5.	
6.	
7.	
8.	
9.	
10.	

RECEIVED  
BLM AZ STATE OFFICE  
2014 SEP - 2 P 3:41  
PHOENIX ARIZONA

The owner(s) (claimants) of the above mining claims and sites are:

Shirley A. Wildes  
(Owner's Name - Please Print)  
P.O. Box 1146  
(Owner's Mailing Address)

Shirley A. Wildes  
(Owner's Signature)  
Okeechobee FL 34973  
(City) (State) (Zip Code)

Donald W Wildes  
(Owner's Name - Please Print)  
Po box 1146  
(Owner's Mailing Address)

Donald W Wildes  
(Owner's Signature)  
Okeechobee FL 34973  
(City) (State) (Zip Code)

\_\_\_\_\_  
(Owner's Name - Please Print)  
\_\_\_\_\_  
(Owner's Mailing Address)

\_\_\_\_\_  
(Owner's Signature)  
\_\_\_\_\_  
(City) (State) (Zip Code)

\_\_\_\_\_  
(Owner's Name - Please Print)  
\_\_\_\_\_  
(Owner's Mailing Address)

\_\_\_\_\_  
(Owner's Signature)  
\_\_\_\_\_  
(City) (State) (Zip Code)

(Continued on page 2)

ENTERED  
SEP 16 2014  
BY: *[Signature]*

NWV  
9/23/2014  
*[Signature]*



(Owner's Name - Please Print)	(Owner's Signature)		
(Owner's Mailing Address)	(City)	(State)	(Zip Code)
-----			
(Owner's Name - Please Print)	(Owner's Signature)		
(Owner's Mailing Address)	(City)	(State)	(Zip Code)
-----			
(Owner's Name - Please Print)	(Owner's Signature)		
(Owner's Mailing Address)	(City)	(State)	(Zip Code)
-----			
(Owner's Name - Please Print)	(Owner's Signature)		
(Owner's Mailing Address)	(City)	(State)	(Zip Code)

18 U.S.C. 1001 and 43 U.S.C. 1212 make it a crime for any person knowingly and willfully to make to any department or agency of the United States any false, fictitious or fraudulent statements or representations as to any matter within its jurisdiction.

**INSTRUCTIONS**

1. This certification is made under the provisions of 43 U.S.C. § 1744 and 30 U.S.C. §28-28k and the regulations thereunder (43 CFR Part 3830).
2. The claimant(s) must fill in the dates in paragraph 1 for the beginning and ending of the assessment year for which this waiver is sought.
3. The claimant(s) must fill in the date in paragraph 2 for the beginning of the assessment year for which this waiver is sought.
4. All claim and site names and BLM serial numbers must be listed for the mining claims, mill sites, and tunnel sites for which the waiver is sought.
5. All owners of the mining claims, mill sites, and tunnel sites and their addresses must be given.
6. This waiver form must be signed by all the claimants or their designated agent, in original form. If an agent is designated, a notarized designation of agent, signed by all of the claimants with proper address given, must be submitted with this waiver.
7. This form must be filed no later than September 1st for the upcoming assessment year in the BLM State Office where the mining claims or sites are recorded, or the waiver cannot be granted by the BLM. (Example: To obtain a waiver for the assessment year 2012, which begins on September 1, 2011, you must qualify for and file for a waiver no later than September 1, 2011, in the proper BLM State Office.)
8. For all mining claims which require assessment work, you must record an affidavit of labor on or before the December 30th immediately following the filing of this waiver. For all other mining claims or sites waived, you must record a notice of intent to hold on or before the December 30th immediately following the filing of this waiver.
9. Mill and tunnel sites may also be listed on this waiver and be waived from payment of the maintenance fee. A notice of intent to hold for these sites is required to be filed by the December 30th following the filing of this waiver.

**FOR OFFICIAL USE ONLY**

393518  
395865

When Recorded Return Document to:  
Shirley OR Donald Wildes (S.R.)  
PO Box 1146  
ORKEECHOBEE FLORIDA  
34973

Check here if this is a change of address.  
Telephone: (863) 763-4400  
E-mail address: \_\_\_\_\_

**AFFIDAVIT OF PERFORMANCE OF ANNUAL WORK**

1. State of Arizona, County of YAVAPAI ss:  
2. I (Name) Shirley A Wildes  
3. Reside at (Address) 14145 N. E. 26<sup>th</sup> Ave  
(P.O. Box 1146) mailing address  
City Orkeechobee County Orkeechobee  
State FL Zip 34973

RECEIVED  
BLM AZ STATE OFFICE  
2014 SEP - 2 P 3:41  
PHOENIX, ARIZONA  
BLM  
Date  
Stamp

being duly sworn, depose and say that I am a citizen of the United States, more than eighteen years of age, and that all of the facts set forth in this affidavit, subject to the provisions and penalties of 18 U.S.C. 1001 pertaining to the filing of false, fictitious, or fraudulent statements with the United States, are true and correct according to the best of my knowledge, information and belief.

4. Owner's name and address (if not shown in items 1-3 above), \_\_\_\_\_

5. That I am personally acquainted with the mining claim(s). The work and improvements were made by and at the expense of the owner(s) of said claim(s). Said contiguous group of claims, listed on this document, are situated in the \_\_\_\_\_ (optional) Mining District; \_\_\_\_\_ County, Arizona.

Line No.	AMC NUMBER	CLAIM/SITE NAME	COUNTY RECORDER DATA (if available)	TWP	RNG	SEC
1	393518	Bonnie Gulch Gold		13N	1W	22SW
2	395865	New England Gold		13N	2W	NE 1/4 of the NW Sect. 21
3						
4						
5						
6						

ENTERED  
SEP 09 2014  
BY: RAW

**AFFIDAVIT OF PERFORMANCE OF ANNUAL WORK – page 2**

BLM  
Date  
Stamp

7						
8						
9						
10						

6. That between the dates starting at 12 o'clock noon on September 1, 20 13 and ending at 12 o'clock noon on September 1, 20 14 at least \$ 200.00 dollars worth of work and improvements were done and performed upon said claim(s) or upon one or more of a contiguous group of claims for the benefit of all, wholly or partly outside of a contiguous group of claims for the benefit of all, not including the location work.

7. That the following persons were employed to perform the work and improvements described herein: Shirley and Donald Wildes SR. performed maintenance

8. That the work and improvements performed were: worked all day at claims 7/7/014 MONY  
working material dirt and metal detecting. Picked up garbage. Picked up and removed limbs. Found specks of gold. 7/8/014  
2 day

9. Dated: 8/24/014 Signature: Shirley A. Wildes

SUBSCRIBED AND SWORN TO before me, a Notary Public, this 26 day of Aug. 20 14

By: Shirley A. Wildes

Notary Public Peggy L. Simmons

My Commission Expires 10-31-2014



PEGGY L. SIMMONS  
Notary Public, State of Florida  
My Comm. Expires Oct. 31, 2015  
Commission No. EE 124799

Bureau of Land Management  
Arizona State Office  
[www.az.blm.gov](http://www.az.blm.gov)

No. of Claims: 2 x \$10 = \$20.00  
 Check No.: 3117 Init. ASL  
 Receipt No.: 3121775  
 For BLM Use Only

Form: MCF108  
Revised Jan. 2006  
Page 2 of 2



UNITED STATES 1692  
DEPARTMENT OF THE INTERIOR  
BUREAU OF LAND MANAGEMENT  
**MAINTENANCE FEE WAIVER CERTIFICATION**

FORM APPROVED  
OMB NO. 1004-0114  
Expires: August 31, 2013

SEE INSTRUCTIONS ON PAGE 2

1. This small miner waiver is filed for the assessment year beginning on September ~~2013~~ <sup>2014</sup> and ending on September ~~2014~~ <sup>2015</sup>.
2. The undersigned and all related parties owned ten or fewer mining claims, mill, or tunnel sites located and maintained on Federal lands in the United States of America on September 1, ~~2014~~ <sup>2014</sup>.
3. The undersigned have performed the assessment work required by law for each mining claim listed prior to filing this waiver and understand that by filing this form, the undersigned must file an affidavit of assessment work with the Bureau of Land Management (BLM) by the December 30th following the filing of this waiver.
4. The undersigned understand that if the assessment work obligation has not yet come due under 30 U.S.C. 28 (for those claims in their first assessment year only), a notice of intent to hold reciting this condition must be recorded by the December 30th following the filing of this waiver.
5. The undersigned understand that mill and tunnel sites may also be listed on this waiver and be waived from payment of the maintenance fee, and that a notice of intent to hold for these sites is required to be filed with the BLM by the December 30th following the filing of this waiver.
6. The undersigned understand and acknowledge that pursuant to 43 U.S.C. 1212 and 18 U.S.C. 1001, the filing or recording of a false, fictitious, or fraudulent document with the BLM may result in a fine of up to \$250,000, a prison term not to exceed five years, or both.
7. The mining claims, mill or tunnel sites for which this waiver from payment of the maintenance fees is requested are:

CLAIM OR SITE NAME	BLM RECORDATION SERIAL NUMBER
1. Magic Gold #5	✓ ADULT # 389922
2.	
3.	
4.	
5.	
6.	
7.	
8.	
9.	
10.	

BLM RECEIVED  
 AZ STATE OFFICE  
 PHOENIX, ARIZONA  
 2014 SEP -2 P 3:40

The owner(s) (claimants) of the above mining claims and sites are:

Shirley A. Wildes  
(Owner's Name - Please Print)  
P.O. Box 1146  
(Owner's Mailing Address)

Shirley A. Wildes  
(Owner's Signature)  
Okechobee, FL 34973  
(City) (State) (Zip Code)

Donald W Wildes  
(Owner's Name - Please Print)  
P.O. Box 1146  
(Owner's Mailing Address)

Donald W Wildes (Sr.)  
(Owner's Signature)  
Okechobee FL 34973  
(City) (State) (Zip Code)

\_\_\_\_\_  
(Owner's Name - Please Print)  
\_\_\_\_\_  
(Owner's Mailing Address)

\_\_\_\_\_  
(Owner's Signature)  
\_\_\_\_\_  
(City) (State) (Zip Code)

\_\_\_\_\_  
(Owner's Name - Please Print)  
\_\_\_\_\_  
(Owner's Mailing Address)

\_\_\_\_\_  
(Owner's Signature)  
\_\_\_\_\_  
(City) (State) (Zip Code)

(Continued on page 2)

INTERESTED  
 SEP 16 2014  
 BY: fm

NW ✓  
 9/23/2014  
 RW

_____ (Owner's Name - Please Print)	_____ (Owner's Signature)		
_____ (Owner's Mailing Address)	_____ (City)	_____ (State)	_____ (Zip Code)
-----			
_____ (Owner's Name - Please Print)	_____ (Owner's Signature)		
_____ (Owner's Mailing Address)	_____ (City)	_____ (State)	_____ (Zip Code)
-----			
_____ (Owner's Name - Please Print)	_____ (Owner's Signature)		
_____ (Owner's Mailing Address)	_____ (City)	_____ (State)	_____ (Zip Code)
-----			
_____ (Owner's Name - Please Print)	_____ (Owner's Signature)		
_____ (Owner's Mailing Address)	_____ (City)	_____ (State)	_____ (Zip Code)

18 U.S.C. 1001 and 43 U.S.C. 1212 make it a crime for any person knowingly and willfully to make to any department or agency of the United States any false, fictitious or fraudulent statements or representations as to any matter within its jurisdiction.

**INSTRUCTIONS**

1. This certification is made under the provisions of 43 U.S.C. § 1744 and 30 U.S.C. §28-28k and the regulations thereunder (43 CFR Part 3830).
2. The claimant(s) must fill in the dates in paragraph 1 for the beginning and ending of the assessment year for which this waiver is sought.
3. The claimant(s) must fill in the date in paragraph 2 for the beginning of the assessment year for which this waiver is sought.
4. All claim and site names and BLM serial numbers must be listed for the mining claims, mill sites, and tunnel sites for which the waiver is sought.
5. All owners of the mining claims, mill sites, and tunnel sites and their addresses must be given.
6. This waiver form must be signed by all the claimants or their designated agent, in original form. If an agent is designated, a notarized designation of agent, signed by all of the claimants with proper address given, must be submitted with this waiver.
7. This form must be filed no later than September 1st for the upcoming assessment year in the BLM State Office where the mining claims or sites are recorded, or the waiver cannot be granted by the BLM. (Example: To obtain a waiver for the assessment year 2012, which begins on September 1, 2011, you must qualify for and file for a waiver no later than September 1, 2011, in the proper BLM State Office.)
8. For all mining claims which require assessment work, you must record an affidavit of labor on or before the December 30th immediately following the filing of this waiver. For all other mining claims or sites waived, you must record a notice of intent to hold on or before the December 30th immediately following the filing of this waiver.
9. Mill and tunnel sites may also be listed on this waiver and be waived from payment of the maintenance fee. A notice of intent to hold for these sites is required to be filed by the December 30th following the filing of this waiver.

**FOR OFFICIAL USE ONLY**



389919

When Recorded/Return Document to:

Shirley & Donald Wildes (SR.)  
P.O. Box 1146  
OKEECHOBEE, FL.  
34973

Check here if this is a change of address.

Telephone: (863) 763-4400

E-mail address: \_\_\_\_\_

**AFFIDAVIT OF PERFORMANCE OF ANNUAL WORK**

1. State of Arizona, County of La Paz ss:  
2. I (Name) Shirley & Donald Wildes (SR)  
3. Reside at (Address) 14145 N.E. 26th Av.  
(P.O. Box 1146 mailing address)  
City OKEECHOBEE County OKEECHOBEE

RECEIVED  
BLM AZ STATE OFFICE  
2014 SEP - 2 P 3:40  
PHOENIX, ARIZONA  
BLM  
Date  
Stamp

State FL Zip 34973 being duly sworn, depose and say that I am a citizen of the United States, more than eighteen years of age, and that all of the facts set forth in this affidavit, subject to the provisions and penalties of 18 U.S.C. 1001 pertaining to the filing of false, fictitious, or fraudulent statements with the United States, are true and correct according to the best of my knowledge, information and belief.

4. Owner's name and address (if not shown in items 1-3 above). Shirley & Donald Wildes (SR)  
P.O. Box 1146 OKEECHOBEE, FL. 34973

5. That I am personally acquainted with the mining claim(s). The work and improvements were made by and at the expense of the owner(s) of said claim(s). Said contiguous group of claims, listed on this document, are situated in the \_\_\_\_\_ (optional) Mining District; La Paz County, Arizona.

Line No.	AMC NUMBER	CLAIM/SITE NAME	COUNTY RECORDER DATA (if available)	TWP	RNG	SEC
1	389922	Magic Gold #5		4N	12W	SE 1/4
2		Gila & Salt River Base & meridian				
3						
4						
5						
6						

section 4

Form: MCF108  
Revised Jan. 2006  
Page 1 of 2

ENTERED  
SEP 09 2014  
BY: RAM



**AFFIDAVIT OF PERFORMANCE OF ANNUAL WORK – page 2**

BLM  
Date  
Stamp

7						
8						
9						
10						

6. That between the dates starting at 12 o'clock noon on September 1, 20 13 and ending at 12 o'clock noon on September 1, 20 14 at least \$ 100.00 dollars worth of work and improvements were done and performed upon said claim(s) or upon one or more of a contiguous group of claims for the benefit of all, wholly or partly outside of a contiguous group of claims for the benefit of all, not including the location work.

7. That the following persons were employed to perform the work and improvements described herein: Donald and Shirley Wildes performed work 7-12-2014 Saturday all day.

8. That the work and improvements performed were: We metal detected done material, checked rock. Found some small geode rocks. Found a dead blame snake too.

9. Dated: 8/26/14 Signature: Shirley A. Wildes

SUBSCRIBED AND SWORN TO before me, a Notary Public, this 26 day of Aug 2014

By: Shirley A. Wildes

Notary Public Peggy L. Simmons

My Commission Expires 10-31-2015



PEGGY L. SIMMONS  
Notary Public, State of Florida  
My Comm. Expires Oct. 31, 2015  
Commission No. EE 124799

No. of Claims: 1 x \$10 = \$10.00  
 Check No.: 3117 Init. AW  
 Receipt No.: 3121775  
 For BLM Use Only

Bureau of Land Management  
Arizona State Office  
[www.blm.gov](http://www.blm.gov)

Form: MCF108  
Revised Jan. 2006  
Page 2 of 2

**United States Department of the Interior**  
**Bureau of Land Management**  
 LANDS/RECREATION & PLANNING  
 ONE N CENTRAL AVE  
 PHOENIX, AZ 85004 -2203  
 Phone: 602-417-9200



Receipt

No: 3121775

<b>Transaction #:</b> 3213631	
<b>Date of Transaction:</b> 09/03/2014	
<b>CUSTOMER:</b>	
	SHIRLEY WILDES PO BOX 1146 OKEECHOBEE, FL 34973-1146 US

LINE #	QTY	DESCRIPTION	REMARKS	UNIT PRICE	TOTAL
1	1.00	LOCATABLE MINERALS / MINING CLAIMS-NOT NEW-UNADJUD, ONE AUTH NO. ONLY / MINING CLAIM MONEY RECEIVED <b>CASES: AMC393518/\$30.00</b>	MAINT FEE WAIVER (3) 2015 / POL (3) 2014	- n/a -	30.00
2	1.00	LOCATABLE MINERALS / MINING CLAIMS-NOT NEW-UNADJUD, ONE AUTH NO. ONLY / MINING CLAIM MONEY RECEIVED <b>CASES: AMC393518/\$30.00</b>	AMENDMENTS - 3	- n/a -	30.00
<b>TOTAL:</b>					<b>\$60.00</b>

PAYMENT INFORMATION					
1	AMOUNT:	60.00	POSTMARKED:	08/19/2014	
	TYPE:	CHECK	RECEIVED:	09/02/2014	
	CHECK NO:	3117			
	NAME:	WILDES, SHIRLEY A PO BOX 1146 OKEECHOBEE FL 34973-1146 US			

REMARKS

This receipt was generated by the automated BLM Collections and Billing System and is a paper representation of a portion of the official electronic record contained therein.

Shirley A. Wildes  
Donald W. Wildes  
P.O. Box 1146  
Okeechobee, FL 34973-1146

RECEIVED  
BLM AZ STATE OFFICE  
2014 SEP -2 P 3:40  
PHOENIX, ARIZONA

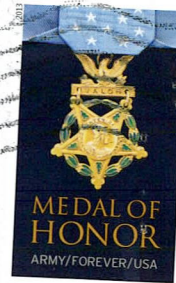
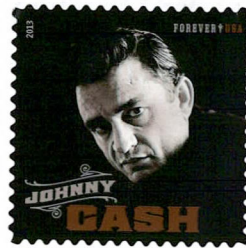

Attention  
Rod Eibert

Bureau of Land Management  
Arizona State Office  
One Central Avenue, Suite 800  
Phoenix, Arizona  
85004-4427

65004442700





Shirley A. Wildes  
Donald W. Wildes  
P.O. Box 1146  
Okeechobee, FL 34973-1146

RECEIVED  
BLM AZ STATE OFFICE

2014 SEP -2 P 3:40

PHOENIX, ARIZONA

Attention  
Rod Eibert

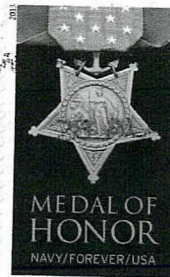

Bureau of Land Management  
Arizona State Office  
One Central Avenue, Suite 800  
Phoenix, Arizona  
85004-4427

85004442700

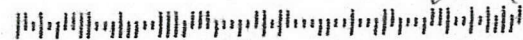



X126/2014

Amc 389919

393518

395865

Mr. Eibert,

Here are the amendments made to the following claims.

(1) Amc# 389922 - Magic Gold 5 in La Paz County - Az.

(2) Amc# 393518 - Bonnie Mulch Gold in Yavapai County - Az. AMENDMENTS FILED ON TOP OF EACH INDIVIDUAL CLAIM, ALL 3 WERE

APPROVED BY A-TROWER, PB

(3) Amc# 395865 - New England Gold in Yavapai County - Az. AC 635 (REDUCED ACREAGE) ENTERED SEP 30 2014 PB

Check # 3117 is for 3 claims amendments and 3 POL'S Please call me at (863) 763-4400 or my cell at (863) 447-0811 you can text me if you need to on my cell.

RECEIVED BLM AZ STATE OFFICE PHOENIX, ARIZONA SEP - 2 2014

Once again I do do thank you for all your assistance on my claims. The world needs more people like you that go out of their to help. I do the same thing myself. Take care & Blessed be. Shirleya Childs P.O. Box 0 Keechobee, Florida 34973

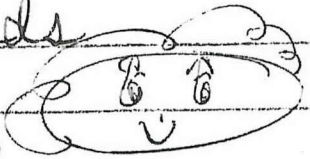

Shirley A. Wildes  
Donald W. Wildes  
P.O. Box 1146  
Okeechobee, FL 34973-1146

RECEIVED  
BLM ARIZONA STATE OFFICE

2014 SEP -2 P 3:40

PHOENIX, ARIZONA

ATTENTION  
Rod Eibert



Bureau of Land Management  
Arizona State Office  
One Central Avenue, Suite 800  
Phoenix, Arizona

85004-4427

65004442700

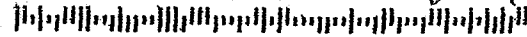



**United States Department of the Interior**  
**Bureau of Land Management**  
 LANDS/RECREATION & PLANNING  
 ONE N CENTRAL AVE  
 PHOENIX, AZ 85004 -2203  
 Phone: 602-417-9200

ENTERED  
 SEP 09 2014  
 Receipt  
 BY: *RAM*

No: 3121775

<b>Transaction #:</b> 3213631	
<b>Date of Transaction:</b> 09/03/2014	
<b>CUSTOMER:</b>	
SHIRLEY WILDES PO BOX 1146 OKEECHOBEE, FL 34973-1146 US	

LINE #	QTY	DESCRIPTION	REMARKS	UNIT PRICE	TOTAL
1	1.00	LOCATABLE MINERALS / MINING CLAIMS-NOT NEW-UNADJUD, ONE AUTH NO. ONLY / MINING CLAIM MONEY RECEIVED <b>CASES: AMC393518/\$30.00</b>	MAINT FEE WAIVER (3) 2015 / POL (3) 2014	- n/a -	30.00
2	1.00	LOCATABLE MINERALS / MINING CLAIMS-NOT NEW-UNADJUD, ONE AUTH NO. ONLY / MINING CLAIM MONEY RECEIVED <b>CASES: AMC393518/\$30.00</b>	AMENDMENTS - 3	- n/a -	30.00
<b>TOTAL:</b>					<b>\$60.00</b>

PAYMENT INFORMATION			
1	AMOUNT:	60.00	POSTMARKED: 08/19/2014
	TYPE:	CHECK	RECEIVED: 09/02/2014
	CHECK NO:	3117	
	NAME:	WILDES, SHIRLEY A PO BOX 1146 OKEECHOBEE FL 34973-1146 US	

REMARKS

This receipt was generated by the automated BLM Collections and Billing System and is a paper representation of a portion of the official electronic record contained therein.

UNITED STATES  
DEPARTMENT OF THE INTERIOR  
BUREAU OF LAND MANAGEMENT  
**MAINTENANCE FEE WAIVER CERTIFICATION**

*[Handwritten initials]*

FORM APPROVED  
OMB NO. 1004-0114  
Expires: August 31, 2013

528

SEE INSTRUCTIONS ON PAGE 2

393518

395865

1. This small miner waiver is filed for the assessment year beginning on September 1, 2011 and ending on September 1, 2012.
2. The undersigned and all related parties owned ten or fewer mining claims, mill, or tunnel sites located and maintained on Federal lands in the United States of America on September 1, \_\_\_\_\_.
3. The undersigned have performed the assessment work required by law for each mining claim listed prior to filing this waiver and understand that by filing this form, the undersigned must file an affidavit of assessment work with the Bureau of Land Management (BLM) by the December 30th following the filing of this waiver.
4. The undersigned understand that if the assessment work obligation has not yet come due under 30 U.S.C. 28 (for those claims in their first assessment year only), a notice of intent to hold reciting this condition must be recorded by the December 30th following the filing of this waiver.
5. The undersigned understand that mill and tunnel sites may also be listed on this waiver and be waived from payment of the maintenance fee, and that a notice of intent to hold for these sites is required to be filed with the BLM by the December 30th following the filing of this waiver.
6. The undersigned understand and acknowledge that pursuant to 43 U.S.C. 1212 and 18 U.S.C. 1001, the filing or recording of a false, fictitious, or fraudulent document with the BLM may result in a fine of up to \$250,000, a prison term not to exceed five years, or both.
7. The mining claims, mill or tunnel sites for which this waiver from payment of the maintenance fees is requested are:

CLAIM OR SITE NAME	BLM RECORDATION SERIAL NUMBER
1. <u>Bannie Gulch Gold</u>	✓ <u>AMC# 393518</u>
2. <u>New England Gold</u>	<u>AMC# 395865</u>
3.	
4.	
5.	
6.	
7.	
8.	
9.	
10.	

The owner(s) (claimants) of the above mining claims and sites are:

Shirley A. Wildes  
(Owner's Name - Please Print)  
P.O. Box 1146  
(Owner's Mailing Address)

Shirley A. Wildes  
(Owner's Signature)  
Okeechobee FL 3973  
(City) (State) (Zip Code)

Donald W. Wildes  
(Owner's Name - Please Print)  
P.O. Box 1146  
(Owner's Mailing Address)

Donald W. Wildes  
(Owner's Signature)  
Okeechobee FL 3973  
(City) (State) (Zip Code)

\_\_\_\_\_  
(Owner's Name - Please Print)  
\_\_\_\_\_  
(Owner's Mailing Address)

\_\_\_\_\_  
(Owner's Signature)  
\_\_\_\_\_  
(City) (State) (Zip Code)

\_\_\_\_\_  
(Owner's Name - Please Print)  
\_\_\_\_\_  
(Owner's Mailing Address)

\_\_\_\_\_  
(Owner's Signature)  
\_\_\_\_\_  
(City) (State) (Zip Code)

(Continued on page 2)

NL  
RE

ENTERED IN COMPU  
R2 9-18-12

RECEIVED  
PHOENIX ARIZONA  
AUG 27 2012  
P 4: 28  
BLM AZ STATE OFFICE

(Owner's Name - Please Print)	(Owner's Signature)		
(Owner's Mailing Address)	(City)	(State)	(Zip Code)
(Owner's Name - Please Print)	(Owner's Signature)		
(Owner's Mailing Address)	(City)	(State)	(Zip Code)
(Owner's Name - Please Print)	(Owner's Signature)		
(Owner's Mailing Address)	(City)	(State)	(Zip Code)
(Owner's Name - Please Print)	(Owner's Signature)		
(Owner's Mailing Address)	(City)	(State)	(Zip Code)

18 U.S.C. 1001 and 43 U.S.C. 1212 make it a crime for any person knowingly and willfully to make to any department or agency of the United States any false, fictitious or fraudulent statements or representations as to any matter within its jurisdiction.

**INSTRUCTIONS**

1. This certification is made under the provisions of 43 U.S.C. § 1744 and 30 U.S.C. §28-28k and the regulations thereunder (43 CFR Part 3830).
2. The claimant(s) must fill in the dates in paragraph 1 for the beginning and ending of the assessment year for which this waiver is sought.
3. The claimant(s) must fill in the date in paragraph 2 for the beginning of the assessment year for which this waiver is sought.
4. All claim and site names and BLM serial numbers must be listed for the mining claims, mill sites, and tunnel sites for which the waiver is sought.
5. All owners of the mining claims, mill sites, and tunnel sites and their addresses must be given.
6. This waiver form must be signed by all the claimants or their designated agent, in original form. If an agent is designated, a notarized designation of agent, signed by all of the claimants with proper address given, must be submitted with this waiver.
7. This form must be filed no later than September 1st for the upcoming assessment year in the BLM State Office where the mining claims or sites are recorded, or the waiver cannot be granted by the BLM. (Example: To obtain a waiver for the assessment year 2012, which begins on September 1, 2011, you must qualify for and file for a waiver no later than September 1, 2011, in the proper BLM State Office.)
8. For all mining claims which require assessment work, you must record an affidavit of labor on or before the December 30th immediately following the filing of this waiver. For all other mining claims or sites waived, you must record a notice of intent to hold on or before the December 30th immediately following the filing of this waiver.
9. Mill and tunnel sites may also be listed on this waiver and be waived from payment of the maintenance fee. A notice of intent to hold for these sites is required to be filed by the December 30th following the filing of this waiver.

**FOR OFFICIAL USE ONLY**

RECEIVED  
BLM ARIZONA STATE OFFICE  
PHOENIX, ARIZONA  
AUG 27 P 4: 28



When Recorded Return Document to:

Shirley A. Wildes  
P.O. Box 1146  
Okeechobee, Florida  
34973-1146

Check here if this is a change of address.

Telephone: (863) 447-0801

E-mail address: \_\_\_\_\_

**AFFIDAVIT OF PERFORMANCE OF ANNUAL WORK**

1. State of Arizona, County of Yavapai ss:

2. I (Name) Shirley A. Wildes

3. Reside at (Address) (14445 N.E. 26<sup>th</sup> Ave.)

(Physical address)

City Okeechobee County Okeechobee

State FL Zip 34972

being duly sworn, depose and say that I am a citizen of the United States, more than eighteen years of age, and that all of the facts set forth in this affidavit, subject to the provisions and penalties of 18 U.S.C. 1001 pertaining to the filing of false, fictitious, or fraudulent statements with the United States, are true and correct according to the best of my knowledge, information and belief.

4. Owner's name and address (if not shown in items 1-3 above). Shirley A. Wildes

P.O. Box 1146 - Okeechobee, FL 34973-1146

5. That I am personally acquainted with the mining claim(s). The work and improvements were made by and at the expense of the owner(s) of said claim(s). Said contiguous group of claims, listed on this document, are situated in the

(optional) Mining District: Yavapai County, Arizona.

RECEIVED  
BLM AZ STATE OFFICE  
2012 AUG 27 P 4: 28  
PHOENIX, ARIZONA  
BLM  
Date  
Stamp

Line No.	AMC NUMBER	CLAIM/SITE NAME	COUNTY RECORDER DATA (if available)	TWP	RNG	SEC
1	393518	Bannie Gulch Gold	B:4838 P:51	13N	1W	22SW
2	395865	New England Gold	B:4838 P:51	13N	2W	NE 1/2 of the NW Sect. 21
3			(10/6/04)			
4						
5						
6						

Form: MCF108  
Revised Jan. 2006  
Page 1 of 2

ENTERED IN COMPUTER  
R2 9-18-12

AFFIDAVIT OF PERFORMANCE OF ANNUAL WORK – page 2

RECEIVED  
BLM AZ STATE OFFICE  
2012 AUG 27 P 4: 28  
PHOENIX, ARIZONA

BLM  
Date  
Stamp

7					
8					
9					
10					

6. That between the dates starting at 12 o'clock noon on September 1, 20 11 and ending at 12 o'clock noon on September 1, 20 12 at least \$ 200.00 dollars worth of work and improvements were done and performed upon said claim(s) or upon one or more of a contiguous group of claims for the benefit of all, wholly or partly outside of a contiguous group of claims for the benefit of all, not including the location work.

7. That the following persons were employed to perform the work and improvements described herein:

Shirley & Donald Wildes did work AMC 365 work done 8-12-012

8. That the work and improvements performed were 1. WORK DONE 8-10-013 (AMC 393518) (392) We performed work at claims. Metal detected, Picked up removed limbs from path, put up ~~AW~~ signs. Other ones were shot. Picked up garbage etc.

9. Dated: 7-20-012 Signature: Shirley A. Wildes

SUBSCRIBED AND SWORN TO before me, a Notary Public, this 20<sup>th</sup> day of July 20 12

By: Peggy L. Simmons Shirley A. Wildes

Notary Public Peggy L. Simmons

My Commission Expires 10-31-15



PEGGY L. SIMMONS  
Notary Public, State of Florida  
My Comm. Expires Oct. 31, 2015  
Commission No. EE 124799

Bureau of Land Management  
Arizona State Office  
[www.az.blm.gov](http://www.az.blm.gov)

No. of Claims: 2 x \$10 = (200.00)  
 Check No.: 2773 Init. A.S.I.  
 Receipt No.: 2643162  
 For BLM Use Only

Shirley A. Wildes  
P.O. Box 1146  
Okechobee, FL  
34973

Attention  
(Rod Eibert)

RECEIVED  
BLM AZ STATE OFFICE

2012 AUG 27 P 4: 28

PHOENIX, ARIZONA

BLM of Arizona  
One North Central Ave.  
Suite 800  
Phoenix, Arizona

8500484427

85004-1427





Shirley A. Wilder  
P.O. Box 1146  
Okechobee, FL  
34973

Attention  
(Rod Eibert)

RECEIVED  
BLM AZ STATE OFFICE

2012 AUG 27 P 4: 28

PHOENIX, ARIZONA

BLM of Arizona  
One North Central Ave.  
Suite 800  
Phoenix, Arizona

8500494427

8500494427

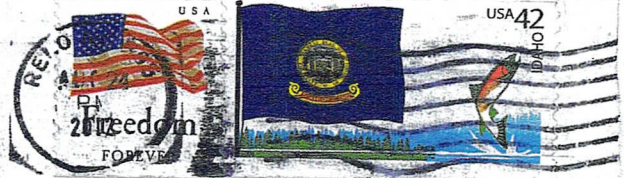

**United States Department of the Interior**  
**Bureau of Land Management**  
 LANDS/RECREATION & PLANNING  
 ONE N CENTRAL AVE  
 PHOENIX, AZ 85004 -2203  
 Phone: 602-417-9200

Receipt

No: 2643162

<b>Transaction #:</b> 2723862	
<b>Date of Transaction:</b> 08/28/2012	
CUSTOMER:	
SHIRLEY WILDES PO BOX 1146 OKEECHOBEE, FL 34973-1146 US	

LINE #	QTY	DESCRIPTION	REMARKS	UNIT PRICE	TOTAL
1	1.00	LOCATABLE MINERALS / MINING CLAIMS- NOT NEW-UNADJUD, ONE AUTH NO. ONLY / MINING CLAIM MONEY RECEIVED <b>CASES: AMC393518/\$20.00</b>	MAINT FEE WAIVER (2) 2013 / POL (2) 2012	- n/a -	20.00
<b>TOTAL:</b>					<b>\$20.00</b>

PAYMENT INFORMATION			
1	AMOUNT:	20.00	POSTMARKED: N/A
	TYPE:	CHECK	RECEIVED: 08/27/2012
	CHECK NO:	2793	
	NAME:	WILDES, SHIRLEY PO BOX 1146 OKEECHOBEE FL 34973-1146 US	

REMARKS

This receipt was generated by the automated BLM Collections and Billing System and is a paper representation of a portion of the official electronic record contained therein.



411

UNITED STATES  
DEPARTMENT OF THE INTERIOR  
BUREAU OF LAND MANAGEMENT

MAINTENANCE FEE WAIVER CERTIFICATION

30 A.D.

AMC 395865  
FORM APPROVED  
OMB NO. 1004-0114  
Expires: August 31, 2013  
AMC 393518  
AMC 390947

SEE INSTRUCTIONS ON PAGE 2

1. This small miner waiver is filed for the assessment year beginning on September 1, 2011 and ending on September 1, 2012.
2. The undersigned and all related parties owned ten or fewer mining claims, mill, or tunnel sites located and maintained on Federal lands in the United States of America on September 1, 2011.
3. The undersigned have performed the assessment work required by law for each mining claim listed prior to filing this waiver and understand that filing this form, an affidavit of assessment work must be recorded by the December 30th following the filing of this waiver.
4. The undersigned understand that if the assessment work obligation has not yet come due under 30 U.S.C. 28 (for those claims in their first assessment year only), a notice of intent to hold reciting this condition must be recorded by the December 30th following the filing of this waiver.
5. The undersigned understand that mill and tunnel sites may also be listed upon this waiver and be waived from payment of the maintenance fee, ar that a notice of intent to hold for these sites is required to be recorded by the December 30th immediately following the filing of this waiver.
6. The undersigned understand and acknowledge that pursuant to 43 U.S.C. 1212 and 18 U.S.C. 1001, the filing or recording of a false, fictitious, or fraudulent document with the Bureau of Land Management may result in a fine of up to \$250,000, a prison term not to exceed five years, or both.
7. The mining claims, mill or tunnel sites for which this waiver from payment of the maintenance fees is requested are:

CLAIM OR SITE NAME	BLM RECORDATION SERIAL NUMBER
1. Quartz Gold #2	✓ AMC# 390949 Yavapai county
2. Bannix Gulch Gold	AMC# 393518 Yavapai county
3. New England Gold	AMC# 395865 Yavapai county
4.	
5.	
6.	
7.	
8.	
9.	
10.	

RECEIVED  
BLM AZ STATE OFFICE  
2011 AUG 21 A 8 04  
PHOENIX, ARIZONA

The owner(s) (claimants) of the above mining claims and sites are:

Shirley Wildes  
(Owner's Name - Please Print)  
P.O. Box 1146  
(Street or P.O. Box)  
Okeechobee FL 34973  
(City) (State) (Zip Code)

Shirley Wildes  
(Owner's Signature)

Ronald Wildes  
(Owner's Name - Please Print)  
P.O. Box 1146  
(Street or P.O. Box)  
Okeechobee FL 34973  
(City) (State) (Zip Code)

Ronald Wildes  
(Owner's Signature)

(Owner's Name - Please Print)  
(Street or P.O. Box)  
(City) (State) (Zip Code)

(Owner's Signature)

ENTERED IN COMPUTER  
RS 8-30-11



(Owner's Name - Please Print)

(Owner's Signature)

(Street or P.O. Box)

(City)

(State)

(Zip Code)

(Owner's Name - Please Print)

(Owner's Signature)

(Street or P.O. Box)

(City)

(State)

(Zip Code)

(Owner's Name - Please Print)

(Owner's Signature)

(Street or P.O. Box)

(City)

(State)

(Zip Code)

(Owner's Name - Please Print)

(Owner's Signature)

(Street or P.O. Box)

(City)

(State)

(Zip Code)

Title 18 U.S.C. Section 1001 and Title 43 U.S.C. Section 1212 makes it a crime for any person knowingly and willfully to make to any department or agency of the United States any false, fictitious or fraudulent statements or representations as to any matter within its jurisdiction.

INSTRUCTIONS

1. This certification is made under the provisions of §1744 of Title 43 and § 28-28k of Title 30 of the United States Code; and the regulations thereunder (CFR Part 3830).
2. The claimant(s) must fill in the dates in paragraph 1 for the beginning and ending of the assessment year for which this waiver is sought.
3. The claimant(s) must fill in the date in paragraph 2 for the beginning of the assessment year for which this waiver is sought.
4. All claim and site names and Bureau of Land Management (BLM) serial numbers must be listed for the mining claims, mill sites, and tunnel sites for which the waiver is sought.
5. All owners of the mining claims, mill sites, and tunnel sites and their addresses must be given.
6. This waiver form must be signed by all the claimants or their designated agent, in original form. If an agent is designated, a notarized designation of agent, signed by all of the claimants with proper address given, must be submitted with this waiver.
7. This form must be filed no later than September 1st for the upcoming assessment year in the BLM State Office where the mining claims or sites are recorded, or the waiver cannot be granted by the BLM. (Example: To obtain a waiver for the assessment year 2012, which begins on September 1, 2011, you must qualify for and file for a waiver no later than September 1, 2011, in the proper BLM State Office.)
8. For all mining claims which require assessment work, you must record an affidavit of labor on or before the December 30th immediately following the filing of this waiver. For all other mining claims or sites waived, you must record a notice of intent to hold on or before the December 30th immediately following the filing of this waiver.
9. Mill and tunnel sites may also be listed upon this waiver and be waived from payment of the maintenance fee. A notice of intent to hold for these sites is required to be filed by the December 30th following the filing of this waiver.

RECEIVED  
BLM AZ STATE OFFICE  
2011 AUG 24 A 8:00  
PHOENIX, ARIZONA

FOR OFFICIAL USE ONLY

When Recorded Return Document to:

Shirley A. Wildes  
PO Box 1146  
Okeechobee, FL  
34973

Check here if this is a change of address.

Telephone (863) 447-0801 or (863) 763-4400

E-mail address: \_\_\_\_\_

AFFIDAVIT OF PERFORMANCE OF ANNUAL WORK

RECEIVED  
BLM AZ STATE OFFICE  
2011 AUG 24 A 8:04  
PHOENIX, ARIZONA  
BLM  
Date  
Stamp

1. State of Arizona, County of Yavapai ss:

2. I (Name) Shirley A. Wildes

3. Reside at (Address) 14145 N.E. 26th Ave.

Okeechobee, FL 34972

City Okeechobee County Okeechobee

State FL Zip 34972

being duly sworn, depose and say that I am a citizen of the United States, more than eighteen years of age, and that all of the facts set forth in this affidavit, subject to the provisions and penalties of 18 U.S.C. 1001 pertaining to the filing of false, fictitious, or fraudulent statements with the United States, are true and correct according to the best of my knowledge, information and belief.

4. Owner's name and address (if not shown in items 1-3 above). Shirley A. Wildes

(mailing correspondence) P.O. Box 1146 - Okeechobee, FL 34973

5. That I am personally acquainted with the mining claim(s). The work and improvements were made by and at the expense of the owner(s) of said claim(s). Said contiguous group of claims, listed on this document, are situated in the

(optional) Mining District: Yavapai County, Arizona.

County  
(Yavapai)  
(Yavapai)  
(Yavapai)

Line No.	AMC NUMBER	CLAIM/SITE NAME	COUNTY RECORDER DATA (if available)	TWP	RNG	SEC
1	390949	Quartz Gold #2	BOOK 4764 PG 788 9/16/10	13N	1W	10NW
2	393518	Bonnie Gulch Gold	" " "	13N	1W	22SW
3	395865	New England Gold	" " "	13N	2W	NE 1/4 of the NW of Sec. 21
4						
5						
6						

RE 8-30-11

RECEIVED  
BLM AZ STATE OFFICE  
2011 AUG 24 A 8:04  
PHOENIX, ARIZONA  
BLM  
Date  
Stamp

7					
8					
9					
10					

6. That between the dates starting at 12 o'clock noon on September 1, 20 10 and ending at 12 o'clock noon on September 1, 20 11 at least \$ 350.00 <sup>total (3) claims</sup> dollars worth of work and improvements were done and performed upon said claim(s) or upon one or more of a contiguous group of claims for the benefit of all, wholly or partly outside of a contiguous group of claims for the benefit of all, not including the location work.

7. That the following persons were employed to perform the work and improvements described herein: \_\_\_\_\_

Shirley Wildes and Donald Wildes (SP.)

8. That the work and improvements performed were: (AMC 390944 on 7-20-01) (AMC 393518 on 7-21-01)

(AMC 395865 on 7-19-01) did maintenances on (3) claims Removal of trash, cleared paths to claims, metal detected all, tub panned material.

9. Dated: 8-19-11 Signature: Shirley A. Wildes

SUBSCRIBED AND SWORN TO before me, a Notary Public, this 19<sup>th</sup> day of Aug. 20 11

By: Shirley A. Wildes

Notary Public Peggy L. Simmons

My Commission Expires 10-31-11

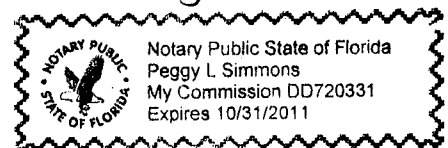

Bureau of Land Management  
Arizona State Office  
[www.az.blm.gov](http://www.az.blm.gov)

No. of Claims: 3 x \$10 = 30.00  
Check No.: 21693 Init. D.W.  
Receipt No.: 2413876  
For BLM Use Only



8-19-2011

To the BLM of Arizona,  
Please RETURN All original papers after  
filing so I can have all of the claims  
Recorded in the County Recorders office.  
Thank you so much for your help.

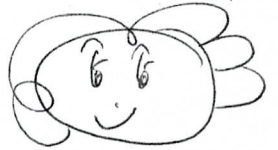

Sincerely,  
Shirley A. Wildes  
P.O. Box 1146  
Okeechobee, FL.  
34973

Claim OR claims

AMC # 390949  
Quartz Gold #2

AMC # 393518  
Bannie Gulch Gold

AMC # 395865  
New England Gold

Phones

(863) 447-0801

(863) 763-4400

PHOENIX, ARIZONA

2011 AUG 24 A 8:04

RECEIVED  
BLM AZ STATE OFFICE

**United States Department of the Interior**  
**Bureau of Land Management**  
 LANDS/RECREATION & PLANNING  
 ONE N CENTRAL AVE  
 PHOENIX, AZ 85004 -2203  
 Phone: 602-417-9200

Receipt

No: 2413876

<b>Transaction #:</b> 2489229	
<b>Date of Transaction:</b> 08/24/2011	
CUSTOMER:	
DONALD WILDES ETAL PO BOX 1146 OKEECHOBEE,FL 34973-1146 US	

LINE #	QTY	DESCRIPTION	REMARKS	UNIT PRICE	TOTAL
1	1.00	LOCATABLE MINERALS / MINING CLAIMS- NOT NEW-UNADJUD, ONE AUTH NO. ONLY / MINING CLAIM MONEY RECEIVED CASES: AMC390949/\$30.00	MAINT WAIVER (3) 2012 / POL (3) 2011	- n/a -	30.00
<b>TOTAL:</b>					<b>\$30.00</b>

PAYMENT INFORMATION					
1	AMOUNT:	30.00	POSTMARKED:	08/20/2011	
	TYPE:	CHECK	RECEIVED:	08/24/2011	
	CHECK NO:	2693			
	NAME:	WILDES, SHIRLEY A PO BOX 1146 OKEECHOBEE FL 34973-1146 US			

REMARKS

This receipt was generated by the automated BLM Collections and Billing System and is a paper representation of a portion of the official electronic record contained therein.

UNITED STATES DEPARTMENT OF THE INTERIOR  
BUREAU OF LAND MANAGEMENT

383

AMC 395865  
AMC 393518

AMC 389919  
AMC 395649

FORM APPROVED  
OMB NO. 1004-0114  
Expires: February 28, 2010

**MAINTENANCE FEE WAIVER CERTIFICATION**

SEE INSTRUCTIONS ON REVERSE

AMC 390947

1. This small miner waiver is filed for the assessment year beginning at noon on September 1, 2010 and ending at noon on September 1, 2011.
2. The undersigned and all related parties owned ten or fewer mining claims, mill, or tunnel sites located and maintained on Federal lands in the United States of America on September 1, 2010.
3. The undersigned have performed the assessment work required by law for each mining claim listed prior to filing this waiver and understand that by filing this form; an affidavit of assessment work must be recorded by the December 30th following the filing of this waiver.
4. The undersigned understand that if the assessment work obligation has not yet come due under 30 U.S.C. 28 (for those claims in their first assessment year only); a notice of intent to hold reciting this condition must be recorded by the December 30th following the filing of this waiver.
5. The undersigned understand that mill and tunnel sites may also be listed upon this waiver and be waived from payment of the maintenance fee; and that a notice of intent to hold for these sites is required to be recorded by the December 30th immediately following the filing of this waiver.
6. The undersigned understand and acknowledge that pursuant to 43 U.S.C. 1212 and 18 U.S.C. 1001; the filing or recording of a false, fictitious, or fraudulent document with the Bureau of Land Management may result in a fine of up to \$250,000, a prison term not to exceed five years, or both.
7. The mining claims, mill or tunnel sites for which this waiver from payment of the maintenance fees is requested are:

CLAIM OR SITE NAME	BLM RECORDATION SERIAL NUMBER
1. Quartz Gold #2 (B-4600-P239)	✓ AMC# 390949 YAVAPAI
2. Bannie Gulch Gold (B4611-P510)	AMC# 393518 YAVAPAI
3. New England Gold (B4656-P537)	AMC# 395865 YAVAPAI
4.	
5.	
6.	
7.	
8.	
9.	
10.	

The owner(s) (claimants) of the above mining claims and sites are:

Shirley Wildes  
(Owner's Name - Please Print)  
P.O. Box 1146  
(Street or P.O. Box)  
Okeechobee FL 34973-1146  
(City) (State) (Zip Code)

*Shirley Wildes*  
(Owner's Signature)

Donald Wildes  
(Owner's Name - Please Print)  
P.O. Box 1146  
(Street or P.O. Box)  
Okeechobee FL 34973-1146  
(City) (State) (Zip Code)

*Donald Wildes*  
(Owner's Signature)

RECEIVED  
BLM AZ STATE OFFICE  
2010 AUG 24 A 8:29  
HOENIX, ARIZONA

\_\_\_\_\_  
(Owner's Name - Please Print)  
\_\_\_\_\_  
(Street or P.O. Box)  
\_\_\_\_\_  
(City) (State) (Zip Code)

\_\_\_\_\_  
(Owner's Signature)

(Continued on page 2)

RE 9/13/2010



When Recorded Return Document to:

Shirley A. Wildes  
P.O. Box # 1146  
Okeechobee, Florida  
34973-1146

Check here if this is a change of address.

Telephone: (863) 447-0801 (or) (863) 263-4400

E-mail address: SAW0801@yahoo.com

RECEIVED  
BLM AZ STATE OFFICE  
2010 AUG 24 A 8:29  
PHOENIX, ARIZONA

**AFFIDAVIT OF PERFORMANCE OF ANNUAL WORK**

1. State of Arizona, County of Yavapai ss:

2. I (Name) Shirley A. Wildes

3. Reside at (Address) 14295 N.E. 26th Ave

(P.O. Box 1146 - mailing address)

City Okeechobee County Okeechobee

State FL Zip 34973-1146 being duly sworn, depose and say that I am a citizen of the United States, more than eighteen years of age, and that all of the facts set forth in this affidavit, subject to the provisions and penalties of 18 U.S.C. 1001 pertaining to the filing of false, fictitious, or fraudulent statements with the United States, are true and correct according to the best of my knowledge, information and belief.

4. Owner's name and address (if not shown in Items 1-3 above). \_\_\_\_\_

5. That I am personally acquainted with the mining claim(s). The work and improvements were made by and at the expense of the owner(s) of said claim(s). Said contiguous group of claims, listed on this document, are situated in the

\_\_\_\_\_ (optional) Mining District; \_\_\_\_\_ County, Arizona.

Line No.	AMC NUMBER	CLAIM/SITE NAME	COUNTY RECORDER DATA (If available)	TWP	RNG	SEC
1	390949	Quartz Gold #2	B4600 - P 239	13N	1W	10 NW
2	393518	Bannie Gulch Gold	B4611 - P 510	13N	1W	22 SW
3	395865	New England Gold	B4656 - P 537	13N	2W	NE 1/2 of the NW 1/4 of Section 21
4						
5						
6						

YAVAPAI  
YAVAPAI  
YAVAPAI

RECEIVED  
BLM AZ STATE OFFICE  
2010 AUG 24 A 8:29  
PHOENIX, ARIZONA

BLM  
Date  
Stamp

7					
8					
9					
10					

6. That between the dates starting at 12 o'clock noon on September 1, 20 10 and ending at 12 o'clock noon on September 1, 20 11 at least \$ 750.00 dollars worth of work and improvements were done and performed upon said claim(s) or upon one or more of a contiguous group of claims for the benefit of all, wholly or partly outside of a contiguous group of claims for the benefit of all, not including the location work.

7. That the following persons were employed to perform the work and improvements described herein: Shirley and Donald Wildes and Donald Wildes (JR.)

8. That the work and improvements performed were: Worked each claim 8 days and took samples, picked up and removed limbs out of paths and roads. Removed broken bottles and other debris.

9. Dated: 8-17-2010 Signature: Shirley A. Wildes

SUBSCRIBED AND SWORN TO before me, a Notary Public, this 17 day of Aug. 20 11

By: Shirley A. Wildes  
Notary Public Peggy L. Simmons  
My Commission Expires 10-31-2011

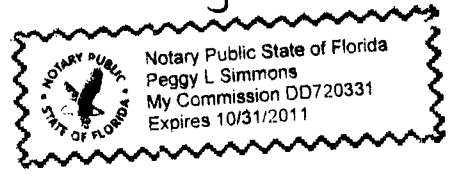

Bureau of Land Management  
Arizona State Office  
[www.az.blm.gov](http://www.az.blm.gov)

No. of Claims: 3 x \$5 = 15.00  
Check No.: \_\_\_\_\_ Init. SPS  
Receipt No.: 2002490  
For BLM Use Only

UNITED STATES DEPARTMENT OF THE INTERIOR  
BUREAU OF LAND MANAGEMENT

*JMC*

MAINTENANCE FEE WAIVER CERTIFICATION

FORM APPROVED  
OMB NO. 1004-0114  
Expires: February 28, 2010

AMC 393518 (39)

SEE INSTRUCTIONS ON REVERSE

1. This small miner waiver is filed for the assessment year beginning at noon on September 1, 08 and ending at noon on September 1, 09.
2. The undersigned and all related parties owned ten or fewer mining claims, mill, or tunnel sites located and maintained on Federal lands in the United States of America on September 1, 08. (2,008)
3. The undersigned have performed the assessment work required by law for each mining claim listed prior to filing this waiver and understand that by filing this form; an affidavit of assessment work must be recorded by the December 30th following the filing of this waiver. AMC 390947
4. The undersigned understand that if the assessment work obligation has not yet come due under 30 U.S.C. 28 (for those claims in their first assessment year only); a notice of intent to hold reciting this condition must be recorded by the December 30th following the filing of this waiver.
5. The undersigned understand that mill and tunnel sites may also be listed upon this waiver and be waived from payment of the maintenance fee; and that a notice of intent to hold for these sites is required to be recorded by the December 30th immediately following the filing of this waiver.
6. The undersigned understand and acknowledge that pursuant to 43 U.S.C. 1212 and 18 U.S.C. 1001; the filing or recording of a false, fictitious, or fraudulent document with the Bureau of Land Management may result in a fine of up to \$250,000, a prison term not to exceed five years, or both.
7. The mining claims, mill or tunnel sites for which this waiver from payment of the maintenance fees is requested are:

CLAIM OR SITE NAME	BLM RECORDATION SERIAL NUMBER
1. Quartz Gold #2 (B4600-P239)	AMC #390949 Yavapai County
2. Bonnie Gulch Gold	AMC #393518 Yavapai County
3.	
4.	
5.	
6.	
7.	
8.	
9.	
10.	

The owner(s) (claimants) of the above mining claims and sites are:

Shirley Wildes  
(Owner's Name - Please Print)  
P.O. Box 1146  
(Street or P.O. Box)  
OKEECHOBEE Florida 34973-1146  
(City) (State) (Zip Code)

Shirley Wildes  
(Owner's Signature)

DONALD Wildes  
(Owner's Name - Please Print)  
  
(Street or P.O. Box)  
  
(City) (State) (Zip Code)

Donald Wildes  
(Owner's Signature)

(Owner's Name - Please Print)  
  
(Street or P.O. Box)  
  
(City) (State) (Zip Code)

RECEIVED  
 BLM AZ STATE OFFICE  
 2008 AUG 11 A T 15  
 PHOENIX ARIZONA

(Continued on page 2)

RE 9/17/08



AMC 40935  
97634  
129535  
7735  
17738  
384552  
35792  
138512  
215329  
319065  
327204  
364145  
370110  
384697  
363628  
393546

**BHP Copper Inc.**  
**Pinto Valley Operations**

August 2009  
Hand Delivered

United States Department of the Interior  
Bureau of Land Management-Arizona State Office  
One North Central  
Suite 800  
Phoenix, Arizona 85004

ATTN: Records Section.

RE: Notice of Intent to Hold and Payment of 2009-2010 Annual Claim Maintenance Fees for BHP Copper Inc. Pinto Valley Operations, Miami Arizona.

To Whom It May Concern:

*The Final Rule as published in the Federal Register implements provisions of the Interior Department and related agencies, Appropriations Act of 1993 (the "Act") that requires an annual rental fee of \$140.00 (from \$100.00 in 2003 and prior) for each unpatented mining claim and site located and held under the General Mining Law of 1872.*

This will serve as notice that BHP Copper Inc. Pinto Valley Operations, whose address for purposes of this filing is: P.O. Box 100 Miami, Arizona 85539. BHP Copper Inc. Pinto Valley Operations intends to hold the mining claims and/or mill sites described in **Exhibit A** attached hereto for the assessment years 2009/2010, by payment of the annual claim maintenance fees (43 CFR 3834.11(a)(2)) of \$140.00 per claim or site (total of ~~407,389~~ <sup>407,389</sup> Payment of **\$54,460.00** is made herewith for such assessment year for each of the claims and sites the name and BLM serial number of which, and the book and page or index number of recording of the location notice is official records of Gila and Pinal Counties, Arizona of which are set forth in **Exhibit A** attached hereto and by this reference incorporated herein.

Sincerely,



**Daniel L Mead**

of Cornerstone Lands DLM/LLC.  
Agent for BHP Copper Inc. Pinto Valley Operations

Enc. Exhibit A

BHP Copper Inc. Check Number 0000113565

RECEIVED  
BLM AZ STATE OFFICE  
PHOENIX, ARIZONA  
AUG 14 A 9:06

*Km*



NOTICE OF INTENT TO HOLD

MAINTENANCE FEE  
2009- 2010 ASSESSMENT YEAR

BHP Copper Inc.  
Pinto Valley Operations

Exhibit "A"

	BLM Serial Number	Name	Docket	Book	Page
1	AMC 7735	Mary 1	426		246
2	AMC 7736	Mary 2	426		247
3	AMC 7737	Mary 3	426		248
4	AMC 7738	Mary 4	426		249
5	AMC 7739	Mary 5	426		250
6	AMC 7740	Mary 6	426		251
7	AMC 27738	Cowboy No. 1 amended		42	127
8	AMC 27739	Cowboy No. 2 amended		42	128
9	AMC 27740	Cowboy No. 3 amended		42	129
10	AMC 27741	Rita		47	150
11	AMC 27742	Copper Site amended		42	124
12	AMC 27743	Pine Tree amended		42	126
13	AMC 384552	BOB #1		2007-011669	
14	AMC 384553	BOB #2		2007-011670	
15	AMC 384554	BOB #3		2007-011671	
16	AMC 384555	BOB #4		2007-011672	
17	AMC 384556	BOB #5		2007-011673	
18	AMC 384557	BOB #6		2007-011674	
19	AMC 27747	Hammer		47	127
20	AMC 27748	Joan		47	128
21	AMC 27749	Southern Cross		47	151
22	AMC 27750	Midnight Test amended		42	125
23	AMC 27751	Copper Bottom No. 1	amended	42	195
24	AMC 27752	Copper Bottom No. 6	amended	42	194
25	AMC 27753	Copper Bottom No. 8		47	385
26	AMC 27754	Copper Bottom No. 9		47	386
27	AMC 27755	Copper Bottom No. 10		47	387
28	AMC 27757	Hill No. 2	280		10
29	AMC 27758	Hill No. 3	280		11
30	AMC 27759	Hill No. 4	280		12
31	AMC 27760	Hill No. 5	280		13

2009 AUG 14 A 9:06

RECEIVED  
PLM AZ STATE OFFICE

32	AMC 27761	Hill No. 6	280		14
33	AMC 27762	Hill No. 7	280		15
34	AMC 27763	Hill No. 8	280		16
35	AMC 27764	Hill No. 9	280		17
36	AMC 27765	Hill No. 10	280		18
37	AMC 27798	Skunk 1	343		203
38	AMC 27799	Skunk 2	343		204
39	AMC 27800	Skunk 3	343		205
40	AMC 27801	Rita No. 15	173		540
41	AMC 27802	Sunrise		48	35
42	AMC 27803	Limestone #1		49	150
43	AMC 27804	Limestone #2		49	150
44	AMC 27805	Limestone #3		49	151
45	AMC 27806	Limestone #4	154		638
46	AMC 27807	Limestone No. 5	154		639
✓ 47	AMC 27817	Ash 16	325		57
✓ 48	AMC 27882	Ash 95	325		122
✓ 49	AMC 27987	Baseline No. 1	284		856
✓ 50	AMC 27988	Baseline No. 2	284		857
51	AMC 27994	Tunnel	10		502
52	AMC 27995	Fly No. 1	157		230
53	AMC 27996	Fly No. 2	157		231
54	AMC 27997	Fly No. 3	157		232
55	AMC 27998	Fly No. 4	157		233
56	AMC 27999	Fly No. 5	157		234
57	AMC 28000	Fly No. 6	157		235
58	AMC 28001	Fly No. 7	157		236
59	AMC 28002	Fly No. 8	157		237
60	AMC 28003	Fly No. 9	157		238
61	AMC 28004	Fly No. 10	157		239
62	AMC 28005	Fly No. 11	157		240
63	AMC 28006	Fly No. 12	157		241
64	AMC 28007	Fly No. 13	157		242
65	AMC 28008	Blue Bird #4		47	415
66	AMC 28009	Conquistador No. 1	amended	49	305
67	AMC 28010	Arizona No. 23	amended	49	304
68	AMC 28011	Arizona No. 24	amended	49	305
69	AMC 28012	Black Eagle #2	107		223
70	AMC 28013	Gold Coin	154		449
71	AMC 28014	Black Owl		43	614
72	AMC 28015	White Owl		43	613
73	AMC 28023	Peak No. 3	333		331

RECEIVED  
 ELM AZ STATE OFFICE  
 2009 AUG 14 A 9:06



74	AMC 28025	Peak No. 7	333		333
75	AMC 28026	Peak No. 8	333		334
76	AMC 28027	Peak No. 9	335		703
77	AMC 28028	Peak No. 10	335		704
78	AMC 28031	Peak No. 14	367		606
79	AMC 28032	Peak No. 15	367		607
80	AMC 28033	Peak No. 17	367		608
81	AMC 28036	Peak No. 22	390		9
82	AMC 28037	Peak No. 24	402		700
83	AMC 28038	Peak 25	405		974
84	AMC 28040	Peak 28	414		719
85	AMC 28041	Key	312		587
86	AMC 28042	Key No. 1	312		588
87	AMC 28043	November Re-located		50	7
88	AMC 28044	October		50	8
89	AMC 28045	Cities No. 1	290		871
90	AMC 28046	Cities No. 2	290		872
91	AMC 28047	Cities No. 3	290		873
92	AMC 28048	Cities No. 4	290		874
93	AMC 28049	Cities No. 5	290		875
94	AMC 28050	Cities No. 6	290		876
95	AMC 28051	Cities No. 7	290		877
96	AMC 28052	Cities No. 8	290		878
97	AMC 28053	Cities No. 9	290		879
98	AMC 28054	Cities No. 10	290		880
99	AMC 28055	Cities No. 11	290		881
100	AMC 28056	Cities No. 12	290		882
101	AMC 28057	Cities No. 13	290		883
102	AMC 28058	Evening Star		39	356
103	AMC 28059	Zee No. 2	284		855
104	AMC 35792	Quartz Site (A)	466		191
105	AMC 35793	Quartz Site No. 2 (A)	466		190
106	AMC 35794	Quartz Site No. 3 (A)	466		189
107	AMC 35800	Quartz Site No. 9 (A)	466		183
108	AMC 35801	Quartz Site No. 10 (A)	466		182
109	AMC 35806	Quartz Site No. 15 (A)	466		177
110	AMC 35807	Quartz Site No. 16 (A)	466		176
111	AMC 35808	Quartz Site No. 17 (A)	466		175
112	AMC 35809	Quartz Site No. 18 (A)	466		174
113	AMC 35810	Quartz Site No. 19 (A)	466		173
114	AMC 35811	Quartz Site No. 20 (A)	466		172
115	AMC 35812	Quartz Site No. 21 (A)	466		171

PHOENIX, ARIZONA

2009 AUG 14 A 9:06

RECEIVED  
BLM AZ STATE OFFICE

✓ 116	AMC 35813	Quartz Site No. 22 (A)	466	170
✓ 117	AMC 35814	Quartz Site No. 23 (A)	466	169
✓ 118	AMC 35815	Quartz Site No. 24 (A)	466	168
✓ 119	AMC 35816	Quartz Site No. 25 (A)	466	167
✓ 120	AMC 35820	Quartz Site #28 (A)	466	165
✓ 121	AMC 35821	Silver Bell (A)	466	192
✓ 122	AMC 35824	Janie No. 1 (A)	466	194
✓ 123	AMC 35825	Janie No. 2 (A)	466	195
✓ 124	AMC 35830	Copper Bottom #2 (A)	466	202
✓ 125	AMC 35831	Copper Bottom #5 (A)	466	215
✓ 126	AMC 35832	Copper Bottom #7 (A)	466	201
✓ 127	AMC 35833	Copper Bottom #11 (A)	466	216
✓ 128	AMC 35834	Copper Bottom #12 (A)	466	217
✓ 129	AMC 35835	Copper Bottom #13 (A)	466	218
✓ 130	AMC 40744	East Water	469	458
✓ 131	AMC 97644	Peak 34	493	567
✓ 132	AMC 129535	Peak 94	534	775
✓ 133	AMC 138512	K1	542	700
✓ 134	AMC 138513	K2	542	702
✓ 135	AMC 138514	K3	542	704
✓ 136	AMC 138515	K4	542	706
✓ 137	AMC 138516	K5	542	708
✓ 138	AMC 138517	K6	542	710
✓ 139	AMC 138518	K7	542	712
✓ 140	AMC 138519	K8	542	714
✓ 141	AMC 138520	K9	542	716
✓ 142	AMC 138521	K10	542	718
✓ 143	AMC 138522	K11	542	720
✓ 144	AMC 138523	K12	542	722
✓ 145	AMC 138524	K13	542	724
✓ 146	AMC 138525	K14	542	726
✓ 147	AMC 138526	K15	542	728
✓ 148	AMC 138527	K16	542	730
✓ 149	AMC 138528	K17	542	732
✓ 150	AMC 138529	K18	542	734
✓ 151	AMC 138530	K19	542	736
✓ 152	AMC 138531	K20	542	738
✓ 153	AMC 138532	K21	542	740
✓ 154	AMC 138533	K22	542	742
✓ 155	AMC 138534	K23	542	744
✓ 156	AMC 138535	K24	542	746
✓ 157	AMC 138536	K25	542	748

RECEIVED  
 PLMAZ STATE OFFICE  
 2009 AUG 14 A 9:06

158	AMC 138537	K26	542	750
159	AMC 138538	K27	542	752
160	AMC 138539	K28	542	754
161	AMC 138540	K29	542	756
162	AMC 138541	K30	542	758
163	AMC 138542	K31	542	760
164	AMC 138543	K32	542	762
165	AMC 138544	K33	542	764
166	AMC 138545	K34	542	766
167	AMC 138546	K35	542	768
168	AMC 142565	M1	549	363
169	AMC 215329	D1	606	157
170	AMC 215330	D2	606	159
171	AMC 215331	D3	606	161
172	AMC 215332	D4	606	163
173	AMC 215333	D5	606	165
174	AMC 215334	D6	606	167
175	AMC 215335	D7	606	169
176	AMC 215336	D8	606	171
177	AMC 215337	D9	606	173
178	AMC 215338	D10	606	175
179	AMC 215339	D11	606	177
180	AMC 215340	D12	606	179
181	AMC 215341	D13	606	181
182	AMC 215344	D16	606	187
183	AMC 215345	D17	606	189
184	AMC 319065	Hill No. 11	855	828
185	AMC 319066	Hill No. 12	855	830
186	AMC 319067	Hill No. 13	855	832
187	AMC 327204	P1	93-634671	ARIZONA
188	AMC 327205	P2	93-634672	
189	AMC 327206	P3	93-634673	
190	AMC 327207	P4	93-634674	
191	AMC 327208	P5	93-634675	
192	AMC 327209	P6	93-634676	
193	AMC 327210	P7	93-634677	
194	AMC 327211	P8	93-634678	
195	AMC 327212	P9	93-634679	
196	AMC 327213	P10	93-634680	
197	AMC 327214	P11	93-634681	
198	AMC 327215	P12	93-634682	
199	AMC 327216	P13	93-634683	

RECEIVED  
 CLM AZ STATE OFFICE  
 2009 AUG 14 A 9:06



200	AMC 327217	P14		93-634684	
201	AMC 327218	P15		93-634685	
202	AMC 327219	P16		93-634686	
203	AMC 327220	P17		93-634687	
204	AMC 327221	P18		93-634688	
205	AMC 364145	E-1		2005-000510	
206	AMC 364146	E-2		2005-000511	
207	AMC 364147	E-3		2005-000512	
208	AMC 364148	E-4		2005-000513	
209	AMC 370110	RJ #1		2006-003905	
210	AMC 370111	RJ #2		2006-003906	
211	AMC 370112	RJ #3		2006-003907	
212	AMC 370113	RJ #4		2006-003908	
213	AMC 370114	RJ #5		2006-003909	
214	AMC 370115	RJ #6		2005-003910	
215	AMC 370116	RJ #7		2006-003911	
216	AMC 370117	RJ #8		2006-003912	
217	AMC 370118	RJ #9		2006-003913	
218	AMC 370119	RJ #10		2006-003914	
219	AMC 370120	RJ #11		2006-003915	
220	AMC 370121	RJ #12		2006-003916	
221	AMC 370122	RJ #13		2006-003917	
222	AMC 370123	RJ #14		2006-003918	
223	AMC 370124	RJ #15		2006-003919	
224	AMC 370125	RJ #16		2006-003920	
225	AMC 370126	RJ #17		2006-003921	
226	AMC 370127	RJ #18		2006-003922	
227	AMC 370128	RJ #19		2006-003923	
228	AMC 370129	RJ #20		2006-003924	
229	AMC 370130	RJ #21		2006-003925	
230	AMC 370131	RJ #22		2006-003926	
231	AMC 370132	RJ #23		2006-003927	
232	AMC 370133	RJ #24		2006-003928	
233	AMC 370134	RJ #25		2006-003929	
234	AMC 370135	RJ #26		2006-003930	
235	AMC 370136	RJ #27		2006-003931	
236	AMC 370137	RJ #28		2006-003932	
237	AMC 370138	RJ #29		2006-003933	
238	AMC 370139	RJ #30		2006-003934	
239	AMC 370140	RJ #31		2006-003935	
240	AMC 370141	RJ #32		2006-003936	
241	AMC 370142	RJ #33		2006-003937	

PHOENIX, ARIZONA

2009 AUG 14 A 9:06

RECEIVED  
BLM AZ STATE OFFICE

242	AMC 370143	RJ #34		2006-003938	
243	AMC 370144	RJ #35		2006-003939	
244	AMC 370145	RJ #36		2006-003940	
245	AMC 370146	RJ #37		2006-003941	
246	AMC 370147	RJ #38		2006-003942	
247	AMC 370148	RJ #39		2006-003943	
248	AMC 370149	RJ #40		2006-003944	
249	AMC 370150	RJ #41		2006-003945	
250	AMC 370151	RJ #42		2006-003946	
251	AMC 370152	RJ #43		2006-003947	
252	AMC 370153	RJ #44		2006-003948	
253	AMC 370154	RJ #45		2006-003949	
254	AMC 370155	RJ #46		2006-003950	
255	AMC 370156	RJ #47		2006-003951	
256	AMC 370157	RJ #48		2006-003952	
257	AMC 370158	RJ #49		2006-003953	
258	AMC 370159	RJ #50		2006-003954	
259	AMC 370160	RJ #51		2006-003955	
260	AMC 370161	RJ #52		2006-003956	
261	AMC 370162	RJ #53		2006-003957	
262	AMC 370163	RJ #54		2006-003958	
263	AMC 370164	RJ #55		2006-003959	
264	AMC 370165	RJ #56		2006-003960	
265	AMC 370166	RJ #57		2006-003961	
266	AMC 370167	RJ #58		2006-003962	
267	AMC 370168	RJ #59		2006-003963	
268	AMC 370169	RJ #60		2006-003964	
269	AMC 370170	RJ #61		2006-003965	
270	AMC 370171	RJ #62		2006-003966	
271	AMC 370172	RJ #63		2006-003967	
272	AMC 370173	RJ #64		2006-003968	
273	AMC 384697	RJ #65		2007-012073	
274	AMC 384698	RJ #66		2007-012074	
275	AMC 384699	RJ #67		2007-012075	
276	AMC 384700	RJ #68		2007-012076	
277	AMC 384701	RJ #69		2007-012077	
278	AMC 384702	RJ #70		2007-012078	
279	AMC 384703	RJ #71		2007-012079	
280	AMC 384704	RJ #72		2007-012080	
281	AMC 363628	BOO 1		2006-101318	
282	AMC 363629	BOO 2		2006-101319	
283	AMC 363630	BOO 3		2006-101320	

PHOENIX, ARIZONA

2009 AUG 14 A 9:07

RECEIVED  
ELMAZ STATE OFFICE

284	AMC 363631	BOO 4		2006-101321	
285	AMC 363632	BOO 5		2006-101322	
286	AMC 363633	BOO 6		2006-101323	
287	AMC 363634	BOO 7		2006-101324	
288	AMC 363635	BOO 8		2006-101325	
289	AMC 363636	BOO 9		2006-101326	
290	AMC 363637	BOO 10		2006-101327	
291	AMC 363638	BOO 11		2006-101328	
291	AMC 363639	BOO 12		2006-101329	
293	AMC 363640	BOO 13		2006-101330	
294	AMC 363641	BOO 14		2006-101331	
295	AMC 363642	BOO 15		2006-101332	
296	AMC 363643	BOO 16		2006-101333	
297	AMC 363644	BOO 17		2006-101334	
298	AMC 363645	BOO 18		2006-101335	
299	AMC 363646	BOO 19		2006-101336	
300	AMC 363647	BOO 20		2006-101337	
301	AMC 363648	BOO 21		2006-101338	
302	AMC 363649	BOO 22		2006-101339	
303	AMC 363650	BOO 23		2006-101340	
304	AMC 363651	BOO 24		2006-101341	
305	AMC 363652	BOO 25		2006-101342	
306	AMC 363653	BOO 26		2006-101343	
307	AMC 363654	BOO 27		2006-101344	
308	AMC 363655	BOO 28		2006-101345	
309	AMC 363656	BOO 29		2006-101346	
310	AMC 363657	BOO 30		2006-101347	
311	AMC 363658	BOO 31		2006-101348	
312	AMC 363659	BOO 32		2006-101349	
313	AMC 363660	BOO 33		2006-101350	
314	AMC 363661	BOO 34		2006-101351	
315	AMC 363662	BOO 35		2006-101352	
316	AMC 363663	BOO 36		2006-101353	
317	AMC 363664	BOO 37		2006-101354	
318	AMC 363665	BOO 38		2006-101355	
319	AMC 363666	BOO 39		2006-101356	
320	AMC 363667	BOO 40		2006-101357	
321	AMC 363668	BOO 41		2006-101358	
322	AMC 363669	BOO 42		2006-101359	
323	AMC 363670	BOO 43		2006-101360	
324	AMC 363671	BOO 44		2006-101361	
325	AMC 363672	BOO 45		2006-101362	

PHOENIX, ARIZONA

RECEIVED  
 PIMA STATE OFFICE  
 2009 AUG 14 A 9:07



326	AMC 363673	BOO 46		2006-101363	
327	AMC 363674	BOO 47		2006-101364	
328	AMC 363675	BOO 48		2006-101365	
329	AMC 363676	BOO 49		2006-101366	
330	AMC 363677	BOO 50		2006-101367	
331	AMC 363678	BOO 51		2006-101368	
332	AMC 363679	BOO 52		2006-101369	
333	AMC 363680	BOO 53		2006-101370	
334	AMC 363681	BOO 54		2006-101371	
335	AMC 363682	BOO 55		2006-101372	
336	AMC 363683	BOO 56		2006-101373	
337	AMC 363684	BOO 57		2006-101374	
338	AMC 363685	BOO 58		2006-101375	
339	AMC 363686	BOO 59		2006-101376	
340	AMC 363687	BOO 60		2006-101377	
341	AMC 363688	BOO 61		2006-101378	
342	AMC 363689	BOO 62		2006-101379	
343	AMC 363690	BOO 63		2006-101380	
344	AMC 363691	BOO 64		2006-101381	
345	AMC 363692	BOO 65		2006-101382	
346	AMC 363693	BOO 66		2006-101383	
347	AMC 363694	BOO 67		2006-101384	
348	AMC 363695	BOO 68		2006-101385	
349	AMC 363696	BOO 69		2006-101386	
350	AMC 363697	BOO 70		2006-101387	
351	AMC 363698	BOO 71		2006-101388	
352	AMC 363699	BOO 72		2006-101389	
353	AMC 363700	BOO 73		2006-101390	
354	AMC 363701	BOO 74		2006-101391	
355	AMC 363702	BOO 75		2006-101392	
356	AMC 363703	BOO 76		2006-101393	
357	AMC 363704	BOO 77		2006-101394	
358	AMC 363705	BOO 78		2006-101395	
359	AMC 363706	BOO 79		2006-101396	
360	AMC 363707	BOO 80		2006-101397	
361	AMC 363708	BOO 81		2006-101398	
362	AMC 363709	BOO 82		2006-101399	
363	AMC 363710	BOO 83		2006-101400	
364	AMC 363711	BOO 84		2006-101401	
365	AMC 363712	BOO 85		2006-101402	
366	AMC 363713	BOO 86		2006-101403	
367	AMC 363714	BOO 87		2006-101404	

PHOENIX, ARIZONA

2009 AUG 14 A 9:07

RECEIVED  
BLM AZ STATE OFFICE

368	AMC 363715	BOO 88		2006-101405
369	AMC 363716	BOO 89		2006-101406
370	AMC 363717	BOO 90		2006-101407
371	AMC 363718	BOO 91		2006-101408
372	AMC 363719	BOO 92		2006-101409
373	AMC 363720	BOO 93		2006-101410
374	AMC 363721	BOO 94		2006-101411
375	AMC 363722	BOO 95		2006-101412
376	AMC 363723	BOO 96		2006-101413
377	AMC 363724	BOO 97		2006-101414
378	AMC 363725	BOO 98		2006-101415
379	AMC 363726	BOO 99		2006-101416
380	AMC 363727	BOO 100		2006-101417
381	AMC 363728	BOO 101		2006-101418
382	AMC 363729	BOO 102		2006-101419
383	AMC 363730	BOO 103		2006-101420
384	AMC 363731	BOO 104		2006-101421
385	AMC 363732	BOO 105		2006-101422
386	AMC 393546	TOE 19		2008-009416
387	AMC 393547	TOE 20		2008-009417
388	AMC 393548	TOE 21		2008-009418
389	AMC 393549	TOE 22		2008-009419

PHOENIX, ARIZONA

2009 AUG 14 A 9:07

RECEIVED  
BLM AZ STATE OFFICE

**United States Department of the Interior**

**Bureau of Land Management**

BUSINESS & SUPPORT SVCS DIV

ONE N CENTRAL AVE SUITE 800

PHOENIX, AZ 85004 -4427

Phone: (602) 417-9200

Receipt

No:

1977643

<b>Transaction #:</b> 2041637	
<b>Date of Transaction:</b> 08/14/2009	
<b>CUSTOMER:</b>	BHPBILLITON 1360 POST OAK BLVD STE 150 HOUSTON, TX 77056-3030 US

LINE #	QTY	DESCRIPTION	REMARKS	UNIT PRICE	TOTAL
1	1.00	LOCATABLE MINERALS / MINING CLAIMS-NOT NEW-UNADJUD, ONE AUTH NO. ONLY / MINING CLAIM MONEY RECEIVED CASES: AMC7735/\$54460.00	MAINT 2010/389	- n/a -	54460.00
<b>TOTAL:</b>					<b>\$54,460.00</b>

PAYMENT INFORMATION			
1	<b>AMOUNT:</b>	54460.00	<b>POSTMARKED:</b> N/A
	<b>TYPE:</b>	CHECK	<b>RECEIVED:</b> 08/14/2009
	<b>CHECK NO:</b>	113569	
	<b>NAME:</b>	BHPBILLITON 1360 POST OAK BLVD STE 150 HOUSTON TX 77056-3030 US	

<b>REMARKS</b>

This receipt was generated by the automated BLM Collections and Billing System and is a paper representation of a portion of the official electronic record contained therein.



587

UNITED STATES DEPARTMENT OF THE INTERIOR  
BUREAU OF LAND MANAGEMENT

AMC 389919  
AMC 390947  
AMC 393518  
FORM APPROVED  
OMB NO. 1004-0114  
Expires: February 28, 2010  
AMC 395865

MAINTENANCE FEE WAIVER CERTIFICATION

SEE INSTRUCTIONS ON REVERSE

1. This small miner waiver is filed for the assessment year beginning at noon on September 1, \_\_\_\_\_ and ending at noon on September 1, \_\_\_\_\_.
2. The undersigned and all related parties owned ten or fewer mining claims, mill, or tunnel sites located and maintained on Federal lands in the United States of America on September 1, \_\_\_\_\_.
3. The undersigned have performed the assessment work required by law for each mining claim listed prior to filing this waiver and understand that by filing this form, an affidavit of assessment work must be recorded by the December 30th following the filing of this waiver.
4. The undersigned understand that if the assessment work obligation has not yet come due under 30 U.S.C. 28 (for those claims in their first assessment year only); a notice of intent to hold reciting this condition must be recorded by the December 30th following the filing of this waiver.
5. The undersigned understand that mill and tunnel sites may also be listed upon this waiver and be waived from payment of the maintenance fee; and that a notice of intent to hold for these sites is required to be recorded by the December 30th immediately following the filing of this waiver.
6. The undersigned understand and acknowledge that pursuant to 43 U.S.C. 1212 and 18 U.S.C. 1001; the filing or recording of a false, fictitious, or fraudulent document with the Bureau of Land Management may result in a fine of up to \$250,000, a prison term not to exceed five years, or both.
7. The mining claims, mill or tunnel sites for which this waiver from payment of the maintenance fees is requested are:

CLAIM OR SITE NAME	BLM RECORDATION SERIAL NUMBER
1. Quartz Hold #2 (B4600-P239)	AMC# 390949 Yavapai
2. Bonnie Gulch Hold (B4611-P510)	AMC # 393518 Yavapai
3. New England Hold (B4656-P537)	AMC # 395865 Yavapai
4.	
5.	
6.	
7.	
8.	
9.	
10.	

The owner(s) (claimants) of the above mining claims and sites are:

Shirley Wildes  
 (Owner's Name - Please Print)  
 P.O. Box 1146  
 (Street or P.O. Box)  
 Okeechobee FL 34973-1146  
 (City) (State) (Zip Code)

Shirley Wildes  
 (Owner's Signature)

Donald Wildes  
 (Owner's Name - Please Print)  
 P.O. Box 1146  
 (Street or P.O. Box)  
 Okeechobee FL 34973-1146  
 (City) (State) (Zip Code)

Donald Wildes  
 (Owner's Signature)

PHOENIX, ARIZONA  
 2009 SEP -3 A 8:11  
 RECEIVED  
 BLM AZ STATE OFFICE  
 TIMELY FILED

\_\_\_\_\_  
 (Owner's Name - Please Print)  
 \_\_\_\_\_  
 (Street or P.O. Box)  
 \_\_\_\_\_  
 (City) (State) (Zip Code)



UNITED STATES DEPARTMENT OF THE INTERIOR  
BUREAU OF LAND MANAGEMENT

MAINTENANCE FEE WAIVER CERTIFICATION

SEE INSTRUCTIONS ON REVERSE

FORM APPROVED  
OMB NO. 1004-0114  
Expires: February 28, 2010

AMC 389919

1. This small miner waiver is filed for the assessment year beginning at noon on September 1, \_\_\_\_\_ and ending at noon on September 1, \_\_\_\_\_.
2. The undersigned and all related parties owned ten or fewer mining claims, mill, or tunnel sites located and maintained on Federal lands in the United States of America on September 1, \_\_\_\_\_.
3. The undersigned have performed the assessment work required by law for each mining claim listed prior to filing this waiver and understand that by filing this form; an affidavit of assessment work must be recorded by the December 30th following the filing of this waiver.
4. The undersigned understand that if the assessment work obligation has not yet come due under 30 U.S.C. 28 (for those claims in their first assessment year only); a notice of intent to hold reciting this condition must be recorded by the December 30th following the filing of this waiver.
5. The undersigned understand that mill and tunnel sites may also be listed upon this waiver and be waived from payment of the maintenance fee; and that a notice of intent to hold for these sites is required to be recorded by the December 30th immediately following the filing of this waiver.
6. The undersigned understand and acknowledge that pursuant to 43 U.S.C. 1212 and 18 U.S.C. 1001; the filing or recording of a false, fictitious, or fraudulent document with the Bureau of Land Management may result in a fine of up to \$250,000, a prison term not to exceed five years, or both.
7. The mining claims, mill or tunnel sites for which this waiver from payment of the maintenance fees is requested are:

CLAIM OR SITE NAME	BLM RECORDATION SERIAL NUMBER
1. Magic Gold #5	AMC. 389922
2.	
3. (TWP 4N - R10E 12W - Sec. SE 4 of Sec 4)	2008-00995
4. (Gila & Salt River Base & Meridian)	
5. (AZ - County - LA PAZ)	
6.	
7.	
8.	
9.	
10.	

The owner(s) (claimants) of the above mining claims and sites are:

Shirley Wildes  
(Owner's Name - Please Print)

Shirley Wildes  
(Owner's Signature)

P.O. Box 1146  
(Street or P.O. Box)

Okreechabee FL 34973-1146  
(City) (State) (Zip Code)

Donald Wildes  
(Owner's Name - Please Print)

Donald Wildes  
(Owner's Signature)

P.O. box 1146  
(Street or P.O. Box)

Okreechabee FL 34973  
(City) (State) (Zip Code)

(Owner's Name - Please Print)

(Street or P.O. Box)

(City) (State) (Zip Code)

(Continued on page 2)

PHOTOGRAPHY  
2009 SEP - 3 A 8: 14  
RECEIVED  
BLM AZ STATE OFFICE  
TIMELY FILED



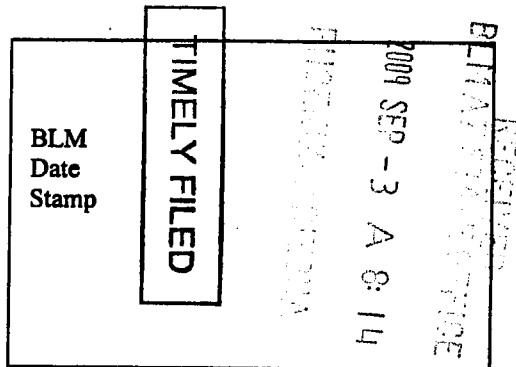

7					
8					
9					
10					

6. That between the dates starting at 12 o'clock noon on September 1, 20 09 and ending at 12 o'clock noon on September 1, 20 10 at least \$ 250.00 dollars worth of work and improvements were done and performed upon said claim(s) or upon one or more of a contiguous group of claims for the benefit of all, wholly or partly outside of a contiguous group of claims for the benefit of all, not including the location work.

7. That the following persons were employed to perform the work and improvements described herein: Shirley Wildes & Donald Wildes SR.

8. That the work and improvements performed were: picking up garbage, broke bottles and beer cans, checked markers that were knocked down. Empty bullet shells picked up.

9. Dated 8-28-09 Signature: Shirley Wildes

SUBSCRIBED AND SWORN TO before me, a Notary Public, this 28<sup>th</sup> day of Aug. 20 09

By: Angela Pfennig

Notary Public of FLORIDA

My Commission Expires 12/18/2011

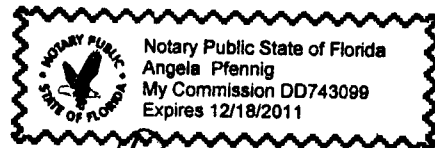

Bureau of Land Management  
Arizona State Office  
[www.az.blm.gov](http://www.az.blm.gov)

No. of Claims: 1 x \$5 = 10.00  
 Check No.: 2166 Init. SP28  
 Receipt No.: 1996079  
 For BLM Use Only





When Recorded Return Document to:  
Shirley A. Wildes  
P.O. Box 1146  
Okeechobee, Florida  
34973-1146

Check here if this is a change of address.  
 Telephone: (863) 763-4400  
 E-mail address: SAW0801@yahoo.com

**AFFIDAVIT OF PERFORMANCE OF ANNUAL WORK**

1. State of Arizona, County of La Paz ss:  
 2. I (Name) Shirley A. Wildes  
 3. Reside at (Address) 14295 N.E. 26<sup>th</sup> Ave  
(P.O. Box 1146 - mailing address)  
 City Okeechobee County Okeechobee  
 State FL Zip 34973-1146

RECEIVED  
 BLM DISTRICT OFFICE  
 2009 SEP -3 A 8:14  
 PLM DISTRICT OFFICE

BLM  
Date  
Stamp

being duly sworn, depose and say that I am a citizen of the United States, more than eighteen years of age, and that all of the facts set forth in this affidavit, subject to the provisions and penalties of 18 U.S.C. 1001 pertaining to the filing of false, fictitious, or fraudulent statements with the United States, are true and correct according to the best of my knowledge, information and belief.  
 4. Owner's name and address (if not shown in Items 1-3 above). \_\_\_\_\_

5. That I am personally acquainted with the mining claim(s). The work and improvements were made by and at the expense of the owner(s) of said claim(s). Said contiguous group of claims, listed on this document, are situated in the \_\_\_\_\_ (optional) Mining District; \_\_\_\_\_ County, Arizona.

La Paz

Line No.	AMC NUMBER	CLAIM/SITE NAME	COUNTY RECORDER DATA (If available)	TWP	RNG	SEC
1	389922	(Magic Gold) #5	2008-00995 (La Paz County)	4 N	12 W	S. E. 1/4 of Sec. 6. 1/4 Salt River Base & Meridian La Paz
2						
3						
4						
5						
6						



When Recorded Return Document to:

Shirley A. Wildes  
P.O. Box 1146  
Okeechobee, Florida  
34973-1146

Check here if this is a change of address.

Telephone: (863) 763-4400

E-mail address: SAW0801@yahoo.com

RECEIVED  
BLM ARIZONA OFFICE  
2009 SEP -3 A 8:14  
PIPIPIPI ARIZONA

**AFFIDAVIT OF PERFORMANCE OF ANNUAL WORK**

1. State of Arizona, County of Yavapai ss:

2. I (Name) Shirley A. Wildes

3. Reside at (Address) 14295 N.E. 26<sup>th</sup> Ave  
(P.O. Box 1146 - mailing address)  
City Okeechobee County Okeechobee

BLM  
Date  
Stamp

State FL, Zip 34973-1146 being duly sworn, depose and say that I am a citizen of the United States, more than eighteen years of age, and that all of the facts set forth in this affidavit, subject to the provisions and penalties of 18 U.S.C. 1001 pertaining to the filing of false, fictitious, or fraudulent statements with the United States, are true and correct according to the best of my knowledge, information and belief.

4. Owner's name and address (If not shown in Items 1-3 above), \_\_\_\_\_

5. That I am personally acquainted with the mining claim(s). The work and improvements were made by and at the expense of the owner(s) of said claim(s). Said contiguous group of claims, listed on this document, are situated in the \_\_\_\_\_ (optional) Mining District; \_\_\_\_\_ County, Arizona.

yavapai  
yavapai  
yavapai

Line No.	AMC NUMBER	CLAIM/SITE NAME	COUNTY RECORDER DATA (If available)	TWP	RNG	SEC
1	390949	Quartz Gold #2	B4600-P239	13N	1W	10NW
2	393518	Bannic Gulch Gold	B4611-P510	13N	1W	22SW
3	395865	New England Gold	B4656-P537	13N	2W	NE 1/2 of the NW of section 21
4						
5						
6						





Shirley Wildes  
P.O. Box 1146  
Okeechobee, FL.

WEST PALM BCH FL

31 AUG 2009 PM

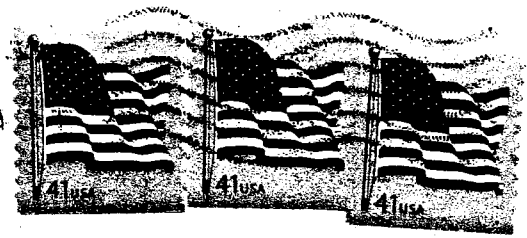

34973-1146

RECEIVED  
STATE OFFICE

2009 SEP -2 P 2:38

PHOENIX, ARIZONA

AMC # 390949  
AMC # 393518  
AMC # 395865  
AMC # 389922

BLM - ARIZONA  
One N Central Avenue  
Suite 800  
Phoenix, Arizona  
85004-4427

65004+4427



**United States Department of the Interior**  
**Bureau of Land Management**  
 BUSINESS & SUPPORT SVCS DIV  
 ONE N CENTRAL AVE SUITE 800  
 PHOENIX, AZ 85004 -4427  
 Phone: (602) 417-9200

Receipt

No: 1996079

<b>Transaction #:</b> 2060389	
<b>Date of Transaction:</b> 09/03/2009	
<b>CUSTOMER:</b>	DONALD WILDES ETAL PO BOX 1146 OKEECHOBEE,FL 34973-1146 US

LINE #	QTY	DESCRIPTION	REMARKS	UNIT PRICE	TOTAL
1	1.00	LOCATABLE MINERALS / MINING CLAIMS-NOT NEW-UNADJUD,ONE AUTH NO. ONLY / MINING CLAIM MONEY RECEIVED CASES: AMC389922/\$40.00	POL/WAIVER	- n/a -	40.00
<b>TOTAL:</b>					<b>\$40.00</b>

PAYMENT INFORMATION			
1	AMOUNT:	10.00	POSTMARKED: 08/31/2009
	TYPE:	CHECK	RECEIVED: 09/03/2009
	CHECK NO:	2166	
	NAME:	WILDES, SHIRLEY A 2558 N.E. 144TH ST OKEECHOBEE FL 34972 US	
2	AMOUNT:	30.00	POSTMARKED: 08/31/2009
	TYPE:	CHECK	RECEIVED: 09/03/2009
	CHECK NO:	2167	
	NAME:	WILDES, SHIRLEY A 2558 N.E. 144TH ST OKEECHOBEE FL 34972 US	

REMARKS

This receipt was generated by the automated BLM Collections and Billing System and is a paper representation of a portion of the official electronic record contained therein.

8-11-08

Dear Mr. Cole

Thanks so much for your help in my filing of the paperwork I needed to do. Next year maybe I'll have it down pat.

If there's anything else I need to send in please contact me at my business and home number which is (863) 763-4400.

Once again thanks for your assistance.

Sincerely,  
Shirley Wildes  
P.O. Box 1146  
©KEECHOBEE, Florida  
34973-1146

AMC 390947

393518

8/15/08 2:50pm Live Busy  
3:25pm LFT MSG - Needs to do waiver for 2 claims  
3:40pm Called me back - She will mail waiver in.

RECEIVED  
B.L.M. AZ STATE OFFICE  
2008 AUG 15 A 7 09  
PHOENIX, ARIZONA

**MAINTENANCE FEE PAYMENT**

Claimant Name: Shirley and Donald Wildes  
 Address: P.O. Box 1146  
 City: ONEECHOBEE State: FL. Zip: 34973-1146  
 Telephone: (863) 763-4400  
 E-mail address: SAW0801@yahoo.com  
 Signature: Shirley Wildes

Check here if this is a change of address.

RECEIVED  
 BLM, AZ STATE OFFICE  
 PHOENIX, ARIZONA  
 2008 AUG 15 A 7:10  
 BLM  
 Date  
 Stamp

LINE NO.	AMC NUMBER	CLAIM/SITE NAME	COUNTY RECORDER DATA (If available)	TWP	RNG	SEC
1	390949	Quartz Gold # 2	B-4600 P239 (6-3-2008)	13N	1W	10NW
2	339518	Bannie Gulch Gold	Transaction 1805565-7-25-08 Receipt # 1748376	13N	1W	22SW
3						
4						
5		( Completed maintenance work on these )				
6		Shirley Wildes				
7						
8						
9						
10						

List additional claims on Form MCF114.

**Bureau of Land Management**  
**Arizona State Office**  
[www.az.blm.gov](http://www.az.blm.gov)

No. of Claims: \_\_\_\_\_ x \$125 = \_\_\_\_\_  
 Check No: \_\_\_\_\_ Init. \_\_\_\_\_  
 Receipt No.: \_\_\_\_\_  
**For BLM Use Only**

Form: MCF112  
 Revised July 2005

This form is available from the Arizona Department of Mines and Mineral Resources and may be reproduced.



NMC 390747  
393518

Which Recorded Return Document:  
Shirley & Donald Wildes  
P.O. Box 1146  
KEECHOBEE Florida  
34973-1146

Check here if this is a change of address  
 Telephone (863) 763-4400 Home & Business  
 E-mail address SAW0801@yahoo.com

AFFIDAVIT OF PERFORMANCE OF ANNUAL WORK

1. State of Arizona County of Yavapai ss:  
 2. I (Name) Shirley Wildes  
 3. Reside at (Address) 14295 N.E. 26th Ave.  
(P.O. Box 1146 mailing address)  
 City Keeshobee County Keeshobee

RECEIVED  
 B.L.M. AZ STATE OFFICE  
 PHOENIX, ARIZONA  
 2008 AUG 15 A 7:09  
 BLM  
 Date  
 Stamp

State FL zip 34973 being duly sworn, depose and say that I am a citizen of the United States, more than eighteen years of age, and that all of the facts set forth in this affidavit, subject to the provisions and penalties of 18 U.S.C. 1001 pertaining to the filing of false, fictitious, or fraudulent statements with the United States, are true and correct according to the best of my knowledge, information and belief.

4. Owner's name and address (if not shown in items 1-3 above), \_\_\_\_\_

5. That I am personally acquainted with the mining claim(s). The work and improvements were made by and at the expense of the owner(s) of said claim(s). Said contiguous group of claims, listed on this document, are situated in the

(optional) Mining District: Yavapai County, Arizona.

Line No	AMC NUMBER	CLAIM/SITE NAME	COUNTY RECORDER DATA (if available)	TWP	RNG	SEC
1	390949	Quartz Gold #2	B-4600 P239 (6-3-2008)	13N	1W	10NW
2	393518	Bunnie Gulch Gold	Transaction 1805565 - 7/25/2008 (Receipt # 1748376)	13N	1W	22SW
3						
4		( Completed maintenance work on these )				
5		( Shirley Wildes )				
6						

RECEIVED  
 BLM STATE OFFICE  
 PHOENIX, ARIZONA  
 2008 AUG 15 A 7:10  
 BLM  
 Date  
 Stamp

7					
8					
9					
10					

6. That between the dates starting at 12 o'clock noon on September 1, 2007 and ending at 12 o'clock noon on September 1, 2008 at least \$ 250.00+ dollars worth of work and improvements were done and performed upon said claim(s) or upon one or more of a contiguous group of claims for the benefit of all, wholly or partly outside of a contiguous group of claims for the benefit of all, not including the location work.

7. That the following persons were employed to perform the work and improvements described herein: WORK performed by Shirley and Donald Wildes 2 days total.

8. That the work and improvements performed were: clearing right of way, picking up trash, picking up broken beer bottles, and empty ammunition shells left and strewn all over.

9. Dated: 8-12-08 Signature: Shirley Wildes

SUBSCRIBED AND SWORN TO before me, a Notary Public, this 12 day of Aug. 2008

By: Shirley Wildes

Notary Public Peggy L. Simmons

My Commission Expires 10-31-2011

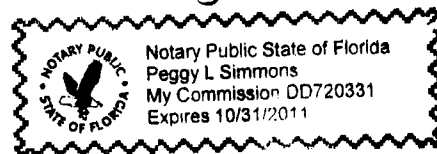

Bureau of Land Management  
 Arizona State Office

No. of Claims:	<u>3</u>	x \$10 =	<u>30</u>
Check No.:	<u>24</u>	Init.	<u>YMC</u>
Receipt No.:	<u>1762731</u>		
For BLM Use Only			

Form: MCF108  
 Revised Jan. 2006  
 Page 2 of 2

United States Department of the Interior  
 Bureau of Land Management  
 BUSINESS & SUPPORT SVCS DIV  
 ONE N CENTRAL AVE SUITE 800  
 PHOENIX, AZ 85004 -4427  
 Phone: (602) 417-9200

Receipt

No:

1762731

<b>Transaction #:</b> 1820303	
<b>Date of Transaction:</b> 08/15/2008	
<b>CUSTOMER:</b>	DONALD WILDES SHIRLEY WILDES BOX 1146 OKEECHOBEE, FL 34973

LINE #	QTY	DESCRIPTION	REMARKS	UNIT PRICE	TOTAL
1	1.00	LOCATABLE MINERALS / MINING CLAIMS-NOT NEW-UNADJUD, ONE AUTH NO. ONLY / MINING CLAIM MONEY RECEIVED (455) CASES: AMC390949/\$20.00	POL 2008/2	- n/a -	20.00
<b>TOTAL:</b>					<b>\$20.00</b>

PAYMENT INFORMATION			
1	AMOUNT:	\$20.00	POSTMARKED: 8/12/08 0:00
	TYPE:	CHECK	RECEIVED: 08/15/2008
	CHECK NO:	724	
	NAME:	WILDES, DONALD BOX 1146 OKEECHOBEE FL 34973	

REMARKS
CONTAINED NO WAV/BC ATTEMPTING TO MAKE PHONE CALL FOR SUCH

This receipt was generated by the automated BLM Collections and Billing System and is a paper representation of a portion of the official electronic record contained therein.

*Also filed maint with the 2 POLS. No monies attached*

**NOTICE!!**

**These documents have been scanned!**

**Do not place un-scanned documents beneath this notice!**

**Do not remove this notice from this file!**

GPO Jacket No. 560-102  
Print Order 61540  
Rise Business Services, LLC  
Job=AZ15 5/23/2019



Box Number= AZ15081



Claim Begin-End: AMC393518-AMC393518

**5 Miscellaneous**



AZ15081-10

AMC392436-AMC393518



**NO  
DOCUMENTS  
FOUND**

NO DOCUMENTS FOUND  
NO DOCUMENTS FOUND

**NOTICE!!**

**These documents have been scanned!**

**Do not place un-scanned documents beneath this notice!**

**Do not remove this notice from this file!**

GPO Jacket No. 560-102  
Print Order 61540  
Rise Business Services, LLC  
Job=AZ15 5/23/2019



Box Number= AZ15081



Claim Begin-End: AMC393518-AMC393518

**6 Location Notices-Amendments and Supporting Documents**



AZ15081-10

AMC392436-AMC393518

MINING CLAIM STATUS REPORT

MTP CHECKED BY \_\_\_\_\_  
GEO CHECKED BY \_\_\_\_\_

LEAD SERIAL NO. AMC 393518 THROUGH AMC \_\_\_\_\_

# <u>1</u> LODE	LOCATION FEE @ \$30 =	\$ <u>30.00</u>
# _____ PLACER	PROCESSING FEE @ \$15 =	\$ <u>15.00</u>
# _____ ASSOCIATION PL	MAINTENANCE FEE @ \$125 =	\$ <u>125.00</u>
# _____ MILL SITE	OVERAGE	\$ _____
# _____ TUNNEL SITE	SHORTAGE	\$ _____
	OTHER FEES	\$ _____
ENOUGH LOCATORS	TOTAL	\$ <u>170.00</u>
YES [ ] NO [ ]		

OVER-THE-COUNTER [ ] MAIL  TIMELY FILED: YES  NO [ ]

LEGAL DESCRIPTION: T 13N R 1W SEC 22

T \_\_\_\_\_ R \_\_\_\_\_ SEC \_\_\_\_\_

T \_\_\_\_\_ R \_\_\_\_\_ SEC \_\_\_\_\_

T \_\_\_\_\_ R \_\_\_\_\_ SEC \_\_\_\_\_

BLM [ ] FOREST SERVICE [ ] \_\_\_\_\_ SUBJ TO PL 359: YES [ ] NO [ ]

WILDERNESS AREA: NO [ ] YES [ ] \_\_\_\_\_

SPLIT ESTATE: SX [ ] PX [ ] SRHA [ ] OTHER [ ] \_\_\_\_\_ N/A [ ]  
PROPER NOTICE FILED IF LOCATED ON SRHA LANDS-YES [ ] NO [ ] N/A [ ]

RECONVEYED MINERALS ON BLM LANDS REQUIRE OPENING ORDERS  
FROM 1944 TO 1993. OPEN TO ENTRY ON: \_\_\_\_\_ N/A [ ]

COMMENTS/STATUS: VOID [ ] PARTIALLY VOID [ ] PVT MINERALS [ ]  
WITHDRAWN LANDS [ ] OTHER [ ] \_\_\_\_\_

\_\_\_\_\_

\_\_\_\_\_

\_\_\_\_\_

\_\_\_\_\_

\_\_\_\_\_

\_\_\_\_\_

\_\_\_\_\_

Claimant acknowledges that portions of the following claim(s) site(s) may be void or voidable. \_\_\_\_\_

\_\_\_\_\_

Signature of claimant \_\_\_\_\_

FINAL ADJUDICATION \_\_\_\_\_ DATE \_\_\_\_\_

AMC 393518



**DEPARTMENT OF THE INTERIOR  
BUREAU OF LAND MANAGEMENT  
MINING CLAIMS**

Run Date/Time: 09/30/2014 03:09 PM

**(LIVE) Serial Register Page**

Page 1 of 1

**01 10-21-1976;090STAT0090;43USC1744**

**Case Type 384201: PLACER CLAIM**

**Claim Name: BANNIE GULCH GOLD**

**Commodity :**

**Case Disposition: ACTIVE**

**Required Maintenance Fee: \$310.00**

**Total Acres**

**40.000**

**Serial Number**

**AMC393518**

**Lead File Number**

**AMC393518**

Name & Address				Int Rel	
WILDES SHIRLEY ANN	PO BOX 1146	OKEECHOBEE, FL 34973-1146	CLAIMANT		
WILDES DON	PO BOX 1146	OKEECHOBEE, FL 34973-1146	CLAIMANT		
Mer Twp	Rng	Sec	Quadrant	District/Field Office	County
14	0130N	0010W	022 SW	HASSAYAMPA FO	YAVAPAI

Act Date	Code	Action	Action Remarks	Receipt Number
06/25/2008	403	LOCATION DATE		
06/27/2008	395	RECORDATION NOTICE RECD	1	1735210
09/02/2014	483	SMALL MINER CERT FILED	2015	
09/02/2014	480	EVID OF ASSMT FILED	2014	3121775
09/03/2013	483	SMALL MINER CERT FILED	2014	
09/04/2013	480	EVID OF ASSMT FILED	2013	2875739
08/27/2012	483	SMALL MINER CERT FILED	2013	
08/27/2012	480	EVID OF ASSMT FILED	2012	2643162
08/24/2011	483	SMALL MINER CERT FILED	2012	
08/24/2011	480	EVID OF ASSMT FILED	2011	2413876
08/24/2010	483	SMALL MINER CERT FILED	2011	
08/24/2010	480	EVID OF ASSMT FILED	2010	2202490
09/01/2009	483	SMALL MINER CERT FILED	2010	
09/01/2009	480	EVID OF ASSMT FILED	2009	1996079
08/21/2008	483	SMALL MINER CERT FILED	2009	
08/15/2008	480	EVID OF ASSMT FILED	2008	1762731
06/27/2008	484	LOCATION YEAR / MAINTENANCE	2008	1735210
09/02/2014	392	MONIES RECEIVED	\$30.00;1	3121775
09/02/2014	635	AMENDED LOCATION FILED	REDUCE ACRES	3121775
08/13/2014	393	DECISION/NOTICE ISSUED	PROOF OF DISCOVERY REQ	
08/02/2010	669	LAND STATUS CHECKED		
07/24/2008	312	RELQ FILED (PARTIAL)	SCHISEL DANIEL	
07/24/2008	312	RELQ FILED (PARTIAL)	SCHISEL CONNIE	
07/24/2008	312	RELQ FILED (PARTIAL)	SCHISEL DANELL	
07/24/2008	396	TRF OF INTEREST FILED	SCHISEL MICAH II	1748376
07/24/2008	396	TRF OF INTEREST FILED	SCHISEL MICAH	1748376
06/27/2008	501	ACCT ADV IN LEAD FILE	AMC393518;	

Line Nr Remarks

**NO WARRANTY IS MADE BY BLM  
FOR USE OF THE DATA FOR  
PURPOSES NOT INTENDED BY BLM**



Amended MINU# 393518  
Bannie Gulch Gold

LOCATION NOTICE FOR PLACER MINING CLAIM

NOTICE IS HEREBY GIVEN that the Bannie  
Gulch Gold placer mining claim has been located by  
Shirley & Donald Wildes whose current mailing  
address is P.O. Box 1146 Okeechobee  
Florida 34973

RECEIVED  
BLM AZ STATE OFF  
2014 SEP - 2 P 3:41  
PHOENIX, ARIZONA  
BLM  
Date  
Stamp

The general course of this claim is AMC# 393518 and it is situated in YAVAPAI  
County, Arizona. 40A

This claim is 1320 feet in length and 1320 feet in width. This claim runs from the  
location monument on which this location notice is posted approximately \_\_\_\_\_ feet in a \_\_\_\_\_  
direction to the \_\_\_\_\_ and line and \_\_\_\_\_ feet in a \_\_\_\_\_ direction to the \_\_\_\_\_ end line.

This claim is marked by four monuments, one at each corner of the claim.

The location monument on which this notice is posted is situated within Section NW 1/4 SW 1/4 of Sect 27  
13 N, Range 13 N, Gila Salt River Base and Meridian, Arizona. This claim encompasses  
portions of the following legal subdivision(s) if located by legal subdivision or the following quarter section (s),  
section (s), Township (s) and Range (s) \_\_\_\_\_

\_\_\_\_\_, Gila Salt River Base and Meridian, Arizona.

The locality of this claim with reference to some natural object or permanent monument and additional  
information (if any) concerning its locality are as follows: monument marker SE CORNER  
of bottom 1/2 of amended claim from 80 acres down to 40 acres

DATED AND POSTED on the ground this 26<sup>th</sup> day of Aug, 2014  
LOCATOR (s) Shirley Wildes & Donald Wildes

Form MCF102  
Revised July 2005

This form is available from the Arizona Department of Mines & Mineral Resources and may be reproduced.

ENTERED SEP 30 2014  
AC 635  
REDUCED ACRES to 40A.  
PB

RECEIPT # 3121775

Amended 80 acres  
 down to 40 acres  
 due to BLM (AZ)  
 By Shirley Wildes & Donald Wildes  
 8/26/04

MINING CLAIM MAP

Lode ( ) Placer ( )

AC 635  
 ENTERED SEP 30 2014  
 Amendment Approved by  
 A. Thowler ps

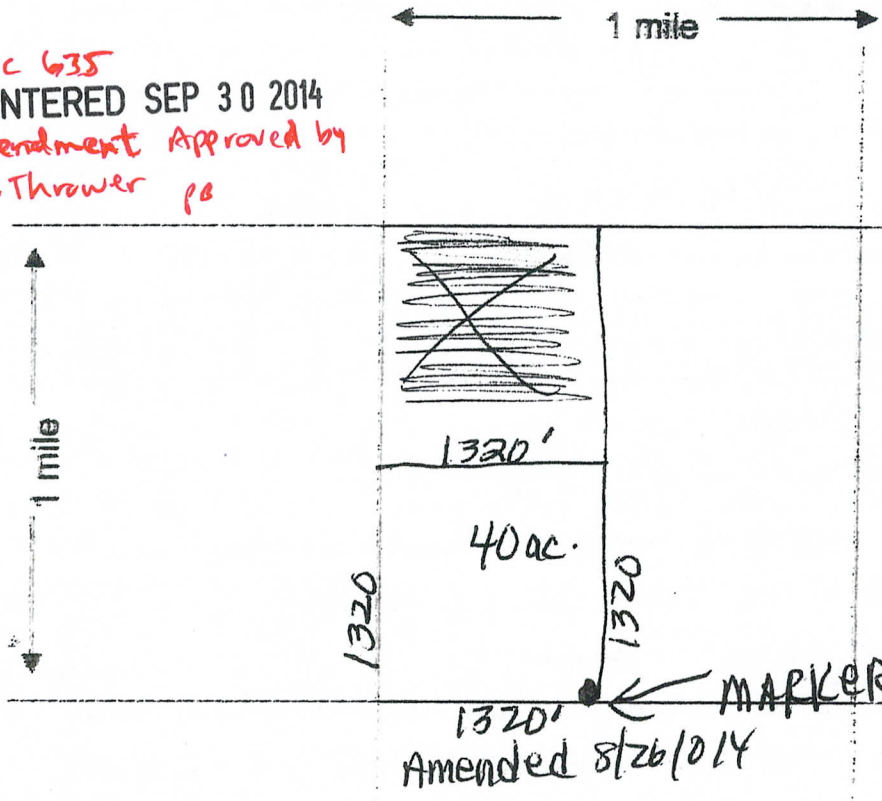

RECEIVED  
 BLM AZ STATE OFFICE  
 2014 SEP - 2 P 3:41  
 PHOENIX, ARIZONA

Scale : 1" = 2000 feet

- The above map depicts the Bannie Gulch Gold mining claim, which is located in Section (s) \_\_\_\_\_, Township 13 N, Range 1 W, Gila and Salt River Base and Meridian, Yavapai County, Arizona.
- The type of corner and location monuments used are as follows: Monument marker SE CORNER OF bottom 1/2 of Amended claim 80 acres down to 40 acres.
- The bearings and distances in degrees and feet between claim corners are as depicted on the map.

Form MCF100a  
 Revised July 2005

This form is available from the Arizona Department of Mines & Mineral Resources and may be reproduced.

ENTERED SEP 30 2014



LOCATION NOTICE FOR PLACER MINING CLAIM

NOTICE IS HEREBY GIVEN that the Bannie  
Gulch Gold placer mining claim has been located by  
Micah Schisel whose current mailing  
address is 575 Duck ct, Prescott  
AZ, 86301

BLM  
Date  
Stamp  
2008 JUN 21 A 1:22  
PHOENIX, ARIZONA  
NATIONAL STATE OFFICE

The general course of this claim is Prescott and it is situated in  
Yavapai  
County, Arizona.

This claim is 2,640 feet in length and 1,320 feet in width. This claim runs from the  
location monument on which this location notice is posted approximately 1,320 feet in a E  
direction to the NE end line and 2640 feet in a S direction to the SE end line.

This claim is marked by four monuments, one at each corner of the claim.

The location monument on which this notice is posted is situated within Section 22SW, township  
13 N, Range 1 W, Gila Salt River Base and Meridian, Arizona. This claim encompasses  
portions of the following legal subdivision(s) if located by legal subdivision or the following quarter section (s),  
section (s), Township (s) and Range (s) NW 1/4, SW 1/4 of Section 22SW  
Township 13N Range 1W, Gila Salt River Base and Meridian, Arizona.

The locality of this claim with reference to some natural object or permanent monument and additional  
information (if any) concerning its locality are as follows: Marked by 6'  
wood and pvc markers

DATED AND POSTED on the ground this 25 day of June, 2008.

LOCATOR (s) see Attached

Amendment Filed on  
9/2/14  
ENTERED SEP 30 2014  
AC 635 (Approved by A. Thruer)  
PB

Form MCF102  
Revised July 2005

This form is available from the Arizona Department of Mines & Mineral Resources and may be reproduced.

INC 393518

MINING CLAIM MAP

Lode ( ) Placer

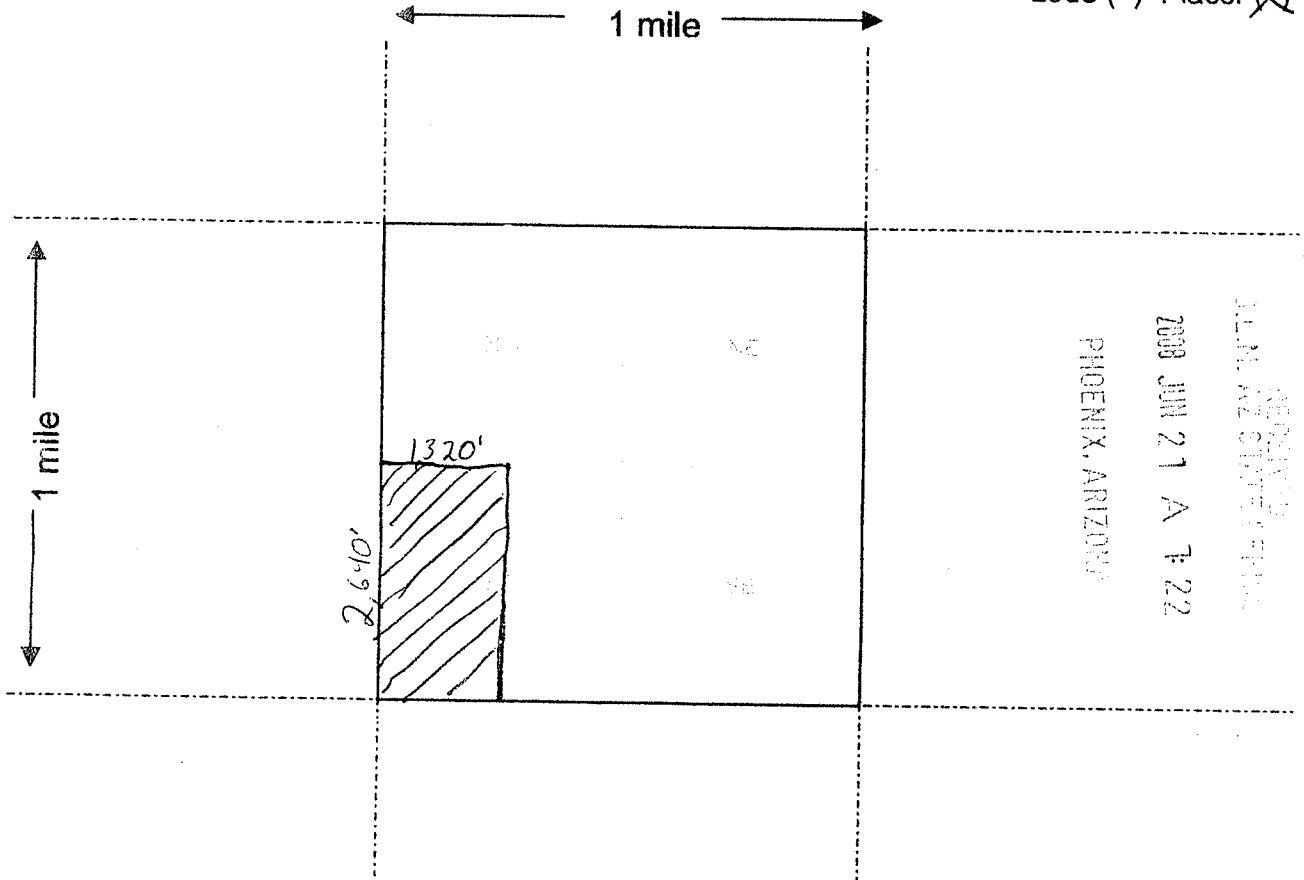

RECEIVED  
 J.L.M. AZ. DISTRICT OFFICE  
 2008 JUN 21 A 7:22  
 PHOENIX, ARIZONA

Scale : 1" = 2000 feet



1. The above map depicts the Dannie Gulch Gold mining claim, which is located in Section (s) 22 SW, Township 13 N, Range 1 W, Gila and Salt River Base and Meridian, Yavapai County, Arizona.
2. The type of corner and location monuments used are as follows: 6' wood and pvc stakes
3. The bearings and distances in degrees and feet between claim corners are as depicted on the map.

Form MCF100a  
Revised July 2005

This form is available from the Arizona Department of Mines & Mineral Resources and may be reproduced.

IMC 393518



# Locators:

1. Micah Schisel:

575 Duck Ct.

Prescott AZ, 86301

2. Daniel Schisel:

575 Duck Ct

Prescott AZ 86301

3. Connie Schisel

575 Duck Ct

Prescott AZ, 86301

4. Danell Schisel

6426 E. Kelmore

Prescott Valley

AZ, 86314

PHOENIX, ARIZONA

2008 JUN 21 A 7:27

441 27 86301

1MC 393518

DEPARTMENT OF INTERIOR  
BUREAU OF LAND MANAGEMENT

Input Parameters for Geographic Report with Land

System Id = CR

Admin State = AZ

Geo State = AZ

Casetype Begins With

Case Disp Txt = AUTHORIZED, CANCELLED, EXPIRED, PENDING, REJECTED, RELINQUISHED, WITHDRAWN

Mer Twp Rng =

Section =

Mtrs = 14 0130N 0010W 022

Commodity =

Commodity Txt =

Pending Org =

Pend Org Decode =

Total Rows Returned: 0

